

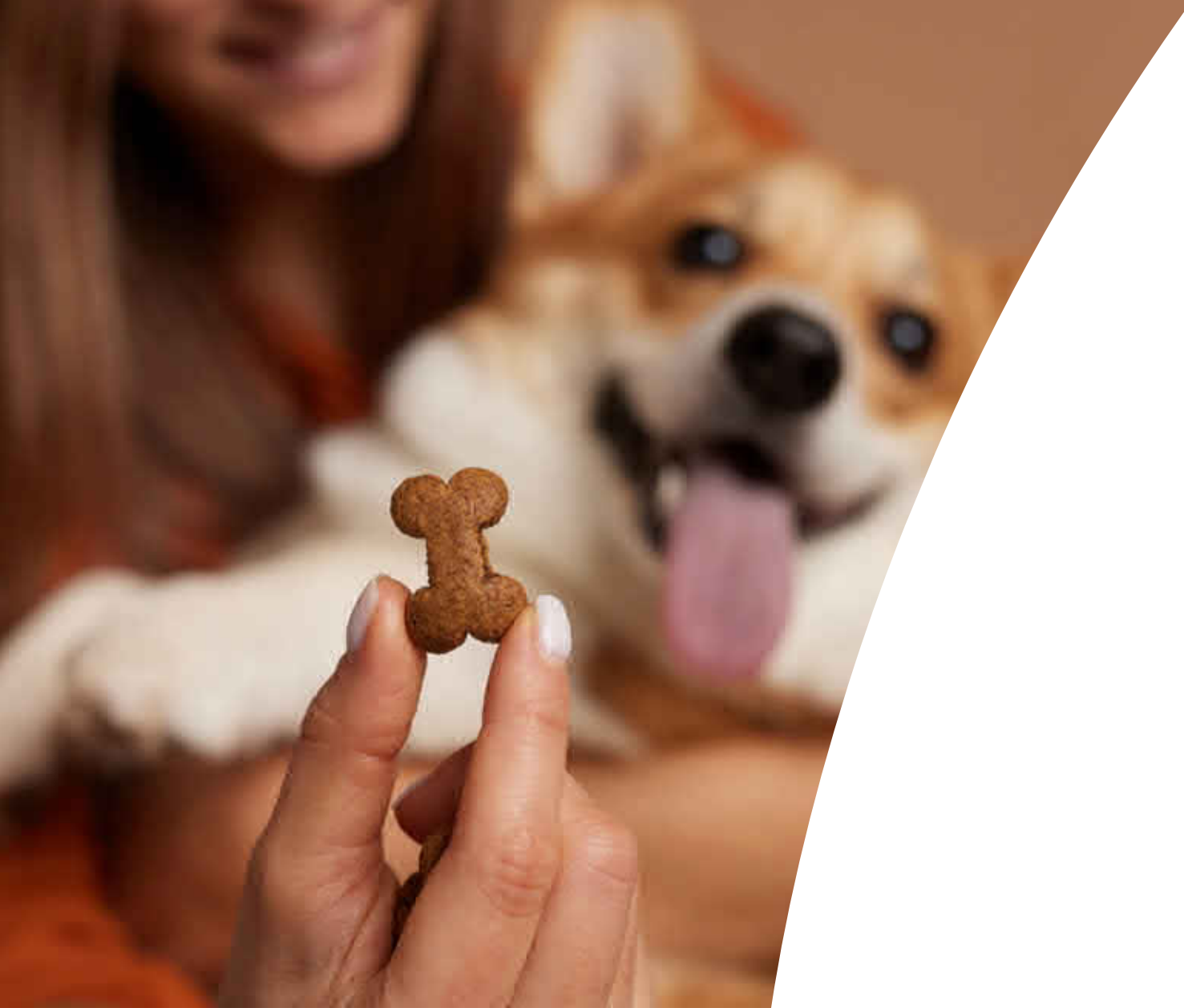

Volpak Solutions for Dry Pet Food





Why Volpak?

Volpak designs and manufactures a wide range of HFFS machines for packing dry pet food in different sizes and formats.

Expertise & know-how in the pet food industry



Pouches' appeal is a determining factor, as well as the quality of the finishing. Our technology allows you to produce attractive pouches that are both leak-free and cost-effective compared to pre-made pouches.

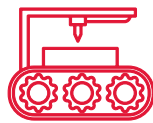

Machines equipped with the latest features: seal integrity kit; press-to-close; hook-to-hook closing systems; and single or multiple fill stations.



Sustainable ready: all Volpak solutions are ready to work with 100% recyclable and sustainable materials.



Wide range portfolio meeting customer demands for quality, quick pouch size change, and production capacity, up to 360 pouches/min.

Dry Pet Food

01. Caring for pets has become an important aspect of consumer behaviour, as evidenced by the growth of the premium sector in pet products.

02. The doypack with zipper for pet treats, snacks, or pet care complements, and flat sachets for wet pet food, have emerged as the preferred packaging options for pet food.

03. Flexible packaging offers numerous advantages, such as convenience, lightweight, long shelf life, and the potential for being 100% recyclable.

04. E-commerce has introduced diverse packaging formats to meet the requirements of the global market, prioritizing tailor-made designs for online purchasing channels.





Solutions

01. VOLPAK SI SERIES

Horizontal Form-Fill-Seal machine for medium to high speed projects, featuring servo-driven technology and accommodating a wide range of options and applicators.

02. VOLPAK SP SERIES

Horizontal Form-Fill-Seal machines for medium-speed projects, mainly mechanical-driven, and accommodating various options and applicators.

03. VOLPAK SL SERIES

Horizontal Form-Fill-Seal machines for medium to low-speed projects, mechanical-driven, offering straightforward setup and easy maintenance.

04. VOLPAK SC+ SERIES

Horizontal Form-Fill-Seal machines platform featuring continuous filling technology, ideal for high speed and high-production volumes projects.

VOLPAK SI SERIES:

Horizontal Form-Fill-Seal machine for medium to high speed projects, featuring servo-driven technology and accommodating a wide range of options and applicators.





SI 440

Horizontal Form-Fill-Seal (HFFS) machine for stand-up pouches, operating from a single reel of flexible packaging material, forming the pouch, filling it with product, and sealing.

Machine Highlights

- Duplex, Triplex or Quadruplex operation
- Smart HMI, easy and intuitive
- Mirror execution for footprint optimization
- Three dosing stations for multi-product filling
- Easy size change with guided operations and servo assisted regulations
- Low operating and maintenance costs
- Wide variety of pouch styles available (regular, shaped, top cap, corner cap, front cap, zipper, 3- or 4-side sealed sachets,...)
- Ready to work with 100% recyclable materials

Operating Cycle

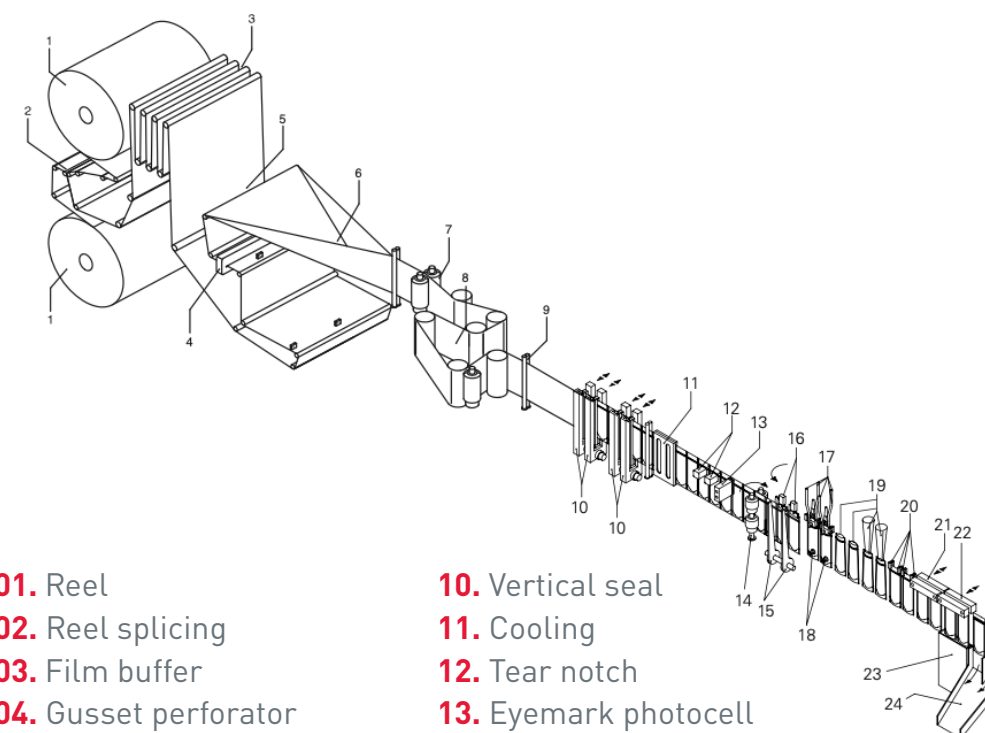

- 01.** Reel

02. Reel splicing

03. Film buffer

04. Gusset perforator

05. Reel aligner

06. Forming triangle

07. Servo roller for film pulling

08. Buffer to intermittent motion

09. Film guide
- 10.** Vertical seal

11. Cooling

12. Tear notch

13. Eyemark photocell

14. Servo rollers for film transport

15. Cutting knife

16. Pouch positioning & transfer

17. Pouch opening

18. Bottom pouch opening
- 19.** Filling stations

20. Pouch top stretching

21. Top sealing

22. Top cooling station

23. Pouch reject station

24. Discharge ramp

Technical Specifications

		Duplex	Triplex	Quadruplex
Min pouch size, W x H	mm	120 x 110 x 30	85 x 110 x 30	85 x 110 x 30
Max pouch size, W x H	mm	220 x 310 x 125	145 x 310 x 85	110 x 310 x 60
Max pouch volume	c.c	2000	600	300
Max output	ppm	120	180	240
Type of material		Heatsealable		
Max reel width	mm	745		
Max reel diameter	mm	600		
Core reel diameter	mm	74 - 78 / 150 - 154		
Electrical data		200 - 480 V / 50, 60 Hz / 3Ph+G		
Machine dimensions, L x A x H	mm	12300 x 2180 x 2260		
Net weight	kg	10000		





SI 360

Horizontal Form-Fill-Seal (HFFS) machine for stand-up pouches, operating from a single reel of flexible packaging material, forming the pouch, filling it with product, and sealing.

Machine Highlights

- Duplex, Triplex or Quadruplex operation
- Smart HMI, easy and intuitive
- Mirror execution for footprint optimization
- Three dosing stations for multi-product filling
- Easy size change with guided operations and quick regulations
- Low operating and maintenance costs
- Wide variety of pouch styles available (regular, shaped, top cap, corner cap, front cap, zipper, 3- or 4-side sealed sachets,...)
- Ready to work with 100% recyclable materials



Operating Cycle

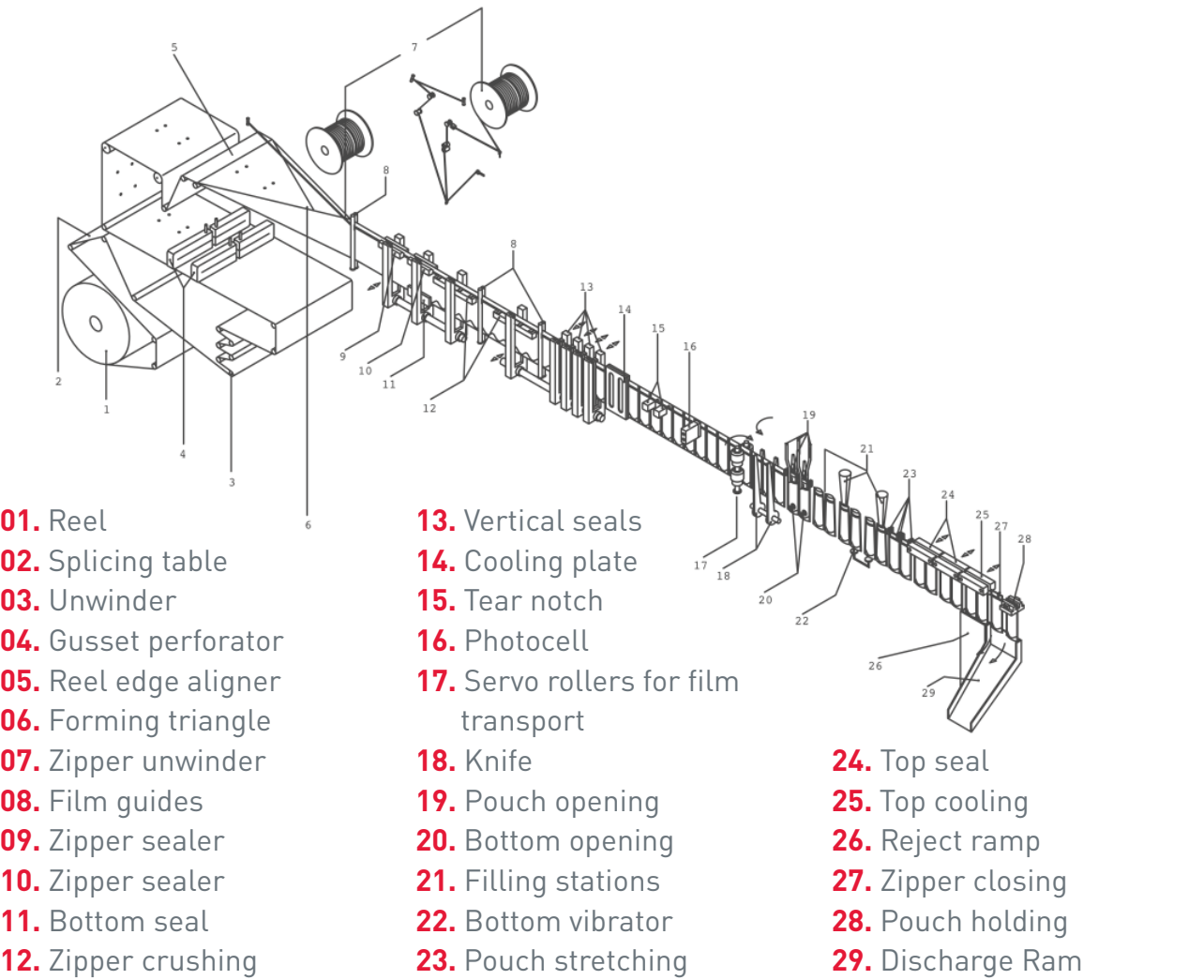

Technical Specifications

		Duplex	Triplex	Quadruplex
Min pouch size, W x H	mm	120 x 110 x 30	85 x 110 x 30	85 x 110 x 30
Max pouch size, W x H	mm	180 x 310 x 90	120 x 310 x 60	90 x 310 x 60
Max pouch volume	c.c	1500	500	200
Max output	ppm	120	180	240
Type of material		Heatsealable		
Max reel width	mm	710		
Max reel diameter	mm	600		
Core reel diameter	mm	74 - 78 / 150 - 154		
Electrical data		200 - 480 V / 50, 60 Hz / 3Ph+G		
Machine dimensions, L x A x H	mm	10000 x 2075 x 2420		
Net weight	kg	8600		



SI 280

Horizontal Form-Fill-Seal (HFFS) machine for stand-up pouches, operating from a single reel of flexible packaging material, forming the pouch, filling it with product, and sealing.

Machine Highlights

- Simplex, Duplex or Triplex operation
- Smart HMI, easy and intuitive
- Mirror execution for footprint optimization
- Three dosing stations for multi-product filling
- Easy size change with guided operations and quick regulations
- Low operating and maintenance costs
- Wide variety of pouch styles available (regular, shaped, top cap, corner cap, front cap, zipper, 3- or 4-side sealed sachets,...)
- Ready to work with 100% recyclable materials

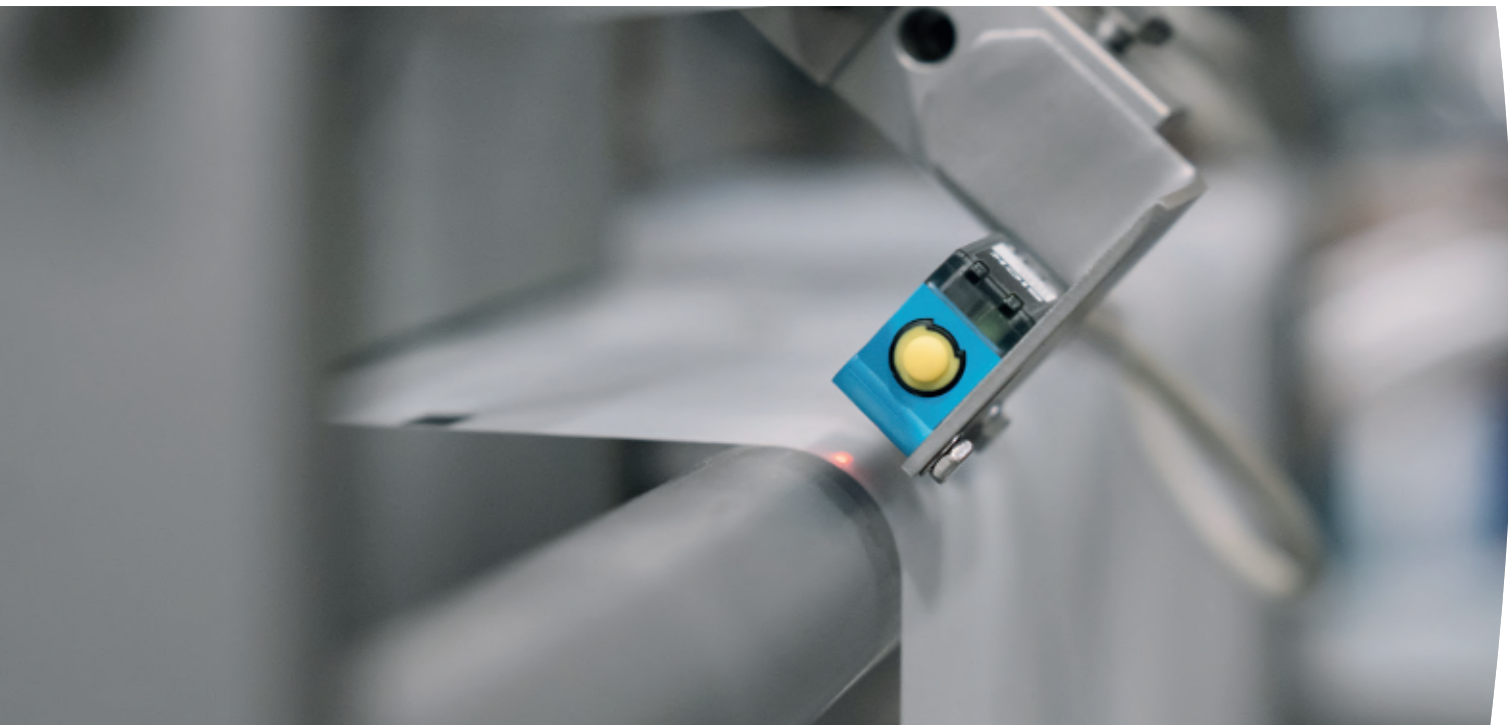

Operating Cycle

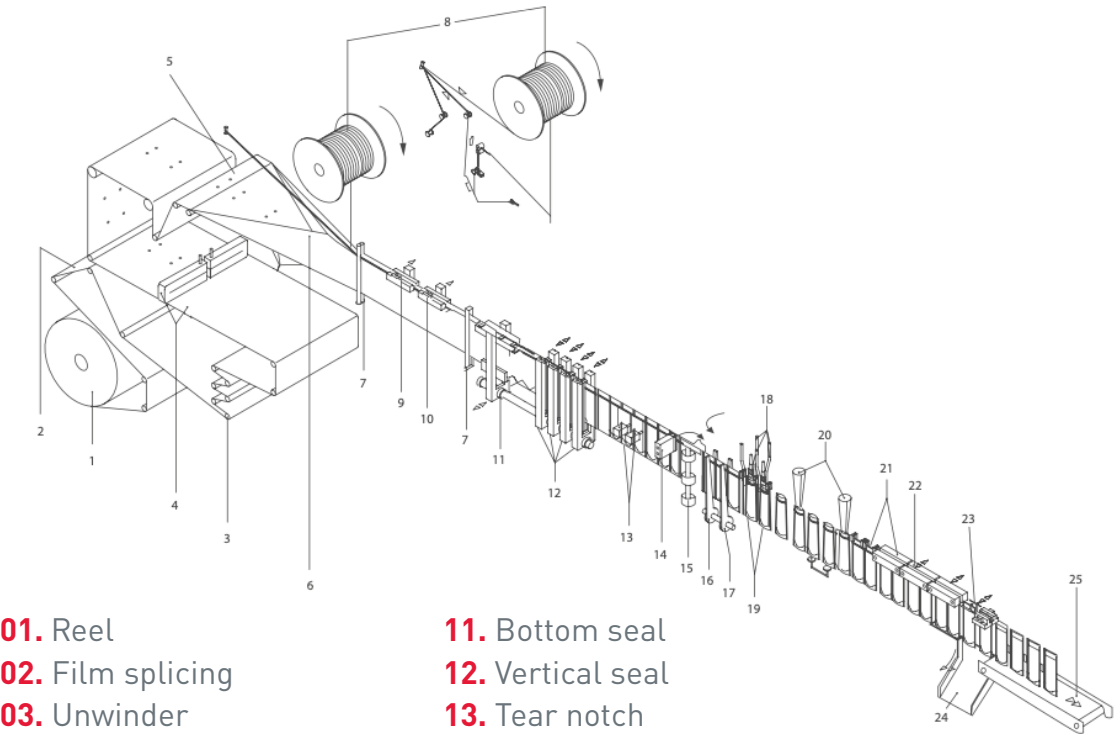

01. Reel

02. Film splicing

03. Unwinder

04. Gusset perforator

05. Band aligner

06. Forming triangle

07. Film guides

08. Zipper unwinder

09. Zipper seal

10. Zipper sealer
11. Bottom seal

12. Vertical seal

13. Tear notch

14. Photocell

15. Servo rollers for film transport

16. Knife

17. Knife and unitary cutting

18. Pouch opening

19. Bottom pouch opening
20. Fillings stations

21. Pouch stretching

22. Top sealing

23. Pouch reject station

24. Reject ramp

25. Discharge Belt

Technical Specifications

		Simplex	Duplex	Triplex
Min pouch size, W x H	mm	75 x 90 x 30	75 x 90 x 30	75 x 90 x 30
Max pouch size, W x H	mm	280 x 310 x 105	140 x 310 x 80	90 x 310 x 60
Max pouch volume	c.c	2500	600	1500
Max output	ppm	80	160	240
Type of material		Heatsealable		
Max reel width	mm	725		
Max reel diameter	mm	600		
Core reel diameter	mm	74 - 78 / 150 - 154		
Electrical data		200 - 480 V / 50, 60 Hz / 3Ph+G		
Machine dimensions, L x A x H	mm	8035 x 1865 x 2150		
Net weight	kg	6000		

VOLPAK SP SERIES:

Horizontal Form-Fill-Seal machines for medium-speed projects, mainly mechanical-driven, and accommodating various options and applicators.



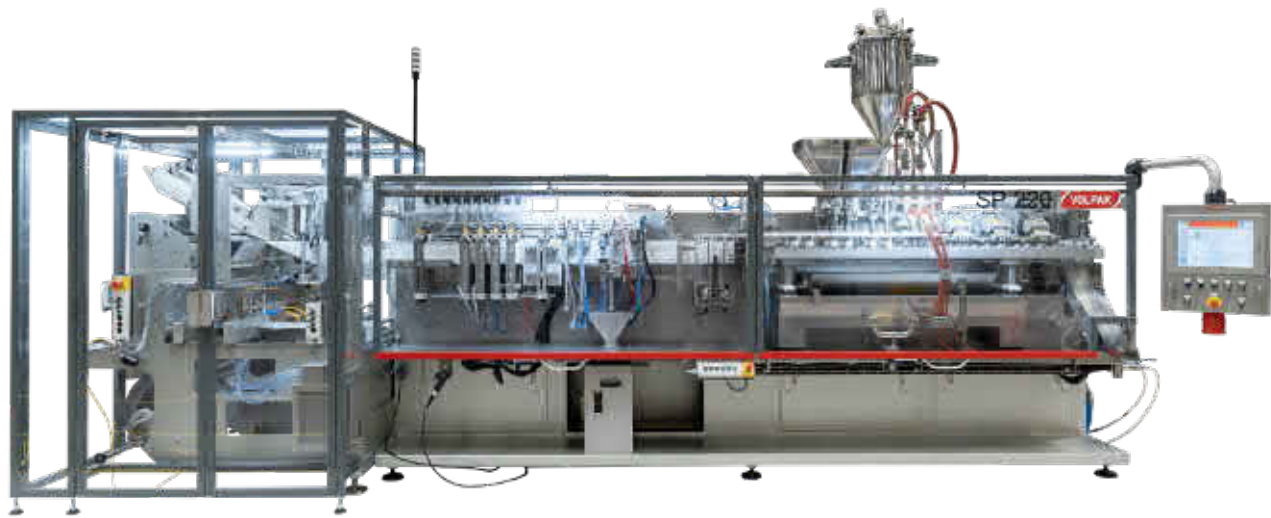

SP 220

Horizontal Form-Fill-Seal (HFFS) machine for sachets, operating from a single reel of flexible packaging material, forming the pouch, filling it with product, and sealing.

Machine Highlights

- Simplex or Duplex operation
- Smart HMI
- Easy handling and low maintenance costs
- Zipper and cap applicator for re-closable pouches
- Wide variety of sachet formats available both for stand-up or flat pouches
- Ready to work with 100% recyclable materials



Operating Cycle

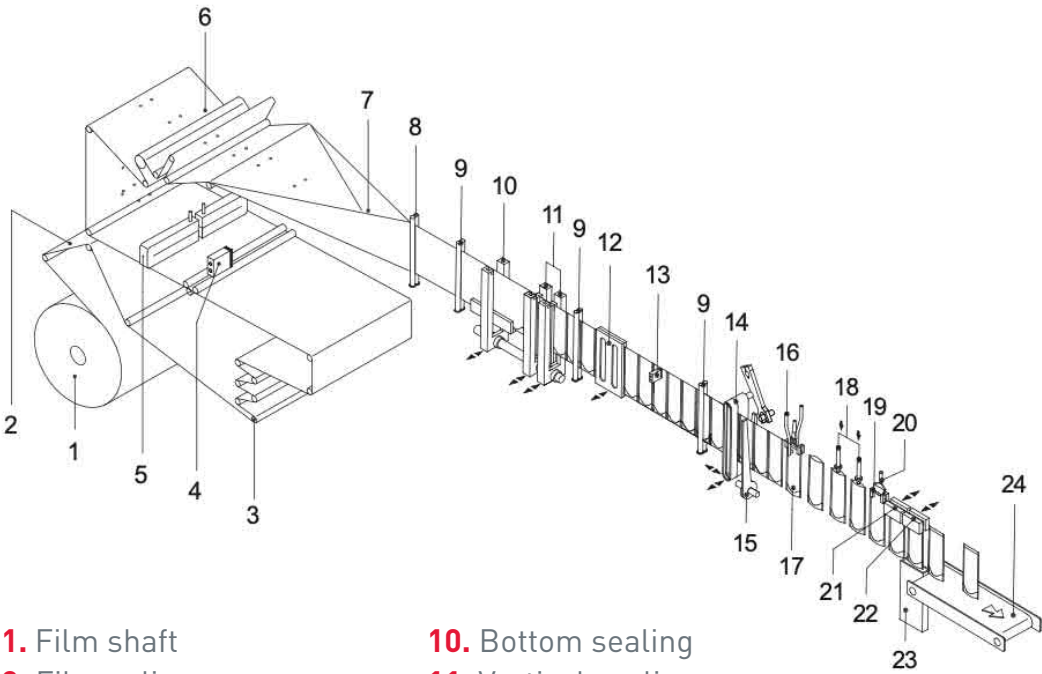

01. Film shaft

02. Film splicer

03. Unwinder arm

04. Photocell

05. Perforator

06. Reel aligner

07. Forming triangle

08. Film guide

09. Film guide
10. Bottom sealing

11. Vertical sealing

12. Cooling and flatterring

13. Photocell

14. Film transport

15. Scissors

16. Top pouch opening

17. Bottom pouch opening

18. Dosing station
19. Static stretching

20. Foam suction

21. Top sealing

22. Top cooling seals

23. Rejected pouches

24. Outlet belt

Technical Specifications

		Simplex	Duplex
Min pouch size, W x H	mm	70 x 60 / 70 x 100 x 30	50 x 60 / 50 x 90 x 30
Max pouch size, W x H	mm	220 x 270 (x 90)	110 x 270 (x 100)
Max pouch volume	c.c	1200	350
Max output	ppm	100	200
Type of material		Heatsealable	
Max reel width	mm	630	
Max reel diameter	mm	600	
Core reel diameter	mm	74 - 78 / 150 - 154	
Electrical data		220 - 380 - 440 V / 50, 60 Hz	
Machine dimensions, L x A x H	mm	5650 x 1650 x 1800	
Net weight	kg	5750	

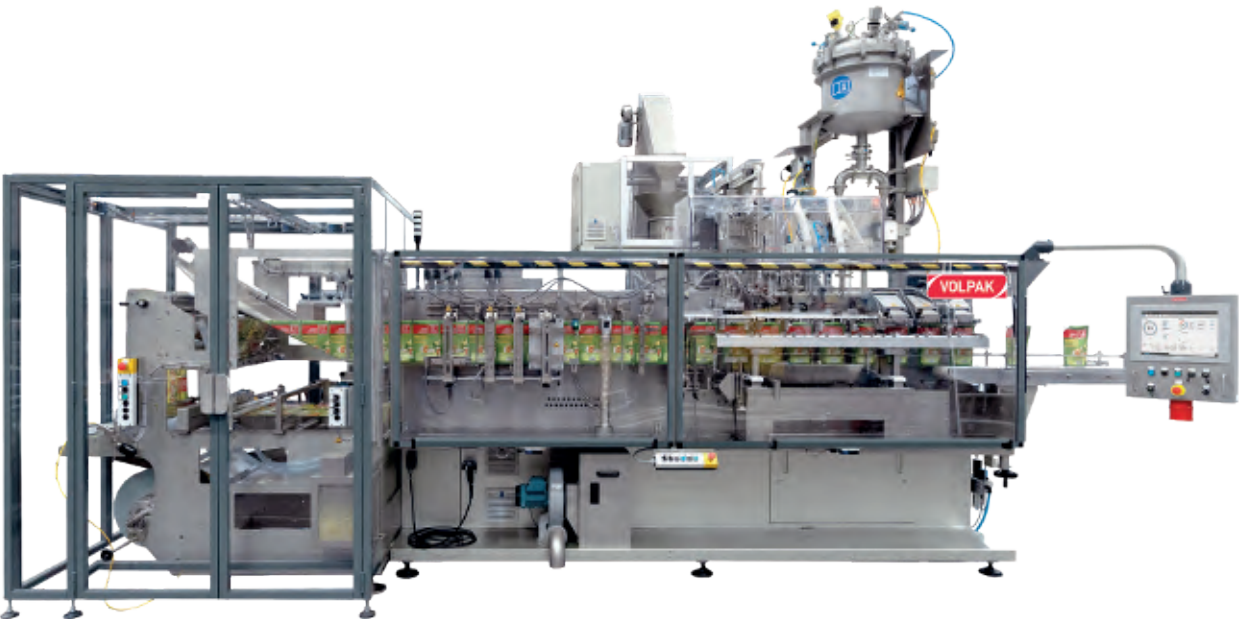

SP 170

Horizontal Form-Fill-Seal (HFFS) machine for sachets, operating from a single reel of flexible packaging material, forming the pouch, filling it with product, and sealing.

Machine Highlights

- Simplex or duplex operation
- Smart HMI, easy and intuitive
- Two dosing systems can be installed simultaneously
- Space to include additional equipment, such as cameras, printers, labelers...
- Numeric counters for easy size change
- Low operating and maintenance costs
- Wide variety of sachet formats available (3- or 4-side sealed sachets, twin sachets, shaped sachets...)
- Ready to work with 100% recyclable materials



Operating Cycle

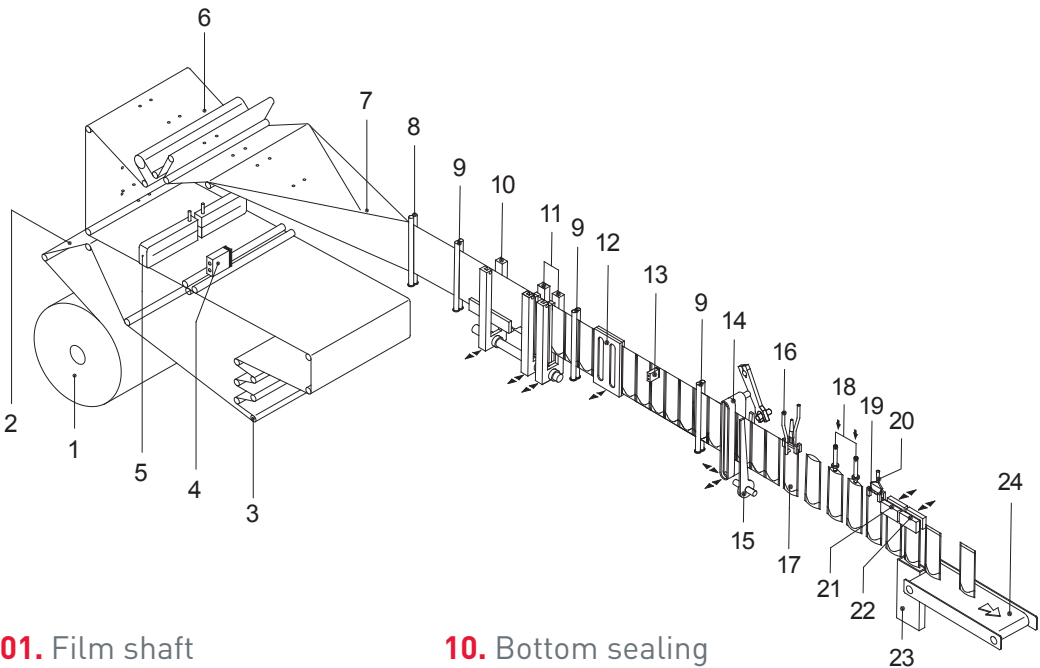

01. Film shaft

02. Film splicer

03. Unwinder arm

04. Photocell

05. Perforator

06. Reel aligner

07. Forming triangle

08. Film guide

09. Film guide
10. Bottom sealing

11. Vertical sealing

12. Cooling and flatterer

13. Photocell

14. Film transport

15. Scissors

16. Top pouch opening

17. Bottom pouch opening

18. Dosing station
19. Static stretching

20. Foam suction

21. Top sealing

22. Top cooling seals

23. Rejected pouches

24. Outlet belt

Technical Specifications

		Simplex	Duplex
Min pouch size, W x H	mm	70 x 70 / 70 x 90 x 30	50 x 70
Max pouch size, W x H	mm	170 x 270 (x100)	85 x 270
Max pouch volume	c.c	1000	150
Max output	ppm	100	200
Type of material		Heatsealable	
Max reel width	mm	640	
Max reel diameter	mm	600	
Core reel diameter	mm	74 - 78 / 150 - 154	
Electrical data		220,380,440V / 50, 60 Hz / 3Ph+G	

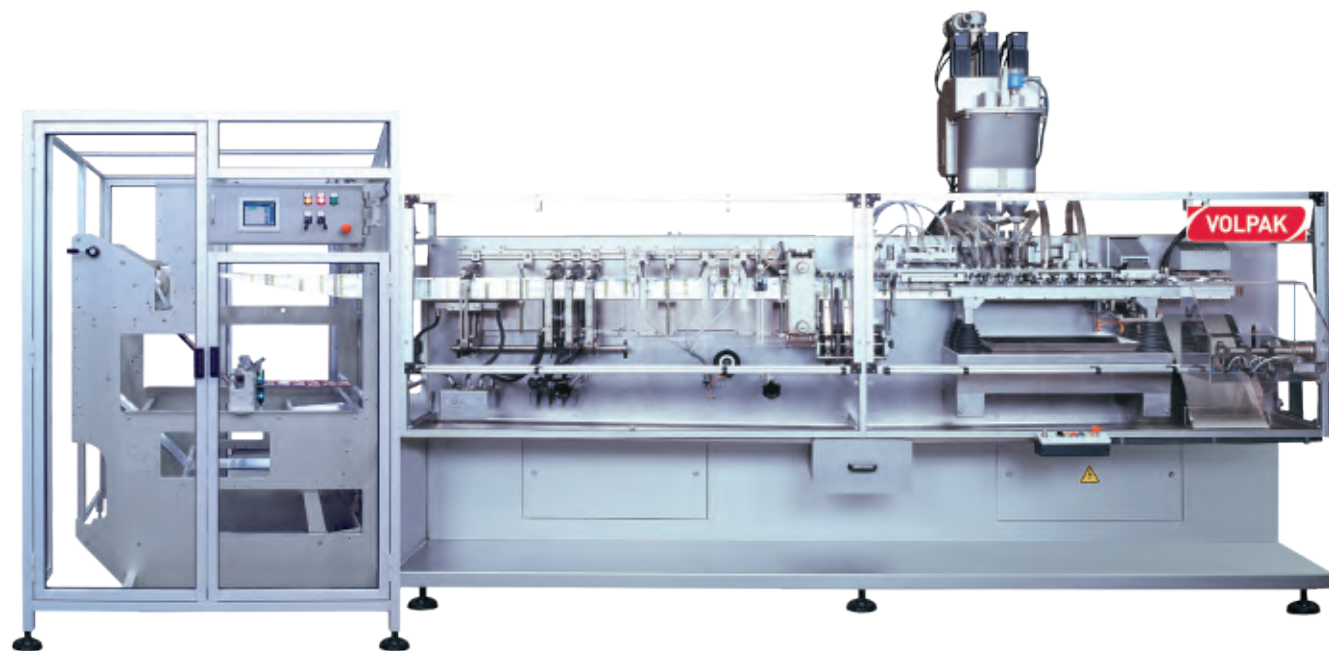

SP 70

Horizontal Form-Fill-Seal (HFFS) machine for sachets, operating from a single reel of flexible packaging material, forming the pouch, filling it with product, and sealing.

Machine Highlights

- Triplex or Quadruplex operation
- Smart HMI
- Optimized footprint
- Triplex or quadruplex dosing systems for high production rates
- Zipper applicator for re-closable pouches
- Wide variety of sachet formats available (3- or 4-side sealed sachets, twin sachets,...)
- Ready to work with 100% recyclable materials



Operating Cycle

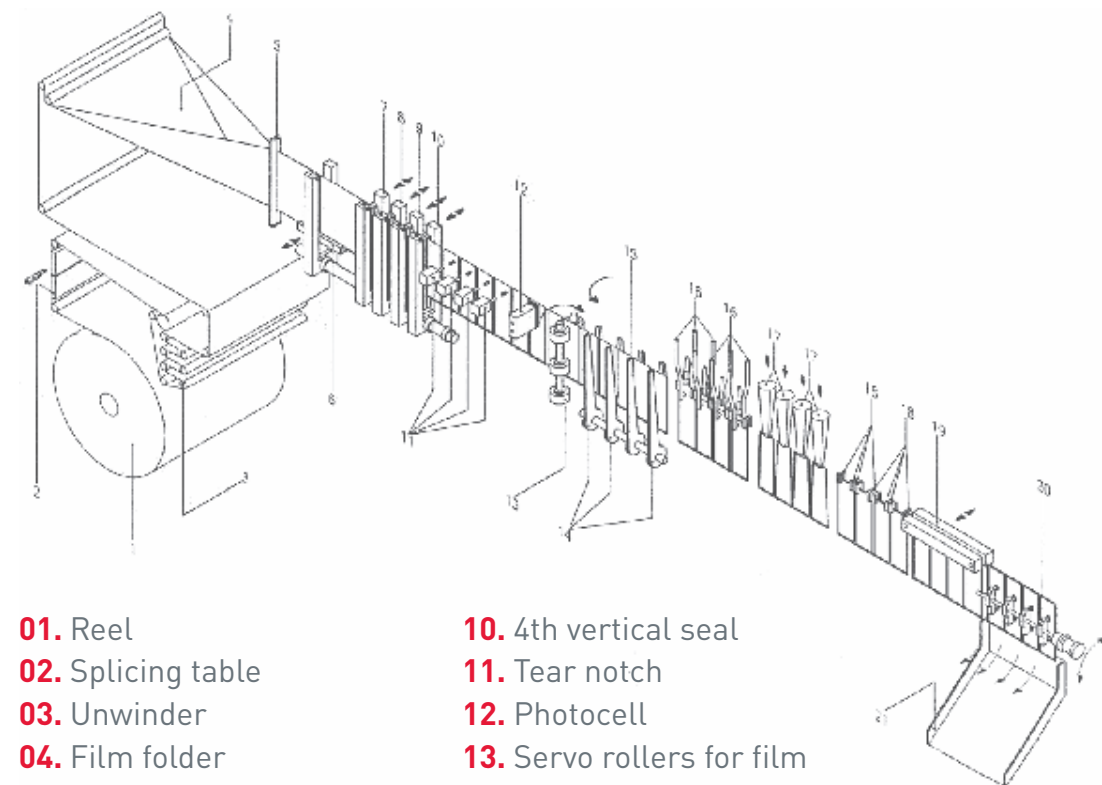

- | | | |
|------------------------------|---|----------------------------------|
| 01. Reel | 10. 4th vertical seal | 18. Pouch stretching |
| 02. Splicing table | 11. Tear notch | 19. Top sealing |
| 03. Unwinder | 12. Photocell | 20. Pick & Place transfer |
| 04. Film folder | 13. Servo rollers for film transport | 21. Reject ramp |
| 05. Film guides | 14. Knife | |
| 06. Bottom seal | 15. Knife | |
| 07. 1st vertical seal | 16. Pouch opening | |
| 08. 2nd vertical seal | 17. Filling station | |
| 09. 3rd vertical seal | | |

Technical Specifications

		Triplex	Quadruplex
Min pouch size, W x H	mm	45 x 50	45 x 50
Max pouch size, W x H	mm	93 x 240	70 x 240
Max pouch volume	c.c	150	80
Max output	ppm	270	360
Type of material		Heatsealable	
Max reel width	mm	480	
Max reel diameter	mm	600	
Core reel diameter	mm	74 - 78	
Electrical data		200 - 480 V / 50, 60 Hz / 3Ph+G	
Machine dimensions, L x A x H	mm	5000 x 1200 x 1800	
Net weight	kg	5500	

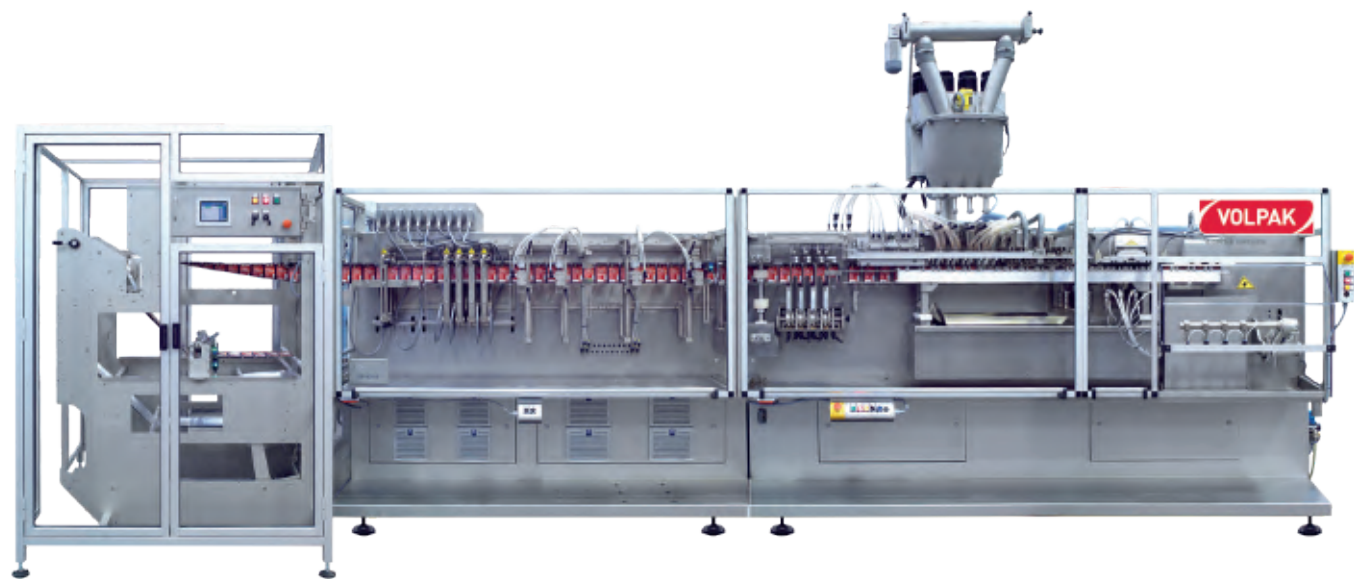

SP 90

Horizontal Form-Fill-Seal (HFFS) machine for sachets, operating from a single reel of flexible packaging material, forming the pouch, filling it with product, and sealing.

Machine Highlights

- Triplex or Quadruplex operation
- Smart HMI
- Optimized footprint
- Triplex or quadruplex dosing systems for high production rates
- Zipper applicator for re-closable pouches
- Wide variety of sachet formats available (3- or 4-side sealed sachets, twin sachets,...)
- Ready to work with 100% recyclable materials



Operating Cycle

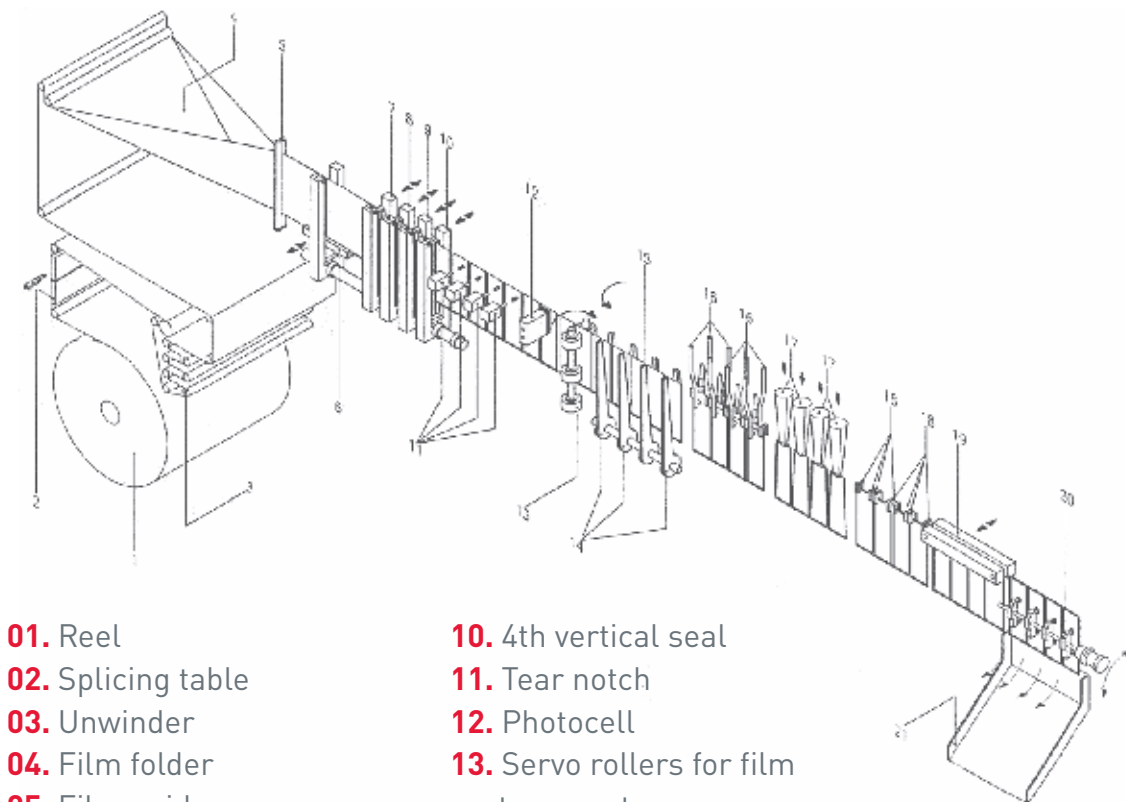

- | | | |
|------------------------------|---|----------------------------------|
| 01. Reel | 10. 4th vertical seal | |
| 02. Splicing table | 11. Tear notch | |
| 03. Unwinder | 12. Photocell | |
| 04. Film folder | 13. Servo rollers for film transport | |
| 05. Film guides | 14. Knife | 18. Pouch stretching |
| 06. Bottom seal | 15. Knife | 19. Top sealing |
| 07. 1st vertical seal | 16. Pouch opening | 20. Pick & Place transfer |
| 08. 2nd vertical seal | 17. Filling station | 21. Reject ramp |
| 09. 3rd vertical seal | | |

Technical Specifications

		Triplex	Quadruplex
Min pouch size, W x H	mm	45 x 50	45 x 50
Max pouch size, W x H	mm	120 x 240	90 x 240
Max pouch volume	c.c	180	100
Max output	ppm	240	320
Type of material		Heatsealable	
Max reel width	mm	480	
Max reel diameter	mm	600	
Core reel diameter	mm	74 - 78	
Electrical data		200 - 480 V / 50, 60 Hz / 3Ph+G	
Machine dimensions, L x A x H	mm	6765 x 1650 x 1800	
Net weight	kg	6400	

VOLPAK SL SERIES:

Horizontal Form-Fill-Seal machines for medium to low-speed projects, mechanical-driven, offering straightforward setup and easy maintenance.





SL 170

Horizontal Form-Fill-Seal (HFFS) machine for sachets, operating from a single reel of flexible packaging material, forming the pouch, filling it with product, and sealing.

Machine Highlights

- Simplex or duplex operation
- Smart HMI, easy and intuitive
- Two dosing systems can be installed simultaneously
- Space to include additional equipment, such as cameras, printers, labelers...
- Numeric counters for easy size change
- Low operating and maintenance costs
- Wide variety of sachet formats available (3- or 4-side sealed sachets, twin sachets, shaped sachets...)
- Ready to work with 100% recyclable materials



Operating Cycle

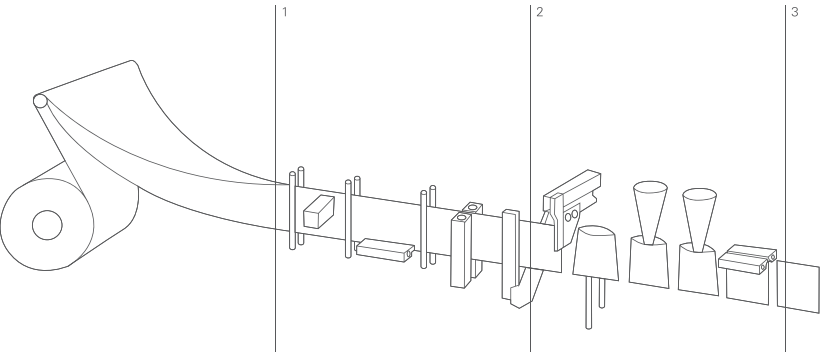

01. Unwinding and folding

02. Forming and cutting

03. Opening, filling and sealing

Technical Specifications

		Simplex	Duplex
Min pouch size, W x H	mm	50 x 70	50 x 70
Max pouch size, W x H	mm	190 x 225	90 x 225
Max pouch volume	c.c	500	90
Max output	ppm	90	180
Type of material		Heatsealable	
Max reel width	mm	450	
Max reel diameter	mm	500	
Core reel diameter	mm	70 - 75	
Consumption	kW	3,7	4,2
Electrical data		200 - 480 V / 50, 60 Hz / 3Ph+G	
Machine dimensions, L x A x H	mm	2140 x 930 x 1800	
Net weight	kg	680	780



SL 140

Horizontal Form-Fill-Seal (HFFS) machine for sachets, operating from a single reel of flexible packaging material, forming the pouch, filling it with product, and sealing.

Machine Highlights

- Simplex or duplex operation
- Smart HMI, easy and intuitive
- Two dosing systems can be installed simultaneously
- Numeric counters for easy size change
- Low operating and maintenance costs
- Wide variety of sachet formats available (3- or 4-side sealed sachets, twin sachets, shaped sachets...)
- Ready to work with 100% recyclable materials

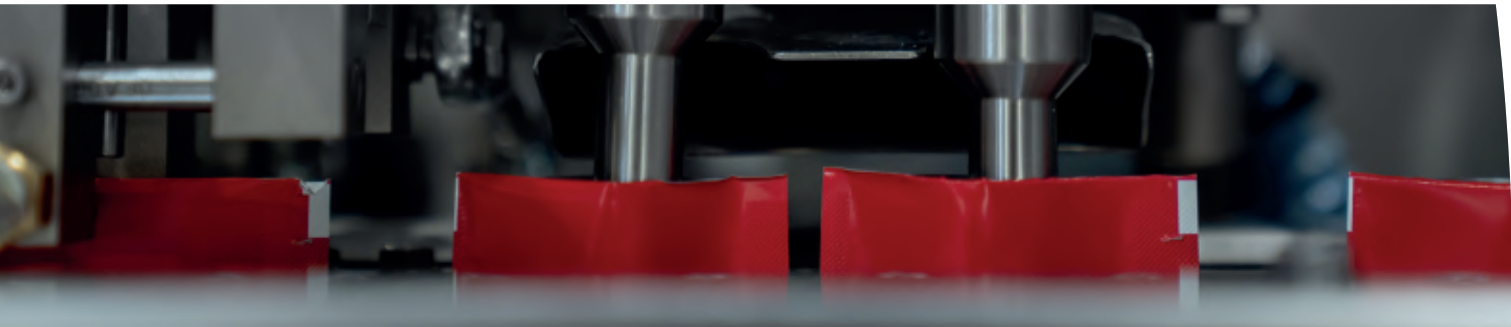

Operating Cycle

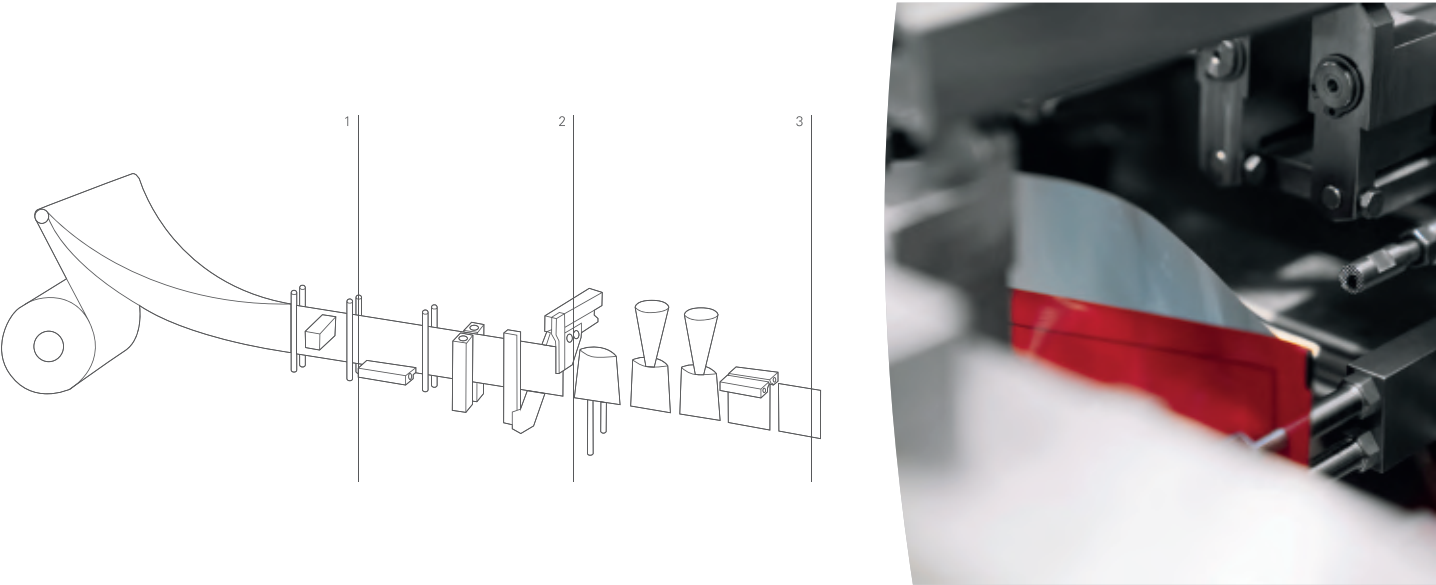

01. Unwinding and folding
02. Forming and cutting
03. Opening, filling and sealing

Technical Specifications

		Simplex	Duplex
Min pouch size, W x H	mm	50 x 70	50 x 70
Max pouch size, W x H	mm	140 x 200	70 x 200
Max pouch volume	c.c	300	50
Max output	ppm	90	180
Type of material		Heatsealable	
Max reel width	mm	400	
Max reel diameter	mm	500	
Core reel diameter	mm	70 - 75	
Consumption	kW	3,7	4,2
Electrical data		200 - 480 V / 50, 60 Hz / 3Ph+G	
Machine dimensions, L x A x H	mm	2840 x 975 x 1800	
Net weight	kg	680	780

VOLPAK SC+ SERIES:

Horizontal Form-Fill-Seal machines platform featuring continuous filling technology, ideal for high speed and high-production volumes projects.

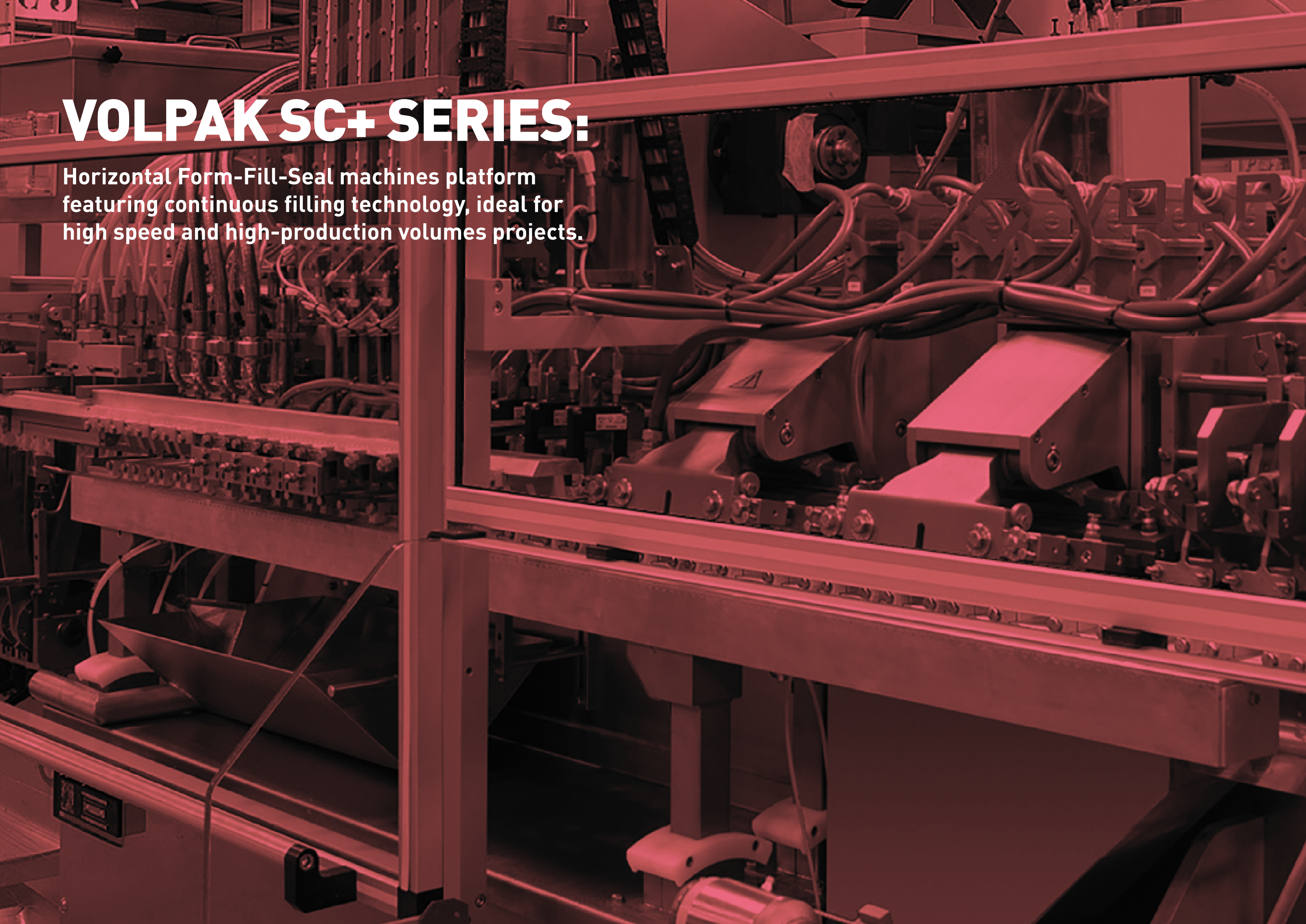



SC+ HFFS

Horizontal Form-Fill-Seal platform featuring continuous filling technology, ideal for high speed and high-production volumes projects.

New platform concept: SC+ machine range, a breakthrough innovation in Stand-up pouch machinery reaching beyond production and performance levels.

Machine Highlights

- Unique cutting: Contactless system for minimum wear and maintenance
- Complete pouch stations: Short and smooth movements for pouch opening, filling, and sealing. Simple and easy operation
- Continuous filling: Large process window for superior fill and seal conditions
- Filling turret compact and smart: High speed production while keeping gentle pouch manipulation
- Fast size change: Automatic and guided regulations for fast format change
- Ready to work with 100% recyclable materials

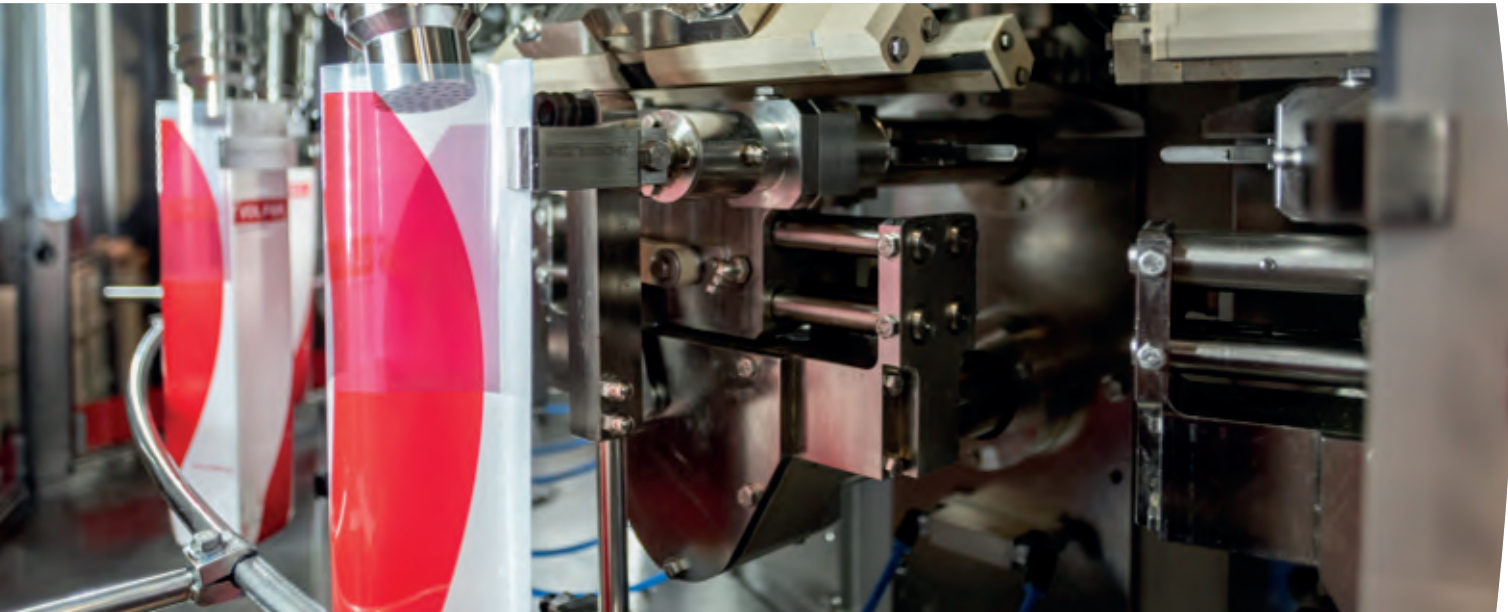

Technical Specifications

		SC+ 180	SC+ 240	SC+ 300
Min pouch size, W x H	mm	85 x 110 x 30		
Max pouch size, W x H	mm	180 x 310 x 120	240 x 310 x 120	300 x 310 x 120
Max pouch volume	c.c	1000	2000	3000
Max output	ppm	400	320	250
Type of material		Heatsealable		
Max reel width	mm	745		
Max reel diameter	mm	600		
Core reel diameter	mm	148 - 156		
Consumption	kW	70		
Machine dimensions, L x A x H	mm	17600 x 5500 x 5200		

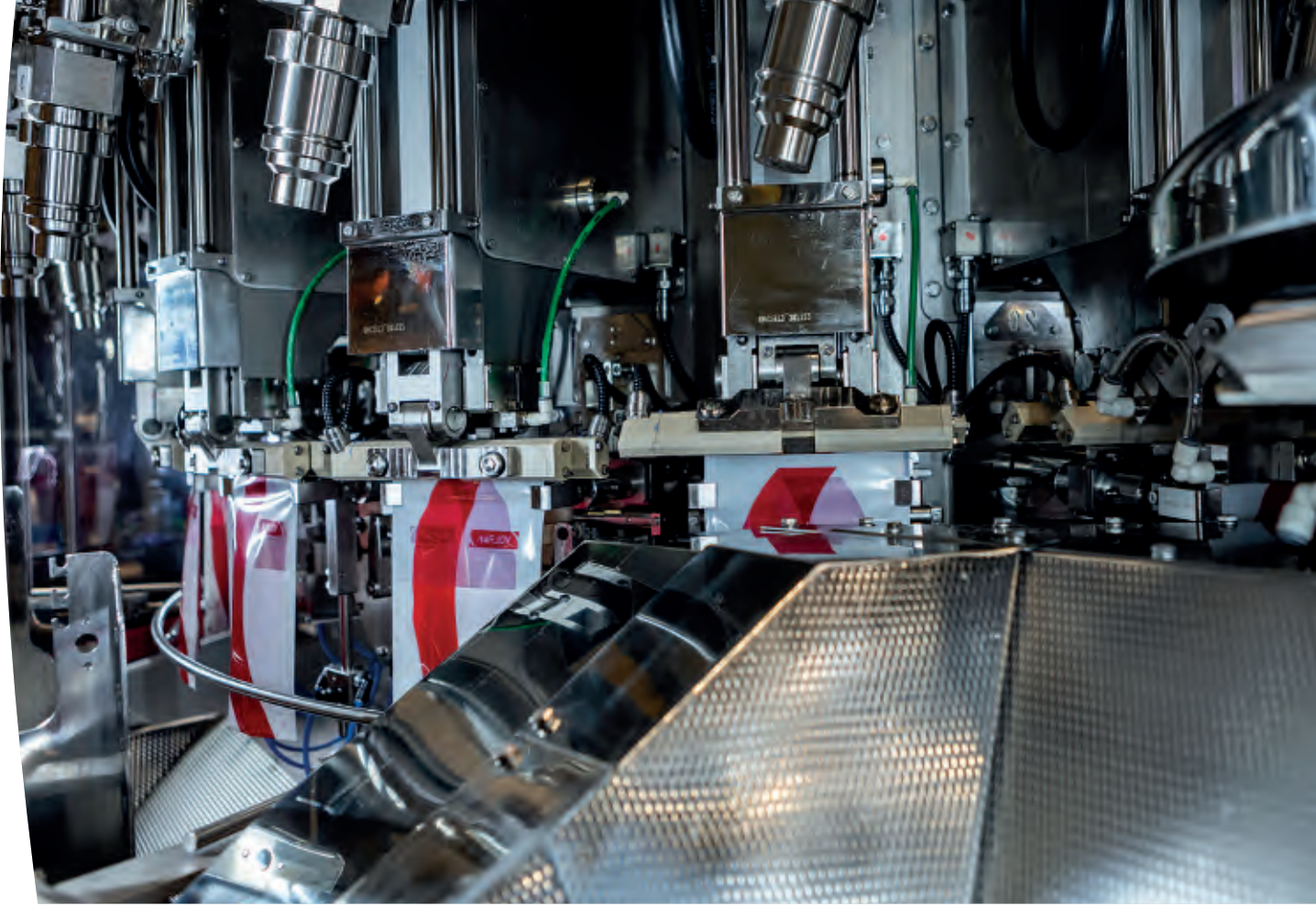

SC+ PREMADE

Premade Form-Seal platform featuring continuous filling technology, ideal for high speed and high-production volumes projects.

New platform concept: SC+ Premade, a breakthrough innovation in pre-made pouch machinery reaching production and performance levels never known before.

Machine Highlights

- Fast: Increasing production up to 300ppm
- Compact: Optimizing space thanks to small footprint
- Flexible: Using less material and producing less waste
- Connected: Featuring future-proof advanced technologies
- Sustainable: Suited for recyclable mono materials, compostable or paper-based pouches

Technical Specifications

		SC+ Premade 180	SC+ Premade 240	SC+ Premade 300
Min pouch size, W x H	mm	85 x 110 x 30	110 x 110 x 30	110 x 110 x 30
Max pouch size, W x H	mm	180 x 400 x 120	240 x 400 x 120	300 x 400 x 120
Max pouch volume	c.c	1000	2000	3000
Max output	ppm	250	250	200
Type of material		Heatsealable		
Max reel width	mm	N/A		
Max reel diameter	mm	N/A		
Core reel diameter	mm	N/A		
Consumption	kW	70		
Machine dimensions, L x A x H	mm	6900 x 5400 x 5200		

Coesia Group in the world



COESIA is a group of innovation-based industrial and packaging solutions companies operating globally, headquartered in Bologna, Italy.

Coesia's companies are leaders in the sectors of:

- **Advanced automated machinery**
- **Industrial process solutions**
- **High-performance transmissions**

Coesia's customers are leading players in a broad range of industries, including Consumer Goods, Tobacco, Healthcare, Aerospace, Racing & Automotive and Electronics.

Volpak S.A.U

Pol. Ind. Can Vinyalets
C/ Can Vinyalets 4
08130 Santa Perpètua de Mogoda
Barcelona, Spain
main@volpak.com



www.volpak.com