

VOLPAK SOLUTIONS FOR HOME CARE

Home Care

- 01

Consumer awareness to reduce plastic consumption has increased the use of resealable, refillable flexible packaging, which is gaining ground over traditional rigid plastic packaging.
- 02

E-commerce has diversified various formats to meet the global market's requirements, with more tailor-made packaging adapted to a new online purchasing model.
- 03

Chemical ingredients are reduced in product formulations favoring the use of more natural ingredients that are less harmful to both the environment and consumers.
- 04

Pods or tablets are increasingly being used in both laundry care and dishwashing detergents. This type of product allows the right amount of product to be used and is much easier and faster to dose.



Why Volpak?

Volpak designs and manufactures a wide range of HFFS machines for home care with different formats and a wide variety of closures.

Expertise & know-how for the home care industry.



Refill pouches require an efficient design of the pouring channel that guarantees the fluidity of the product regardless of changes in product viscosity. On large pouches a handle for transport or to help pouring is a convenient add on.



We use Mass flow meters to prevent that changes in the density of Home Care products significantly affect the preset dose.



Sustainable ready: all Volpak solutions are ready to work with 100% recyclable & sustainable materials.



We are experts in the dosing of foaming soap products. We choose the most suitable filling and foam extraction system depending on the product and the required production speed.

SOLUTIONS

01

VOLPAK SI SERIES

Horizontal Form-Fill-Seal machine for medium to high-speed projects, featuring servo-driven technology and accommodating a wide range of options and applicators.

02

VOLPAK SP SERIES

Horizontal Form-Fill-Seal machines for medium-speed projects, mainly mechanical-driven, and accommodating various options and applicators.

03

VOLPAK SL SERIES

Horizontal Form-Fill-Seal machines for medium to low-speed projects, mechanical-driven, offering straightforward setup and easy maintenance.

04

VOLPAK SC + SERIES

Horizontal Form-Fill-Seal machines platform featuring continuous filling technology, ideal for high-speed and high-production volumes projects.



VOLPAK SI SERIES:

**Horizontal Form-Fill-Seal machine
for medium to high-speed
projects, featuring servo-driven
technology and accommodating
a wide range of options and
applicators**

SI 440

Horizontal Form-Fill-Seal (HFFS) machine for stand-up pouches, operating from a single reel of flexible packaging material, forming the pouch, filling it with product, and sealing.

01 Machine Highlights

- Duplex, Triplex or Quadruplex operation
- Smart HMI, easy and intuitive
- Mirror execution for footprint optimization
- Three dosing stations for multi-product filling
- Easy size change with guided operations and servo assisted regulations
- Low operating and maintenance costs
- Wide variety of pouch styles available (regular, shaped, top cap, corner cap, front cap, zipper, 3- or 4-side sealed sachets,...)
- Ready to work with 100% recyclable materials

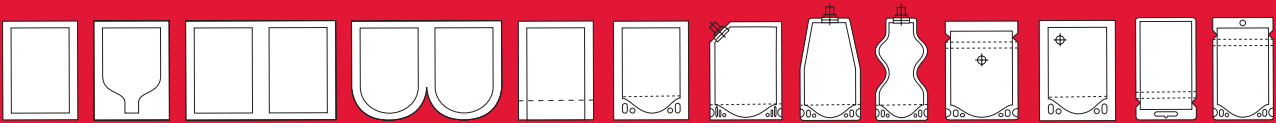

SI 440

02 Operating Cycle

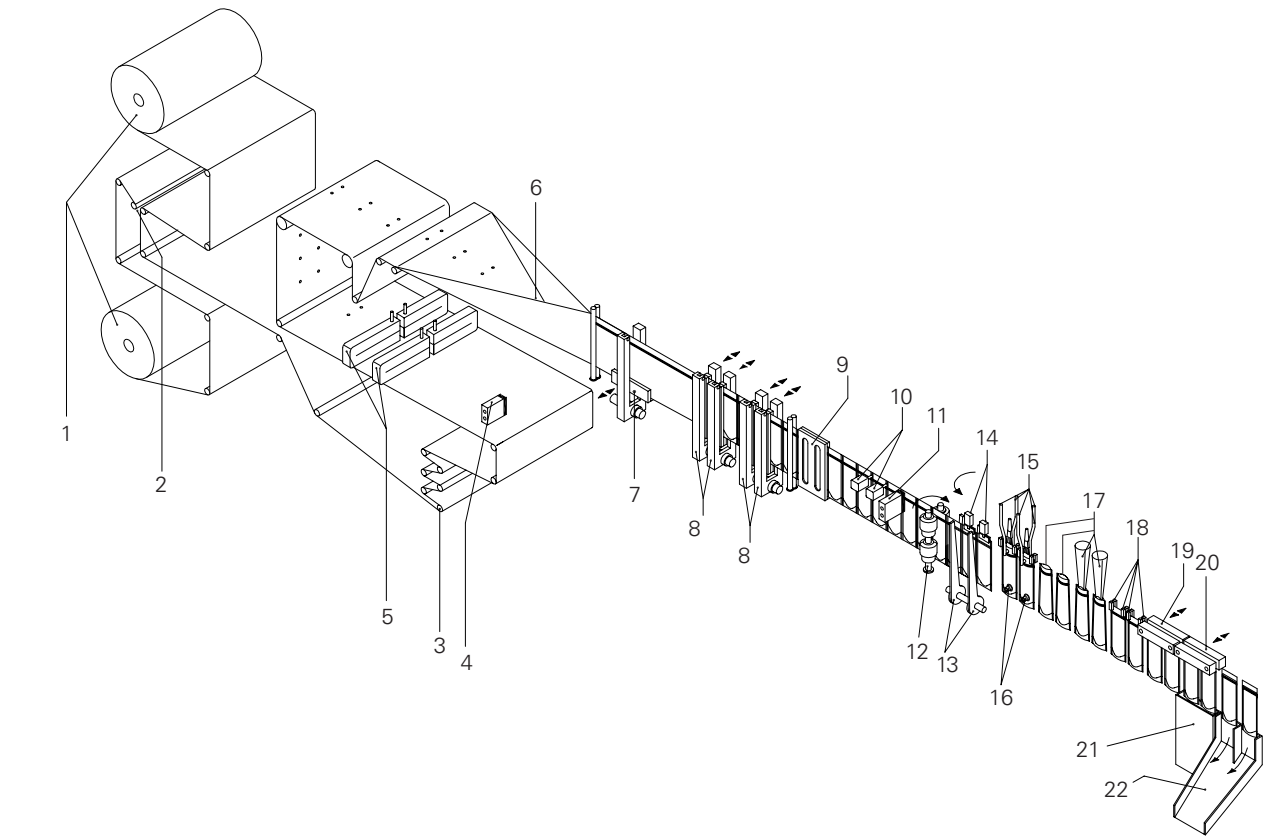

1. Film reel

2. Automatic film splicing

3. Buffer & unwinding

4. Photocell

5. Gusset perforator

6. Forming triangle

7. Bottom seal

8. Vertical seal
9. Cooling

10. Tear notch

11. Eyemark photocell

12. Servo rollers for film transport

13. Cutting knife

14. Pouch positioning & transfer

15. Pouch opening
16. Bottom pouch opening

17. Filling stations

18. Pouch top stretching

19. Top sealing

20. Top cooling station

21. Pouch reject station

22. Discharge ramp



03 Technical specification

		DUPLEX	TRIPLEX	QUADRUPLEX
Min pouch size, W x H	mm	120 x 110 x 30	85 x 110 x 30	85 x 110 x 30
Max pouch size, W x H	mm	220 x 310 x 125	145 x 310 x 85	110 x 310 x 60
Max pouch volume	c.c	2000	600	300
Max output	ppm	120	180	240
Type of material		Heatsealable		
Max reel width	mm	745		
Max reel diameter	mm	600		
Core reel diameter	mm	74- 78 / 150- 154		
Electrical data		200- 480 V / 50, 60 Hz / 3Ph+G		
Machine dimensions, L x A x H	mm	12300 x 2180 x 2260		
Net weight	kg	10000		

SI 360

Horizontal Form-Fill-Seal (HFFS) machine for stand-up pouches, operating from a single reel of flexible packaging material, forming the pouch, filling it with product, and sealing.

01 Machine Highlights

- Duplex, Triplex or Quadruplex operation
- Smart HMI, easy and intuitive
- Mirror execution for footprint optimization
- Three dosing stations for multi-product filling
- Easy size change with guided operations and quick regulations
- Low operating and maintenance costs
- Wide variety of pouch styles available (regular, shaped, top cap, corner cap, front cap, zipper, 3- or 4-side sealed sachets,...)
- Ready to work with 100% recyclable materials

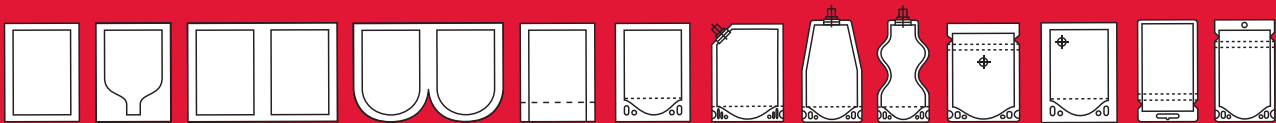
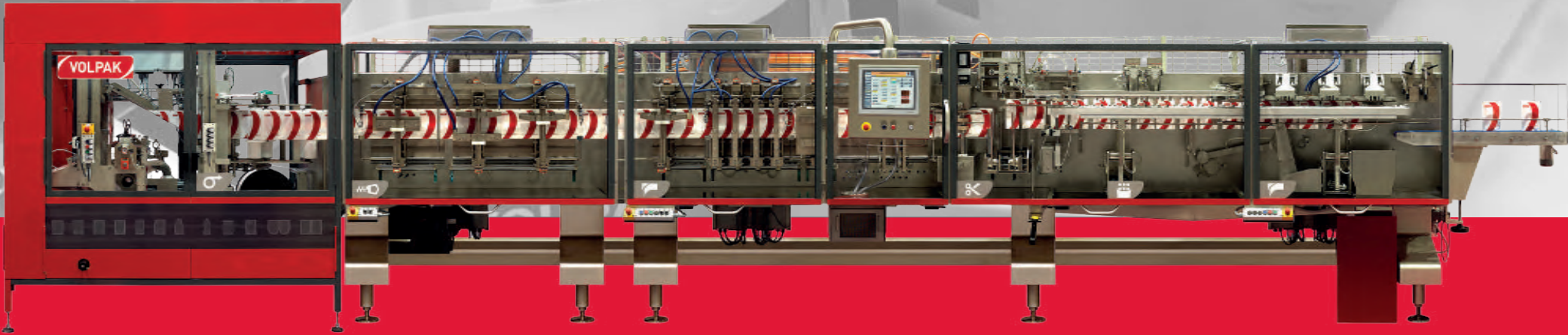

SI 360

02 Operating Cycle

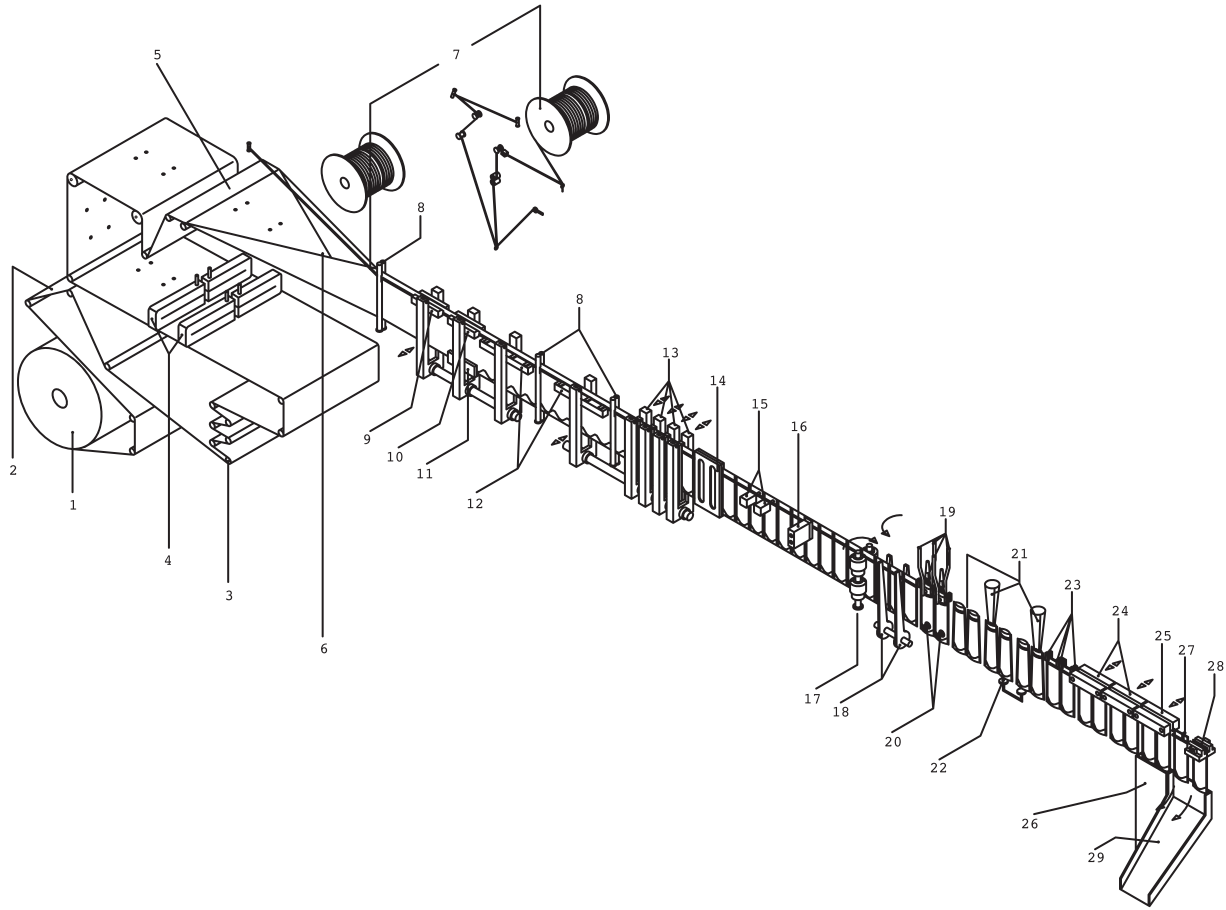

1. Reel

2. Splicing table

3. Unwinder

4. Gusset perforator

5. Reel edge aligner

6. Forming triangle

7. Zipper unwinder

8. Film guides

9. Zipper sealer

10. Zipper sealer
11. Bottom seal

12. Zipper crushing

13. Vertical seals

14. Cooling plate

15. Tear notch

16. Photocell

17. Servo rollers for film transport

18. Knife

19. Pouch opening

20. Bottom opening

21. Filling stations

22. Bottom vibrator

23. Pouch stretching

24. Top seal

25. Top cooling

26. Reject ramp

27. Zipper closing

28. Pouch holding

29. Discharge Ram

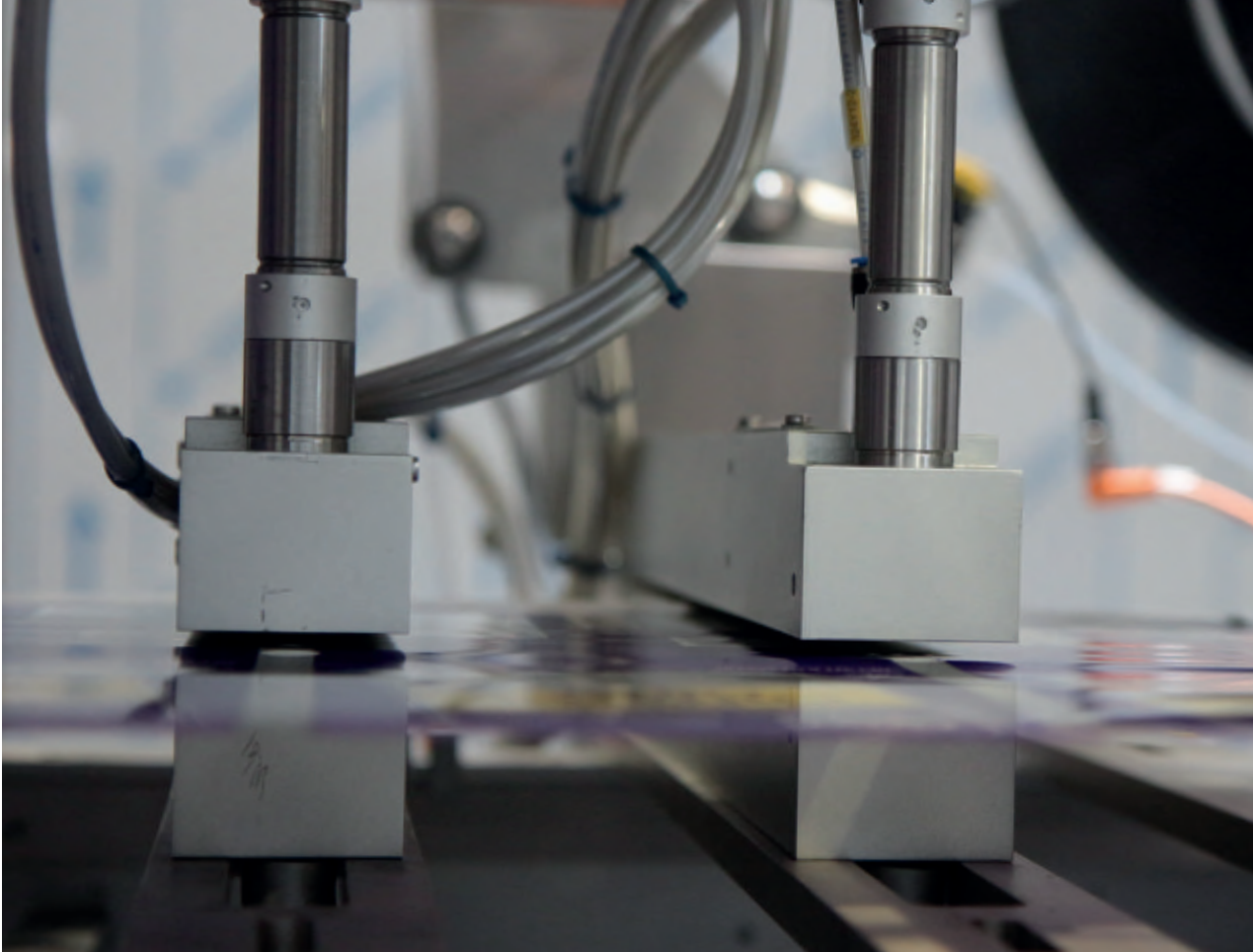

03 Technical specification

		DUPLEX	TRIPLEX	QUADRUPLEX
Min pouch size, W x H	mm	120 x 110 x 30	85 x 110 x 30	85 x 110 x 30
Max pouch size, W x H	mm	180 x 310 x 90	120 x 310 x 60	90 x 310 x 60
Max pouch volume	c.c	1500	500	200
Max output	ppm	120	180	240
Type of material		Heatsealable		
Max reel width	mm	710		
Max reel diameter	mm	600		
Core reel diameter	mm	74- 78 / 150- 154		
Electrical data		200- 480 V / 50, 60 Hz / 3Ph+G		
Machine dimensions, L x A x H	mm	10000 x 2075 x 2420		
Net weight	kg	8600		

SI 280

Horizontal Form-Fill-Seal (HFFS) machine for stand-up pouches, operating from a single reel of flexible packaging material, forming the pouch, filling it with product, and sealing.

01 Machine Highlights

- Simplex, Duplex or Triplex operation
- Smart HMI, easy and intuitive
- Mirror execution for footprint optimization
- Three dosing stations for multi-product filling
- Easy size change with guided operations and quick regulations
- Low operating and maintenance costs
- Wide variety of pouch styles available (regular, shaped, top cap, corner cap, front cap, zipper, 3- or 4-side sealed sachets,...)
- Ready to work with 100% recyclable materials

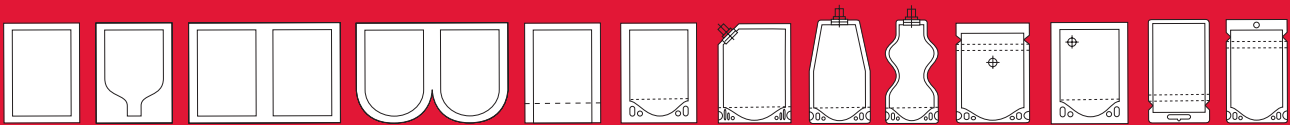
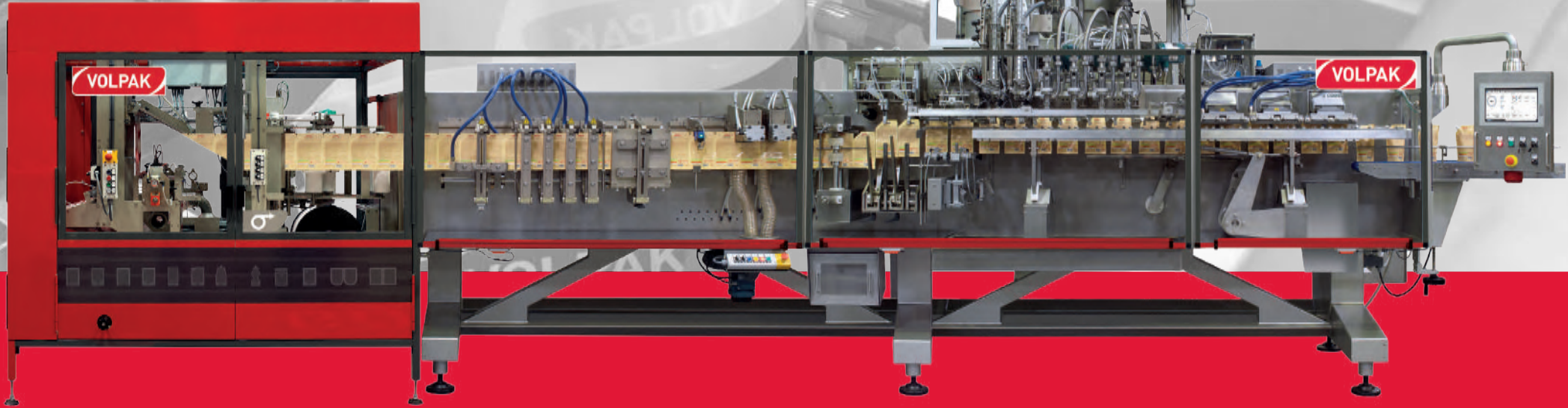

SI 280

02 Operating Cycle

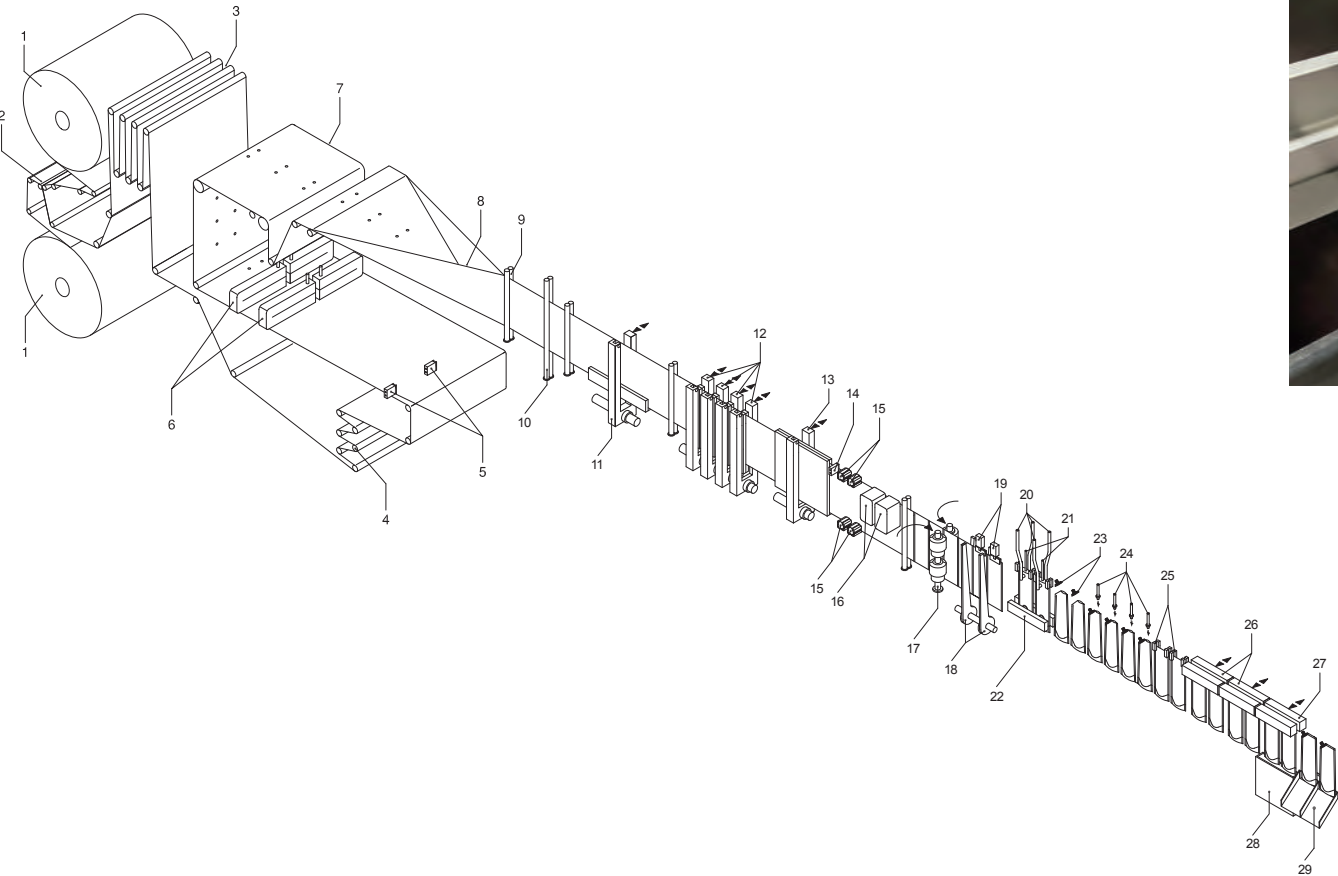

1. Reel of film

2. Splicing table

3. Film unwinder

4. Unwinder arm

5. Photocells

6. Bottom perforator

7. Band aligner

8. Bottom forming triangle

9. Film guide

10. Film guide
11. Bottom sealing

12. Verticals sealing

13. Cooling Sealing

14. Photocell

15. Round edges

16. Cup cutting die

17. Feed rollers

18. Scissors

19. Positioner gripper

20. Top pouch opening
20. Top pouch opening

21. Pouch opening blower

22. Bottom pouch opening

23. Cap cutting die

24. Product nozzles

25. Static stretching

26. Top sealing

27. Top cooling seals

28. Rejected pouches

29. Outlet ramp



03 Technical specification

		SIMPLEX	DUPLEX	TRIPLEX
Min pouch size, W x H	mm	75 x 90 x 30	75 x 90 x 30	75 x 90 x 30
Max pouch size, W x H	mm	280 x 310 x 105	140 x 310 x 80	90 x 310 x 60
Max pouch volume	c.c	2500	600	150
Max output	ppm	80	160	240
Type of material		Heatsealable		
Max reel width	mm	725		
Max reel diameter	mm	600		
Core reel diameter	mm	74- 78 / 150- 154		
Electrical data		200- 480 V / 50, 60 Hz / 3Ph+G		
Machine dimensions, L x A x H	mm	8035 x 1865 x 2150		
Net weight	kg	6000		

VOLPAK SP SERIES:

**Horizontal Form-Fill-Seal
machines for medium-speed
projects, mainly mechanical-
driven, and accommodating
various options and applicators**

SP 220

Horizontal Form-Fill-Seal (HFFS) machine for sachets, operating from a single reel of flexible packaging material, forming the pouch, filling it with product, and sealing.

01 Machine Highlights

- Simplex or Duplex operation
- Smart HMI
- Easy handling and low maintenance costs
- Zipper and cap applicator for re-closable pouches.
- Wide variety of sachet formats available both for stand-up or flat pouches
- Ready to work with 100% recyclable materials

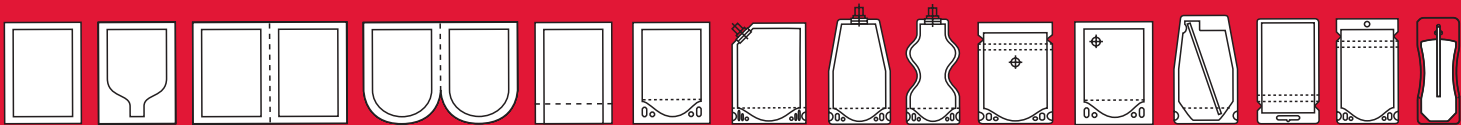
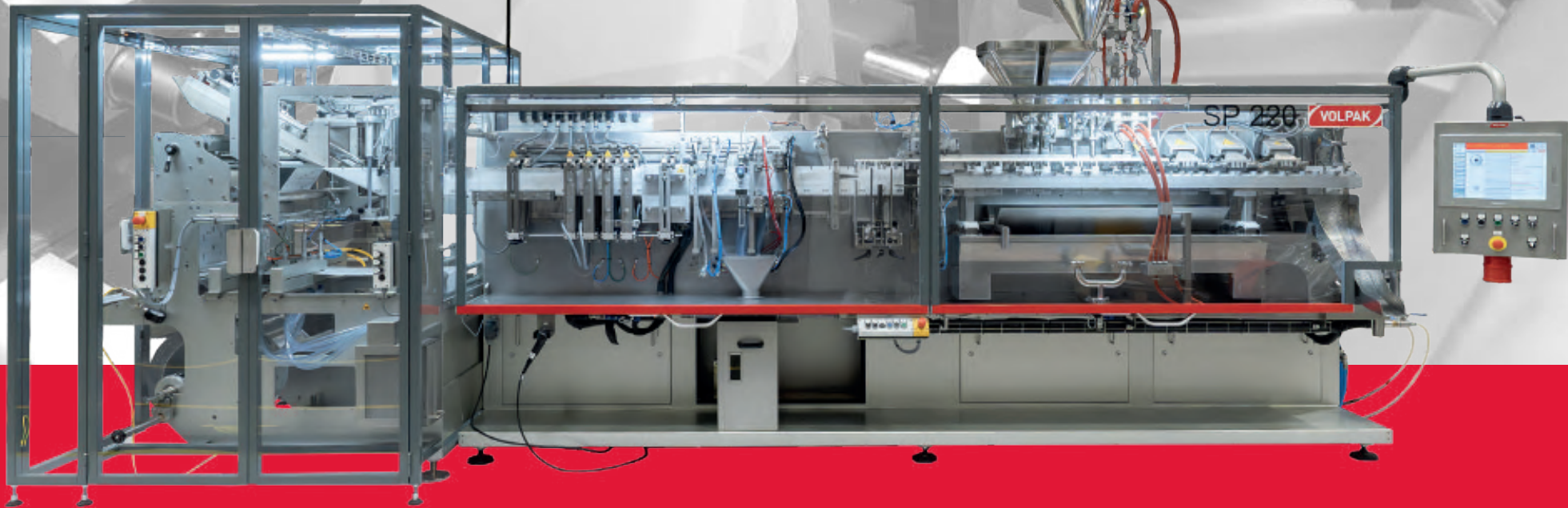

SP 220

02 Operating Cycle

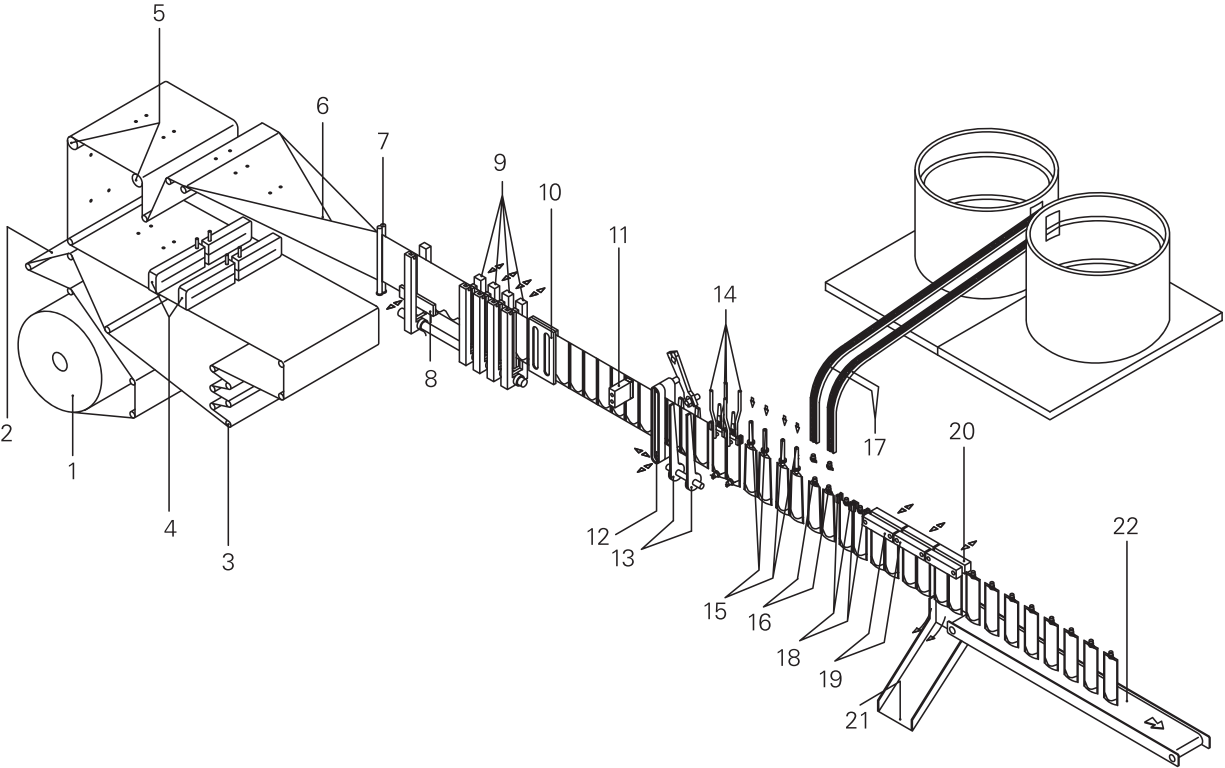

1. Reel

2. Film splicing

3. Unwinder

4. Perforators

5. Reel aligner

6. Forming triangle

7. Film guides

8. Bottom seal
9. Vertical seal

10. Cooling and flattening

11. Photocell

12. Film transport

13. Knife

14. Pouch opening

15. Filling stations
16. Cap insertion and sealing

17. Cap feeding

18. Pouch stretching

19. Cap and pouch top seal

20. Cooling

21. Reject ramp

22. Outfeed belt



03 Technical specification

		SIMPLEX	DUPLEX
Min pouch size, W x H	mm	70 x 60 / 70 x 100 x 30	50 x 60 / 50 x 90 x 30
Max pouch size, W x H	mm	220 x 270 (x 90)	110 x 270 (x 100)
Max pouch volume	c.c	1200	350
Max output	ppm	100	200
Type of material		Heatsealable	
Max reel width	mm	630	
Max reel diameter	mm	600	
Core reel diameter	mm	74- 78 / 150- 154	
Electrical data		220, 380, 440 V / 50, 60 Hz	
Machine dimensions, L x A x H	mm	5650 x 1650 x 1800	
Net weight	kg	5750	

SP 170

Horizontal Form-Fill-Seal (HFFS) machine for sachets, operating from a single reel of flexible packaging material, forming the pouch, filling it with product, and sealing.

01 Machine Highlights

- Simplex or duplex operation
- Smart HMI, easy and intuitive
- Two dosing systems can be installed simultaneously
- Space to include additional equipment, such as cameras, printers, labelers...
- Numeric counters for easy size change
- Low operating and maintenance costs
- Wide variety of sachet formats available (3- or 4-side sealed sachets, twin sachets, shaped sachets...)
- Ready to work with 100% recyclable materials

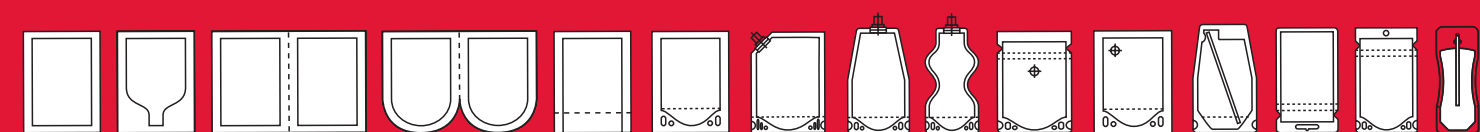

SP 170

02 Operating Cycle

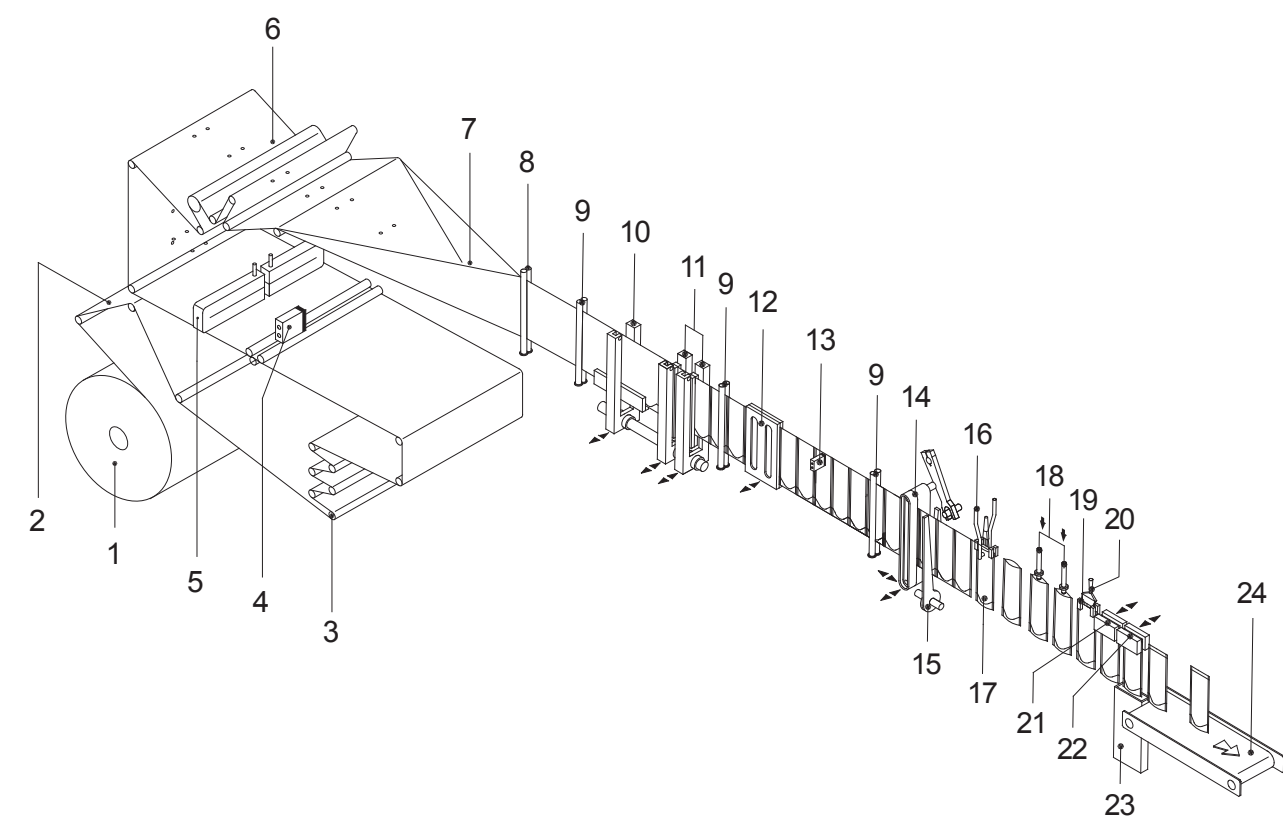

1. Film shaft

2. Film splicer

3. Unwinder arm

4. Photocell

5. Perforator

6. Brand aligner

7. Bottom triangle

8. Film guide

9. Film guides
10. Bottom sealing

11. Vertical sealing

12. Cooling sealing

13. Photocell

14. Puller (stroke arm)

15. Scissors

16. Suction cups opening pouch

17. Suction cups opening bottom

18. Dosing station
18. Dosing station

19. Static stretching

20. Foam suction

21. Top sealing

22. Top cooling seals

23. Rejected pouches

24. Outlet belt



03 Technical specification

		SIMPLEX	DUPLEX
Min pouch size, W x H	mm	70 x 70 / 70 x 90 x 30	50 x 70
Max pouch size, W x H	mm	170 x 270 (x100)	85 x 270
Max pouch volume	c.c	1000	150
Max output	ppm	100	200
Type of material		Heatsealable	
Max reel width	mm	640	
Max reel diameter	mm	600	
Core reel diameter	mm	74- 78 / 150- 154	
Electrical data		220,380,440V / 50, 60 Hz / 3Ph+G	

VOLPAK SL SERIES:

**Horizontal Form-Fill-Seal
machines for medium to low-
speed projects, mechanical-
driven, offering straightforward
setup and easy maintenance**

SL 220F

Horizontal Form-Fill-Seal (HFFS) machine for stand-up pouches, operating from a single reel of flexible packaging material, forming the pouch, filling it with product, and sealing.

01 Machine Highlights

- Smart HMI
- Easy operation and low maintenance cost
- Very versatile machine, ideal for a large variety of pouch formats
- Specially designed to work with zipper and corner cap applications
- Ready to work with 100% recyclable materials

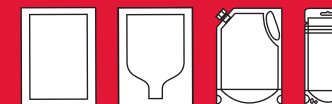
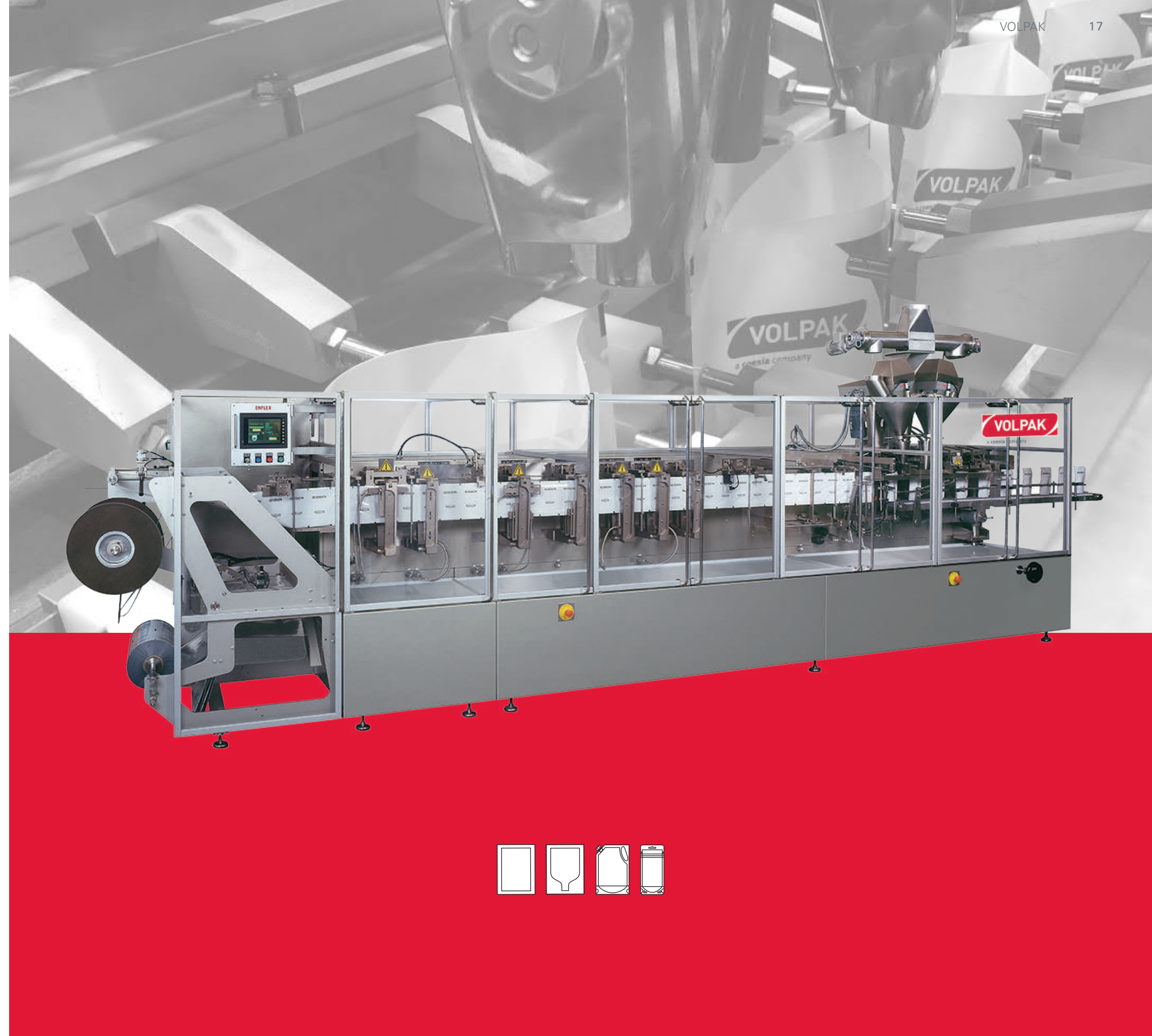

SL 220F

02 Operating Cycle

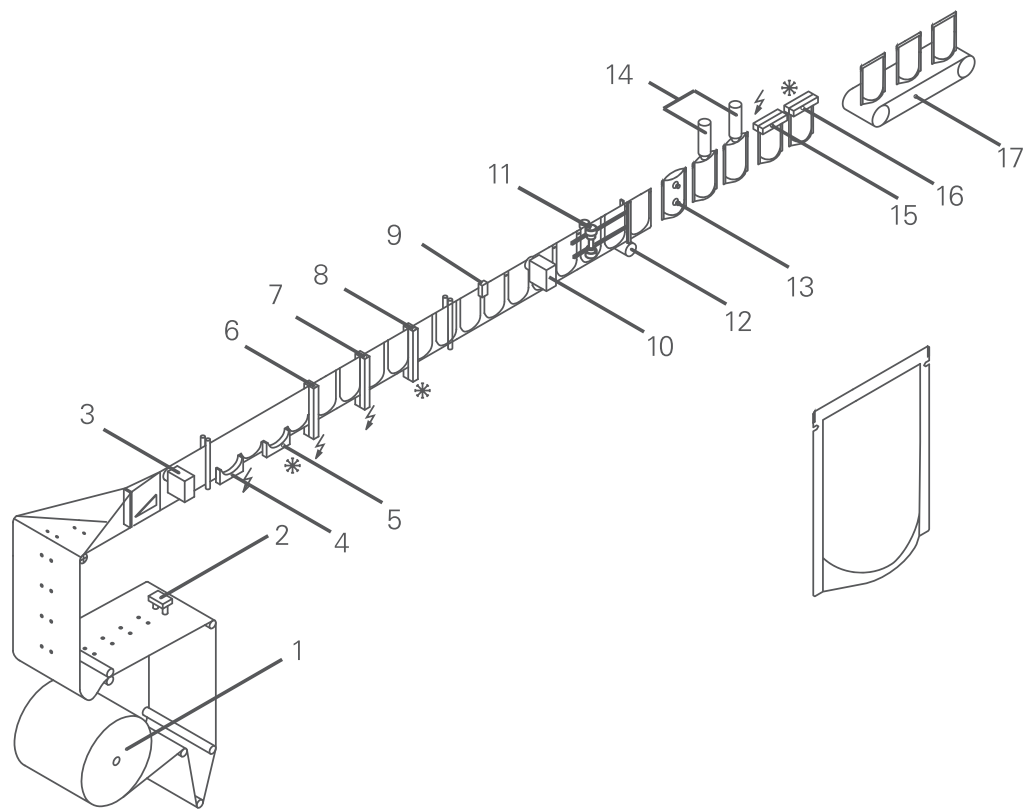

1. Reel

2. Reel perforator

3. Photocell (Optional)

4. Bottom sealer

5. Bottom seal cooler

6. Vertical sealer
7. Teflon vertical sealer

8. Vertical seal cooler

9. Coding & tear notch

10. Photocell

11. Film draw

12. Scissors
13. Suction cups

14. Liquid filling station

15. Top sealer

16. Top seal cooler

17. Discharge exit

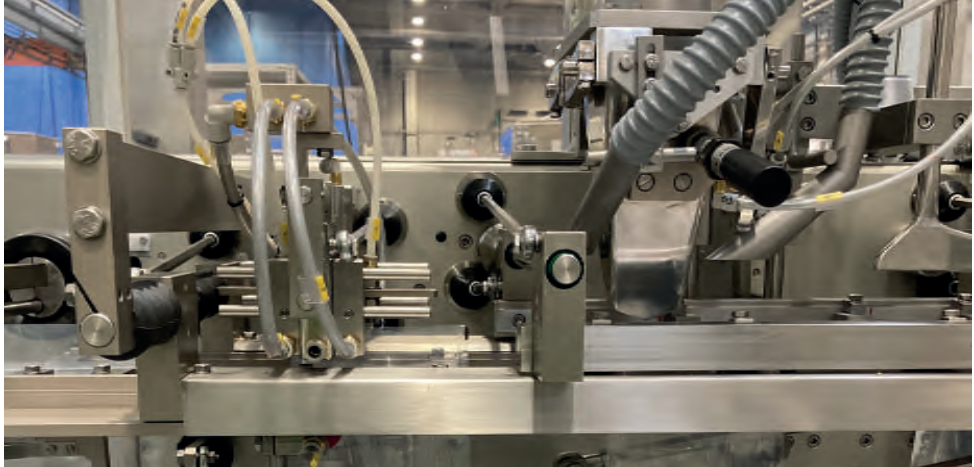

03 Technical specification

SIMPLEX		
Min pouch size, W x H	mm	100 x 150 x 55
Max pouch size, W x H	mm	220 x 300 x 110
Max pouch volume	c.c	2000
Max output	ppm	60
Type of material		Heatsealable
Max reel width	mm	710
Max reel diameter	mm	500
Core reel diameter	mm	70 - 75
Consumption	[kW]	4,1
Electrical data		200- 480 V / 50, 60 Hz / 3Ph+G
Machine dimensions, L x A x H	mm	6220 x 1340 x 1800
Net weight	kg	2425

SL 170F

Horizontal Form-Fill-Seal (HFFS) machine for stand-up pouches, operating from a single reel of flexible packaging material, forming the pouch, filling it with product, and sealing.

01 Machine Highlights

- Smart HMI
- High productivity with low maintenance costs
- Wide range of applicators such as zipper, top cap, corner cap, shapers, and dosers)
- Great performance for liquid and semi-liquid products
- Ready to work with 100% recyclable materials



SL 170F

02 Operating Cycle

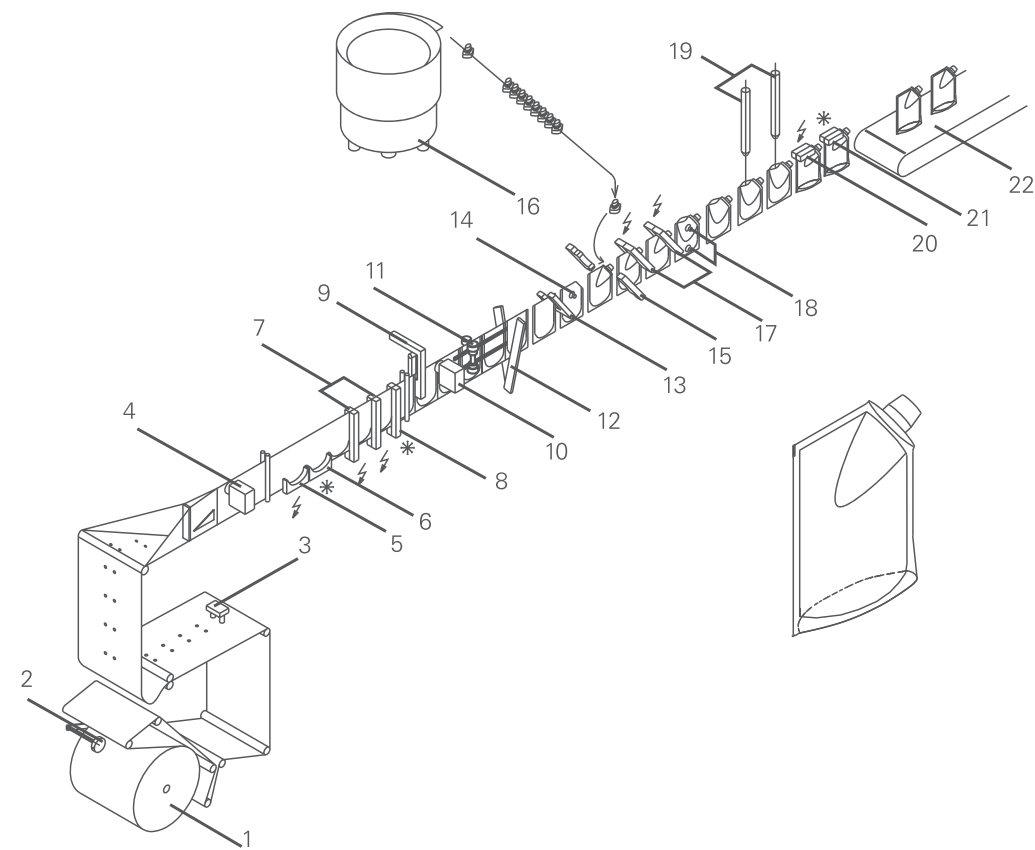

1. Reel

2. End of reel detector (Optional)

3. Reel Perforator

4. Photocell (Optional)

5. Bottom sealer

6. Bottom seal cooler

7. Vertical sealer

8. Vertical seal cooler
9. Coding

10. Photocell

11. Film draw

12. Scissors

13. Corner cutting

14. Suction cups

15. Spout applicator
16. Spout feeding

17. Spout sealer

18. Suction cups

19. Liquid filler

20. Top sealer

21. Top seal cooler

22. Discharge exit



03 Technical specification

SIMPLEX		
Min pouch size, W x H	mm	70 x 100 x 45
Max pouch size, W x H	mm	170 x 275 x 90
Max pouch volume	c.c	1000
Max output	ppm	60
Type of material		Heatsealable
Max reel width	mm	640
Max reel diameter	mm	500
Core reel diameter	mm	70 - 75
Consumption	[kW]	4,1
Electrical data		200- 480 V / 50, 60 Hz / 3Ph+G
Machine dimensions, L x A x H	mm	4000 x 1300 x 1800
Net weight	kg	2000

SL 140F

Horizontal Form-Fill-Seal (HFFS) machine for stand-up pouches, operating from a single reel of flexible packaging material, forming the pouch, filling it with product, and sealing.

01 Machine Highlights

- Soft movement of the walking beam allowing reaching high-speeds for liquids packaging.
- High versatility for small format packaging.
- Maximum robustness and guarantee of reliability.
- Smart HMI
- Easy handling and low maintenance costs
- Zipper and cap applicator for re-closable pouches
- Specially designed for shaped pouches
- Ready to work with 100% recyclable materials

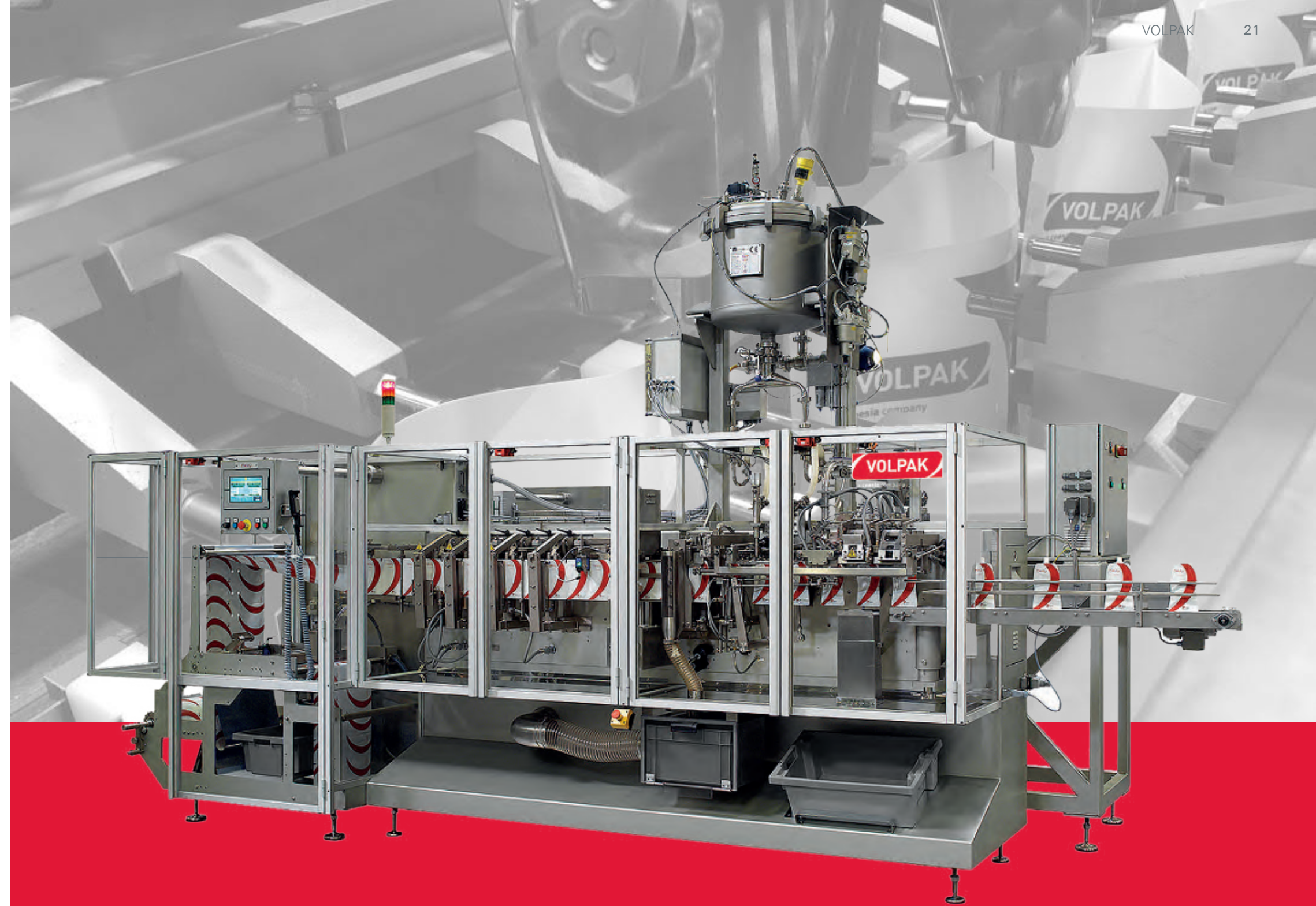

SL 140F

02 Operating Cycle

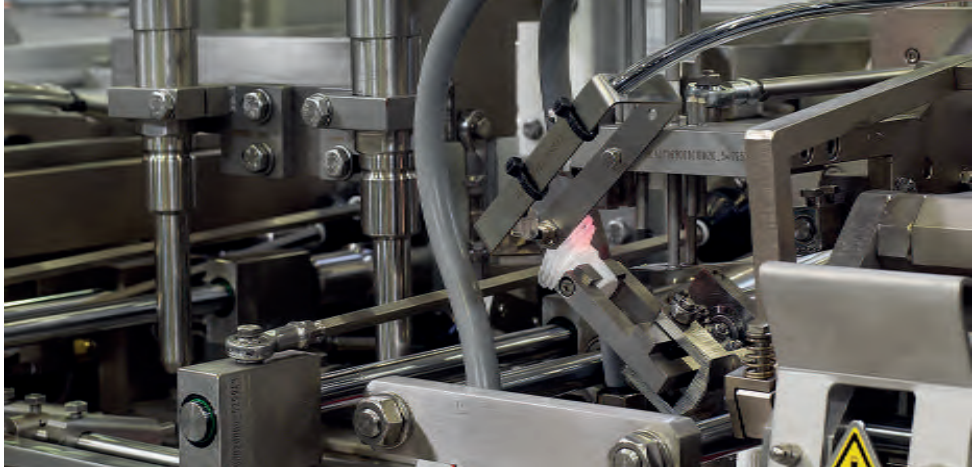
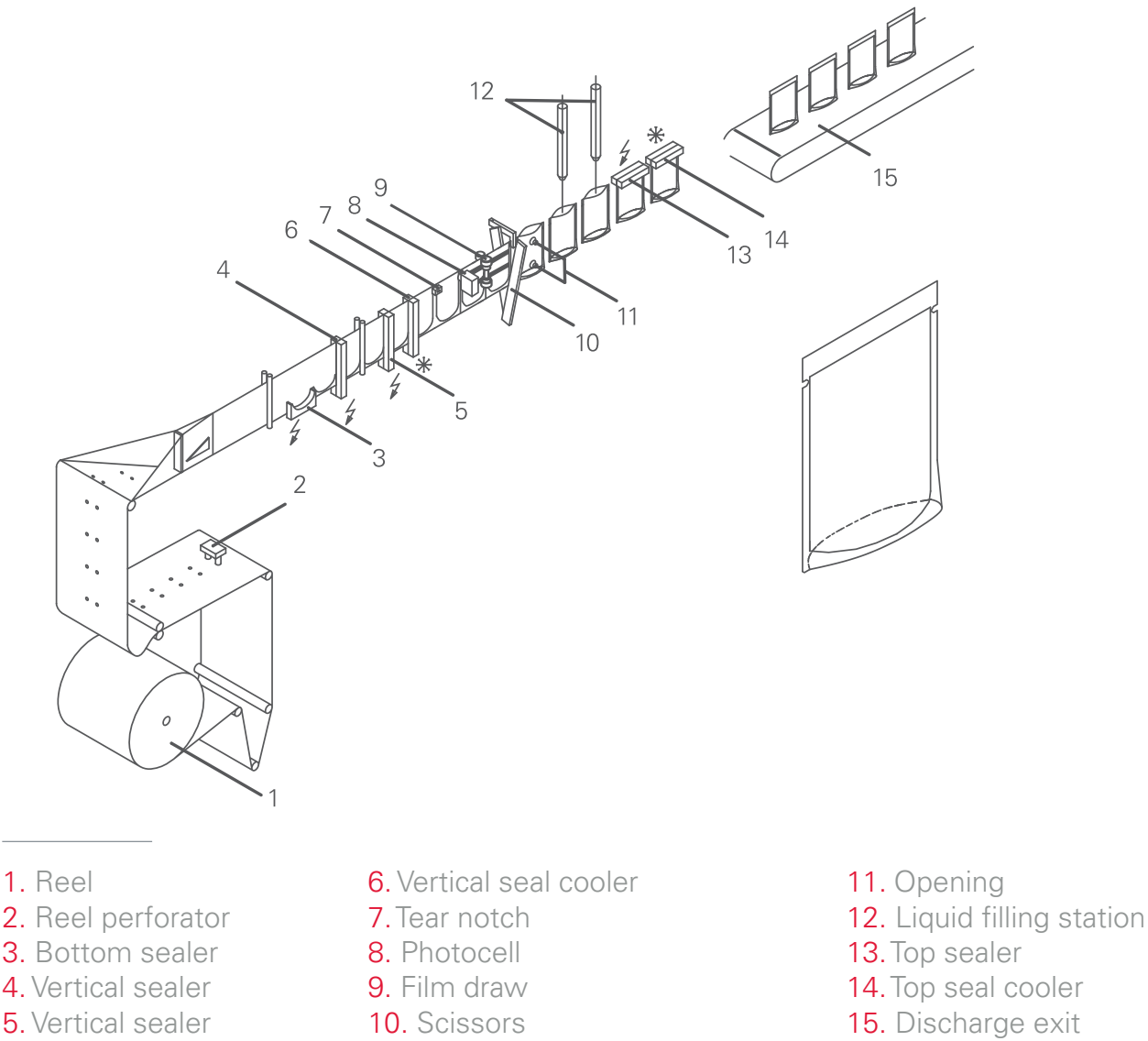

03 Technical specification

SIMPLEX		
Min pouch size, W x H	mm	70 x 100 x 45
Max pouch size, W x H	mm	140 x 225 x 70
Max pouch volume	c.c	650
Max output	ppm	60
Type of material		Heatsealable
Max reel width	mm	520
Max reel diameter	mm	450
Core reel diameter	mm	70 - 75
Consumption	[kW]	3,9
Electrical data		200- 480 V / 50, 60 Hz / 3Ph+G
Machine dimensions, L x A x H	mm	6765 x 1650 x 1800
Net weight	kg	6400

The background of the image shows a complex industrial machine, likely a horizontal form-fill-seal (HFFS) machine, with various rollers, gears, and structural components. A semi-transparent red overlay covers the entire image, creating a professional and industrial aesthetic. The text is positioned on the left side, with the main title in large, bold, white capital letters and the descriptive text below it in a slightly smaller, bold, white font. A thin white curved line is visible on the right side of the image, adding a modern design element.

VOLPAK SC+ SERIES:

**Horizontal Form-Fill-Seal
machines platform featuring
continuous filling technology,
ideal for high-speed and high-
production volumes projects**

SC+ HFFS

Horizontal Form-Fill-Seal platform featuring continuous filling technology, ideal for high speed and high-production volumes projects.

New platform concept: SC+ machine range, a breakthrough innovation in Stand-up pouch machinery reaching beyond production and performance levels.

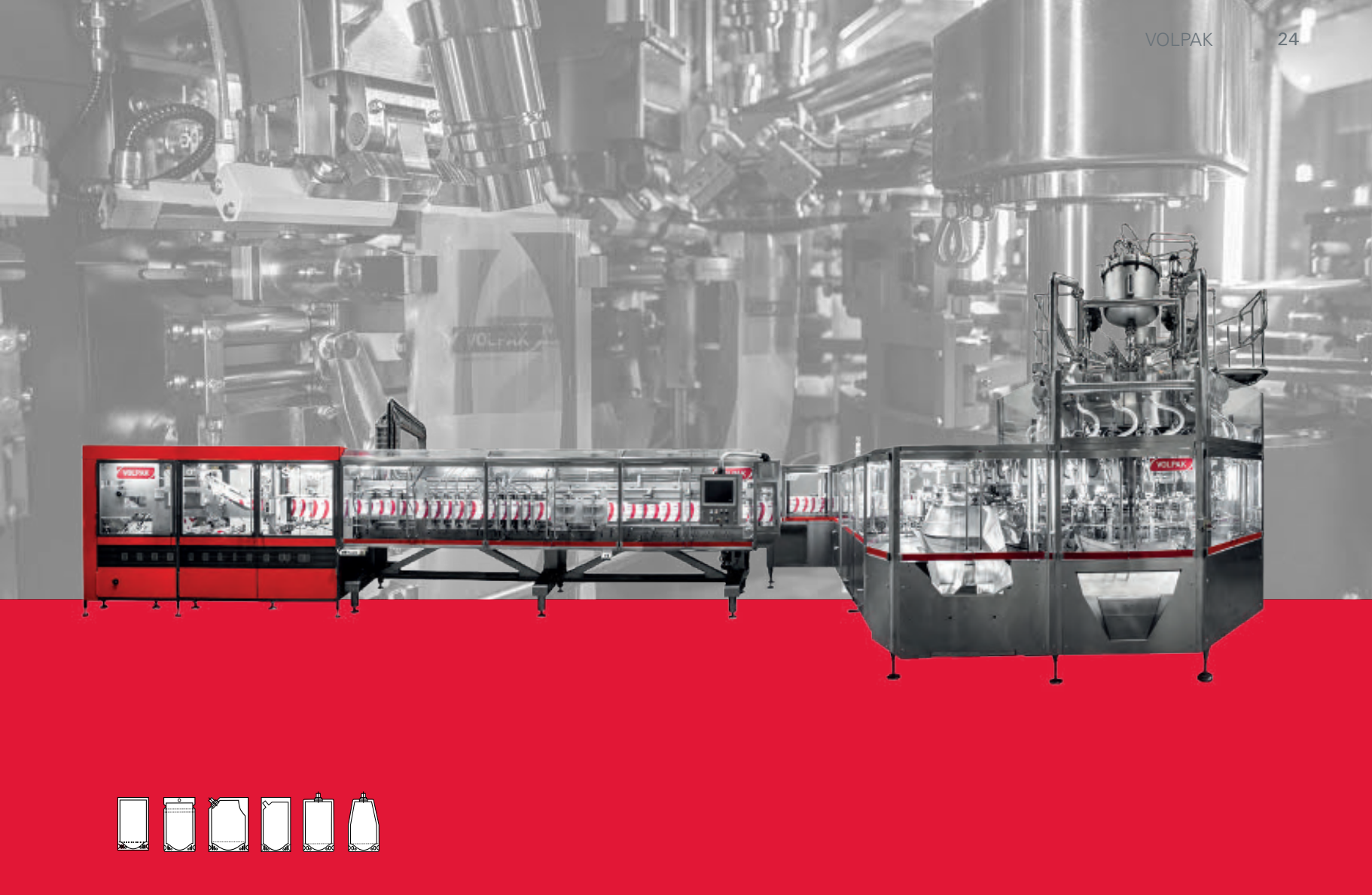

01 Machine Highlights

- Unique cutting: Contactless system for minimum wear and maintenance.
- Complete pouch stations: Short and smooth movements for pouch opening, filling, and sealing. Simple and easy operation.
- Continuous filling: Large process window for superior fill and seal conditions.
- Filling turret compact and smart: High speed production while keeping gentle pouch manipulation.
- Fast size change: Automatic and guided regulations for fast format change
- Ready to work with 100% recyclable materials

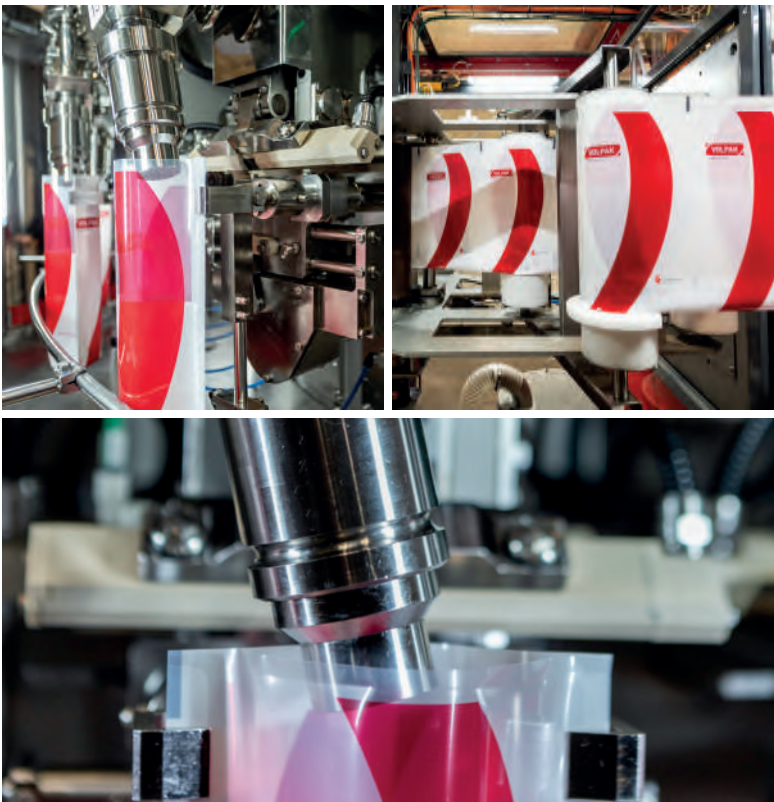

02 Technical Specifications

		SC + 180	SC + 240	SC + 300
Min pouch size, W x H	mm	85 x 110 x 30		
Max pouch size, W x H	mm	180 x 310 x 120	240 x 310 x 120	300 x 310 x 120
Max pouch volume	c.c	1000	2000	3000
Max output	ppm	400	320	250
Type of material		Heatsealable		
Max reel width	mm	745		
Max reel diameter	mm	600		
Core reel diameter	mm	148- 156		
Consumption	kW	70		
Machine dimensions, L x A x H	mm	17600 x 5500 x 5200		

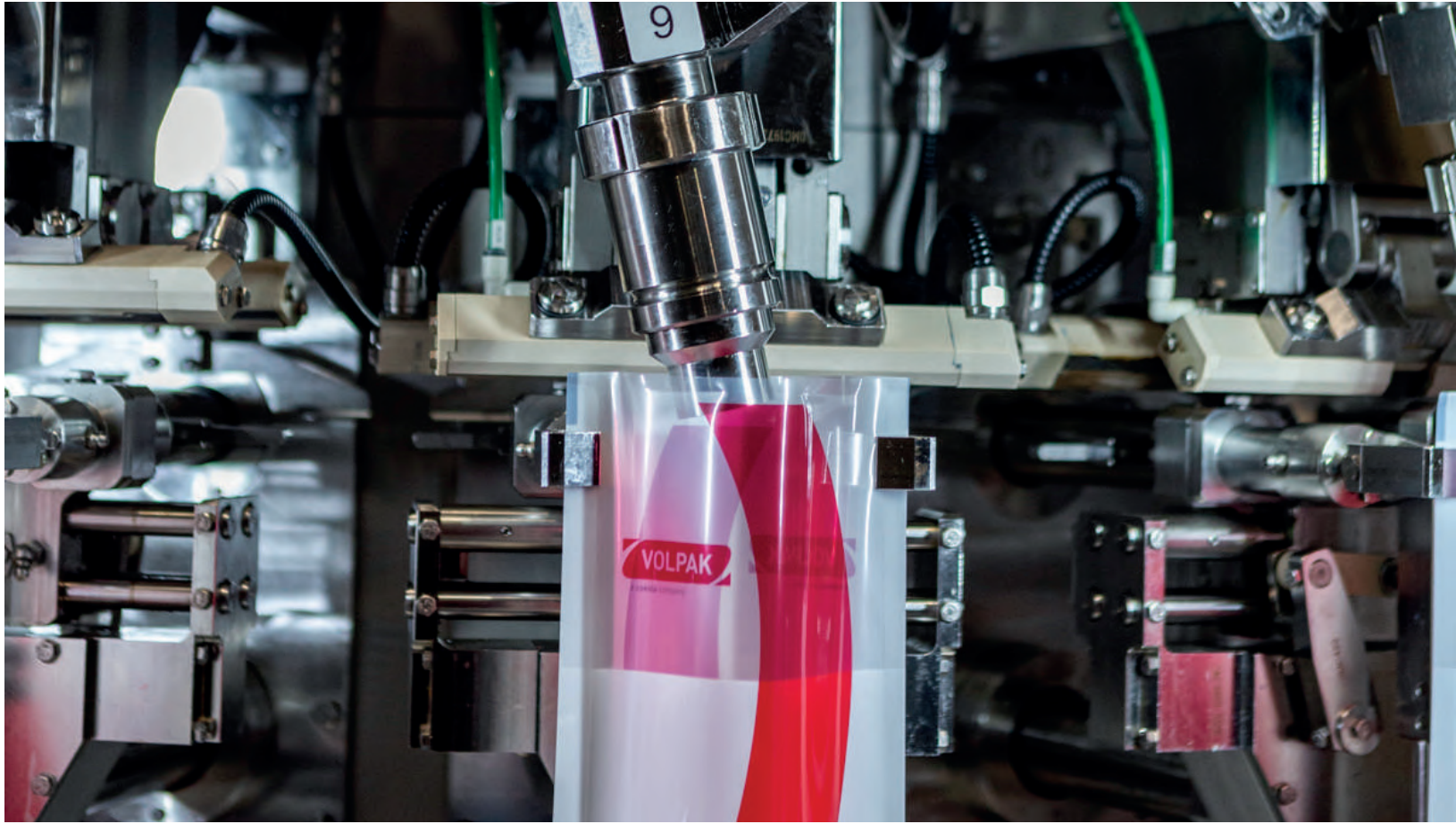
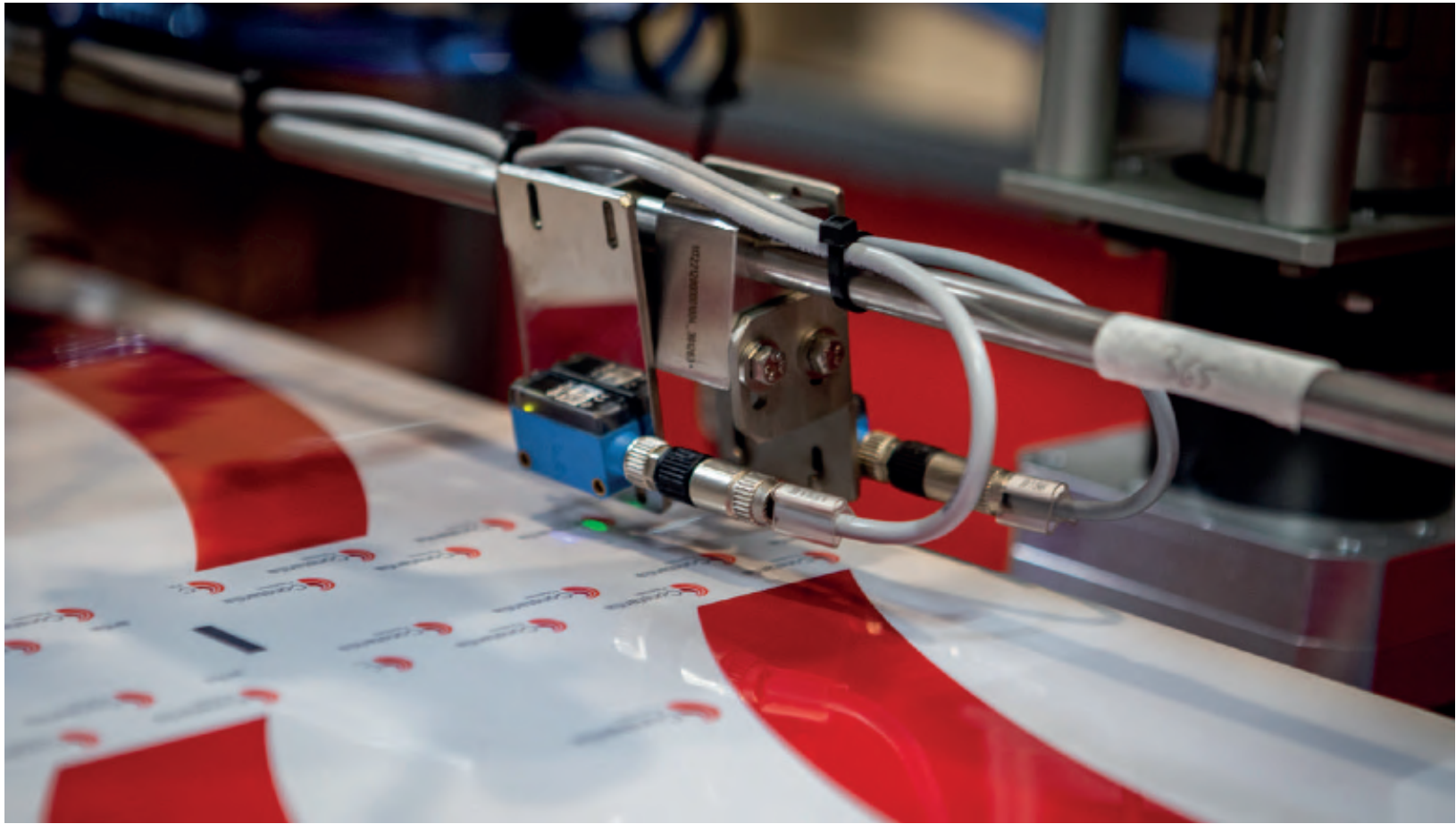
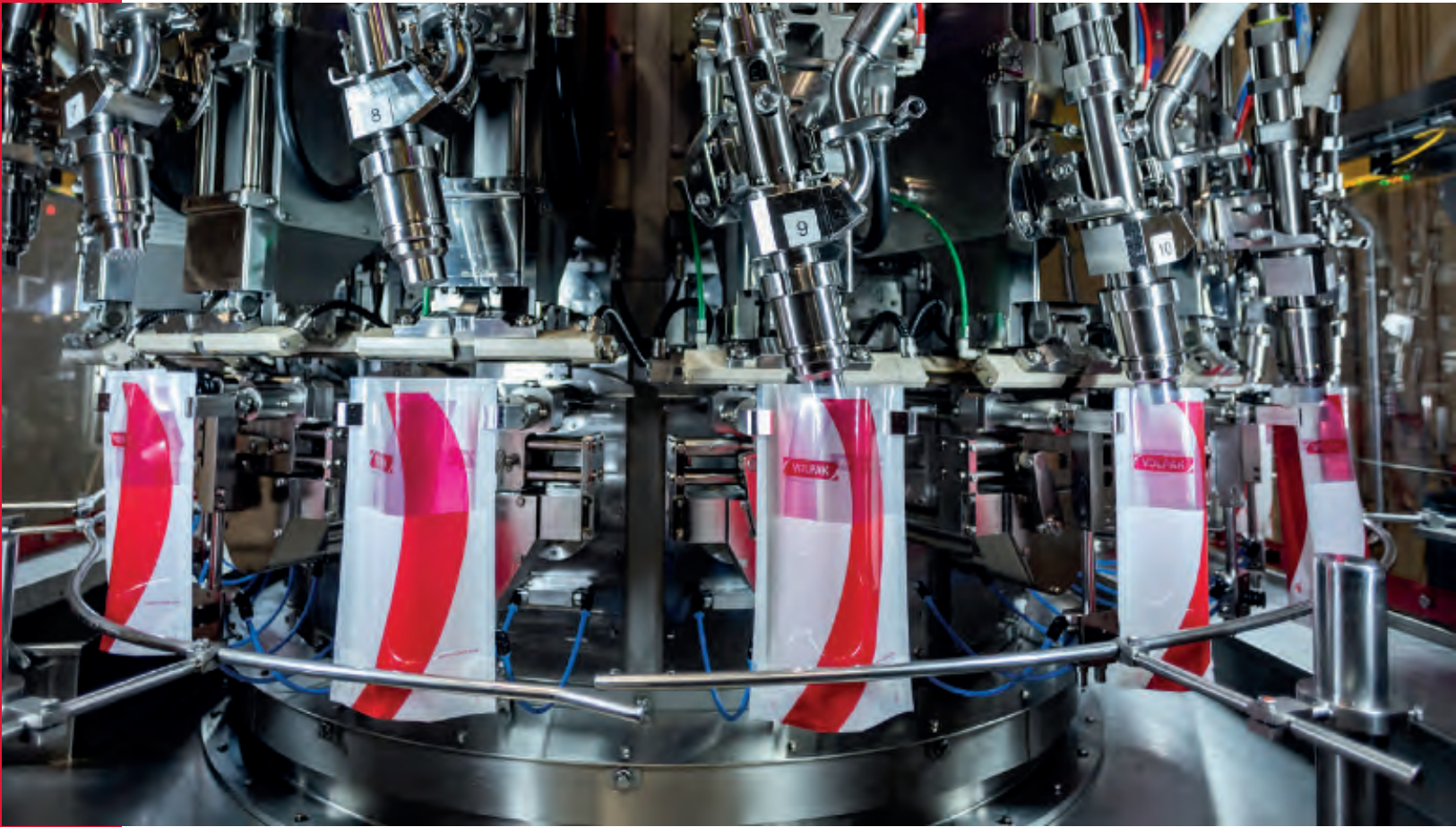

SC+ Premade

Premade Form-Seal platform featuring continuous filling technology, ideal for high speed and high-production volumes projects.

New platform concept: SC+ Premade, a breakthrough innovation in pre-made pouch machinery reaching production and performance levels never known before.



01 Machine Highlights

- Fast: Increasing production up to 300ppm
- Compact: Optimizing space thanks to small footprint
- Flexible: Using less material and producing less waste
- Connected: Featuring future-proof advanced technologies
- Sustainable: Suited for recyclable mono materials, compostable or paper-based pouches

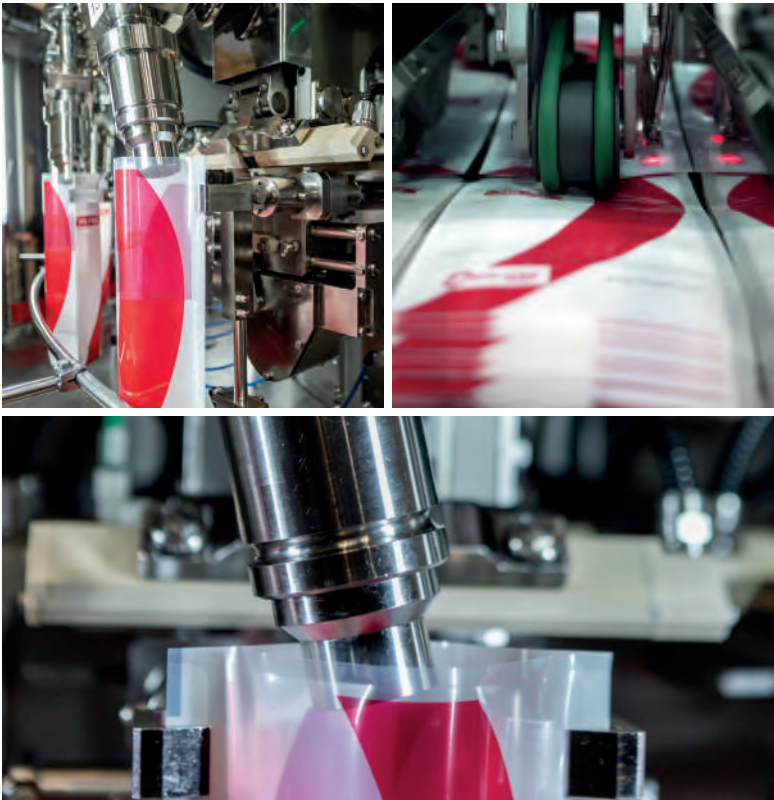

02 Technical Specifications

		SC+ Premade 180	SC+ Premade 240	SC+ Premade 300
Min pouch size, W x H	mm	85 x 110 x 30	110 x 110 x 30	110 x 110 x 30
Max pouch size, W x H	mm	180 x 400 x 120	240 x 400 x 120	300 x 400 x 120
Max pouch volume	c.c	1000	2000	3000
Max output	ppm	250	250	200
Type of material		Heatsealable		
Max reel width	mm	N/A		
Max reel diameter	mm	N/A		
Core reel diameter	mm	N/A		
Consumption	kW	70		
Machine dimensions, L x A x H	mm	6900 x 5400 x 5200		

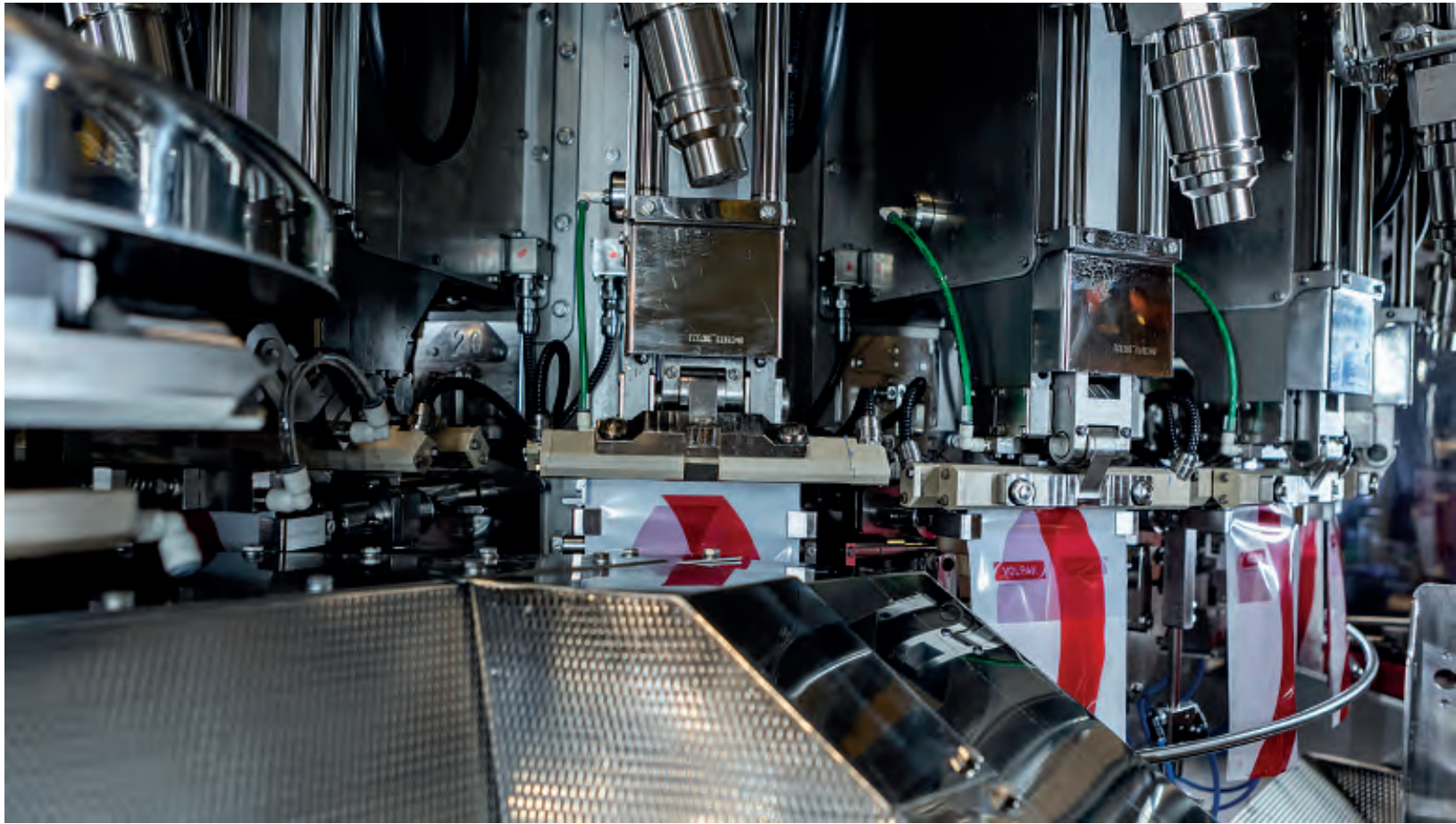

DIGITAL & SERVICES



COESIA DIGITAL:

The future has never been so human

Volpak focuses on the development of digital solutions that support people to do their job better and more easily, each and every day.

(optimize)

OptiMate is our proprietary smart HMI developed to facilitate the machine interaction and accelerate operations such as format change, troubleshooting, maintenance by enabling access to guided procedures and digital documentation directly on the machine.

(performate)

PerforMate is Coesia's IoT platform for real-time machine monitoring allowing manufact improve the control and performance of the entire machine pool, while acting as a single en to several innovative services.

(ultimate)

UltiMate is our advanced software platform for artificial intelligence and machine learning designed to enhance productivity, quality and maintenance, lowering waste and optimizing total cost of ownership.

(hypermate)

HyperMate is Coesia's end-to-end solution for Manufacturing Operations Management aimed at achieving complete digitalization of production processes. Thanks to its ability to adapt to customer processes, HyperMate improves operations by scaling automation to the factory level.

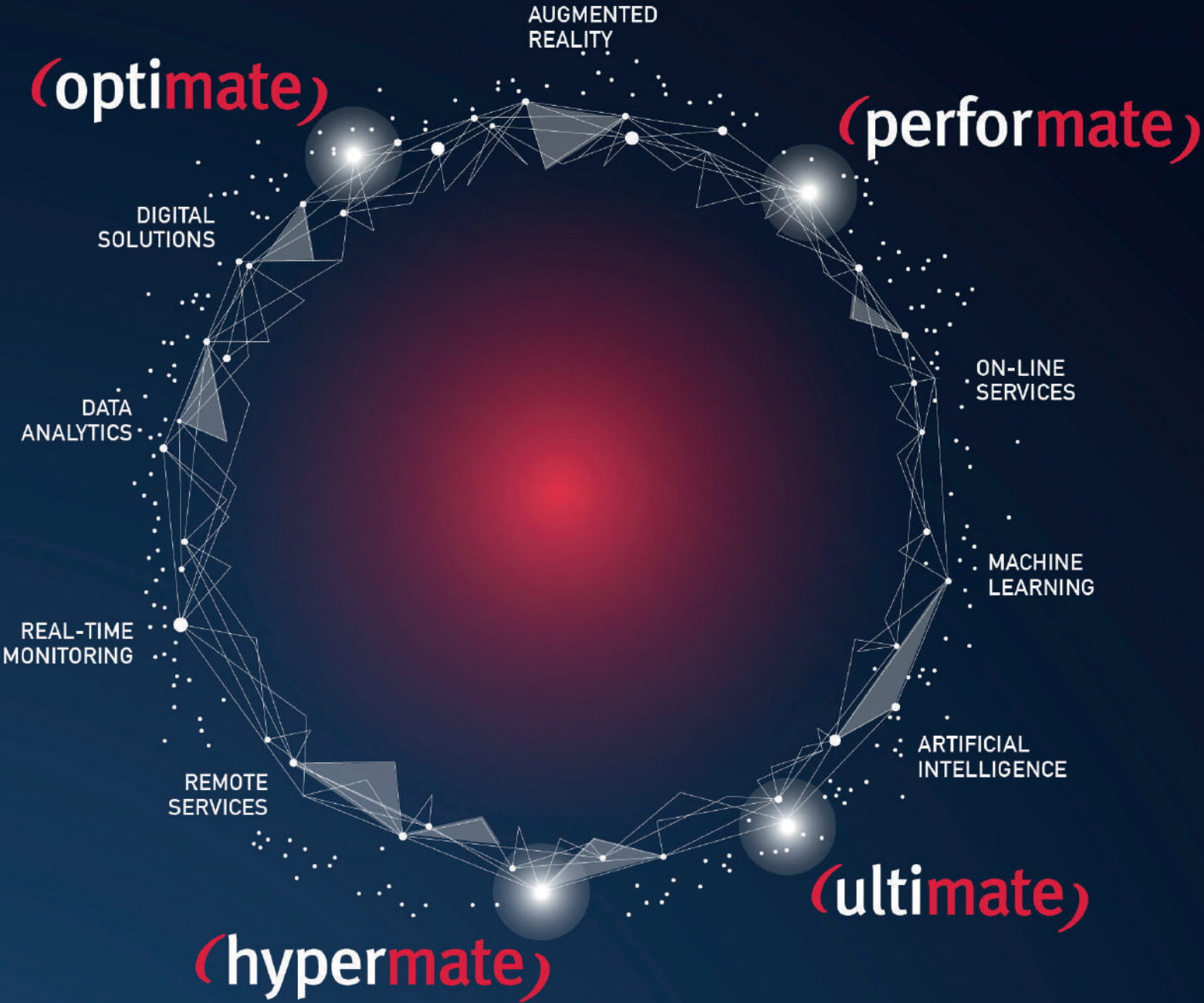

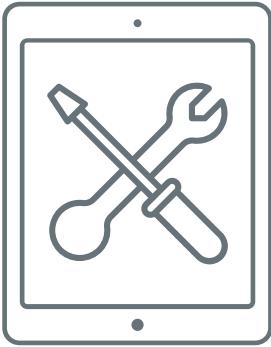

Remote Assistance



OEE Consulting



Service Agreements

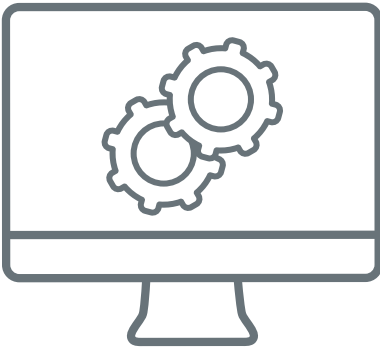

Webshop

CUSTOMERS FIRST: Volpak customer service

For us, Customer Service means ensuring proactive and continuous support- leveraging our global presence- in a fast, simple and flexible way manner, to guarantee the best possible Overall Equipment Effectiveness (OEE) and the lowest Total Cost of Ownership (TCO) for all Volpak and Enflex machines.

We offer a comprehensive portfolio of services for full equipment lifecycle management striving to keep up the pace with an evolving world.

Webshop

Webshop is our online platform to manage and monitor spare parts orders quickly and efficiently. Clear graphical interface, photographic catalog and the possibility to search and select components in different ways make Volpak’s webshop extremely intuitive and easy to use.

Machine Assessment

Machine Assessment is our service to identify and implement solutions that improve performances and contain costs. It is based on inspections performed by qualified Volpak technicians who evaluates the machine status and collects all the data to provide suggestions for tailored interventions:

- part replacement and machine upgrades
- technical assistance and maintenance
- tailored training

Training / E-training

Obtain the maximum performance of your machine by taking advantage of our Training Services to secure and develop your team competence and capability.

Remote Assistance

Thanks to advanced remote connectivity and collaboration tools, video and augmented reality, Volpak is able to provide remote technical support and diagnosis in real time.

Service Agreements

A suite of structured services that may be customized based on customer needs to optimize maintenance, ensure the best possible conditions of use and maximum productivity.

POUCH LAB:

Our approach to sustainability

At Volpak, not only do we design packaging machines ready-to-work with sustainable materials, but we also work close to our customers to find more environmentally friendly packaging materials.

In our PouchLab laboratory, our customers can test the behavior of the different materials in a real production environment.





85
PRODUCTION
PLANTS
in 139 OPERATING UNITS

36
COUNTRIES

8,000+
EMPLOYEES

20
COMPANIES
with HEADQUARTERS
in 8 COUNTRIES

Volpak S.A.U
Pol. Ind. Can Vinyalets
C/ Can Vinyalets 4
08130 Santa Perpètua de Mogoda
Barcelona, Spain

main@volpak.com
www.volpak.com

Volpak, part of Coesia Group, is one of the leading brands of horizontal form-fill-seal (HFFS) machines for flexible packaging in the consumer goods market. It designs and manufactures automatic packaging machines for different markets: food & beverage, dairy, personal care, home care, chemical, pharmaceutical, pet care, tea, and coffee.

