

coesia

VOLPAK SOLUTIONS FOR WET PET FOOD

Wet Pet Food

- 01

Caring for pets has become an important aspect of consumer behaviour, as evidenced by the growth of the premium sector in pet products.
- 02

The doypack with zipper for pet treats, snacks, or pet care complements, and flat sachets for wet pet food, have emerged as the preferred packaging options for pet food.
- 03

Flexible packaging offers numerous advantages, such as convenience, lightweight, long shelf life, and the potential for being 100% recyclable.
- 04

E-commerce has introduced diverse packaging formats to meet the requirements of the global market, prioritizing tailor-made designs for online purchasing channels.

Why Volpak?

Volpak designs and manufactures a wide range of HFFS machines for packing wet pet food in different formats and sizes.



Expertise & know-how in the pet food industry



Pouches’ appeal is a determining factor, as well as the quality of the finishing. Our technology allows you to produce attractive pouches that are both leak-free and cost-effective compared to pre-made pouches.



Machines equipped with the latest features, seal integrity kit, steam, single or multiple fill station for the gravy and chunks, necessary for the wet pet food pouches and retort process.



Sustainable ready: all Volpak solutions are ready to work with 100% recyclable and sustainable materials.



Wide range portfolio meeting customer demands for quality, quick pouch size change, and production capacity, up to 360 pouches/min.

SOLUTIONS

01

VOLPAK SI SERIES

Horizontal Form-Fill-Seal machine for medium to high speed projects, featuring servo-driven technology and accommodating a wide range of options and applicators.

02

VOLPAK SP SERIES

Horizontal Form-Fill-Seal machines for medium-speed projects, mainly mechanical-driven, and accommodating various options and applicators.



VOLPAK SI SERIES:

**Horizontal Form-Fill-Seal machine
for medium to high speed
projects, featuring servo-driven
technology and accommodating
a wide range of options and
applicators**

SI 440

Horizontal Form-Fill-Seal (HFFS) machine for stand-up pouches, operating from a single reel of flexible packaging material, forming the pouch, filling it with product, and sealing.

01 Machine Highlights

- Duplex, Triplex or Quadruplex operation
- Smart HMI, easy and intuitive
- Mirror execution for footprint optimization
- Three dosing stations for multi-product filling
- Easy size change with guided operations and servo assisted regulations
- Low operating and maintenance costs
- Wide variety of pouch styles available (regular, shaped, top cap, corner cap, front cap, zipper, 3- or 4-side sealed sachets,...)
- Ready to work with 100% recyclable materials

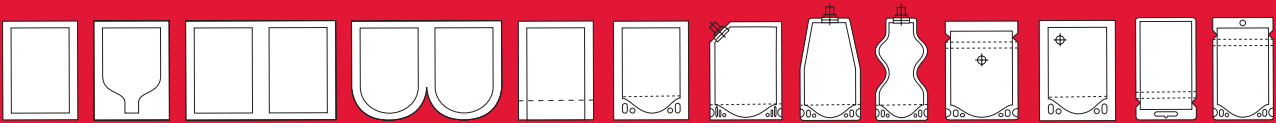
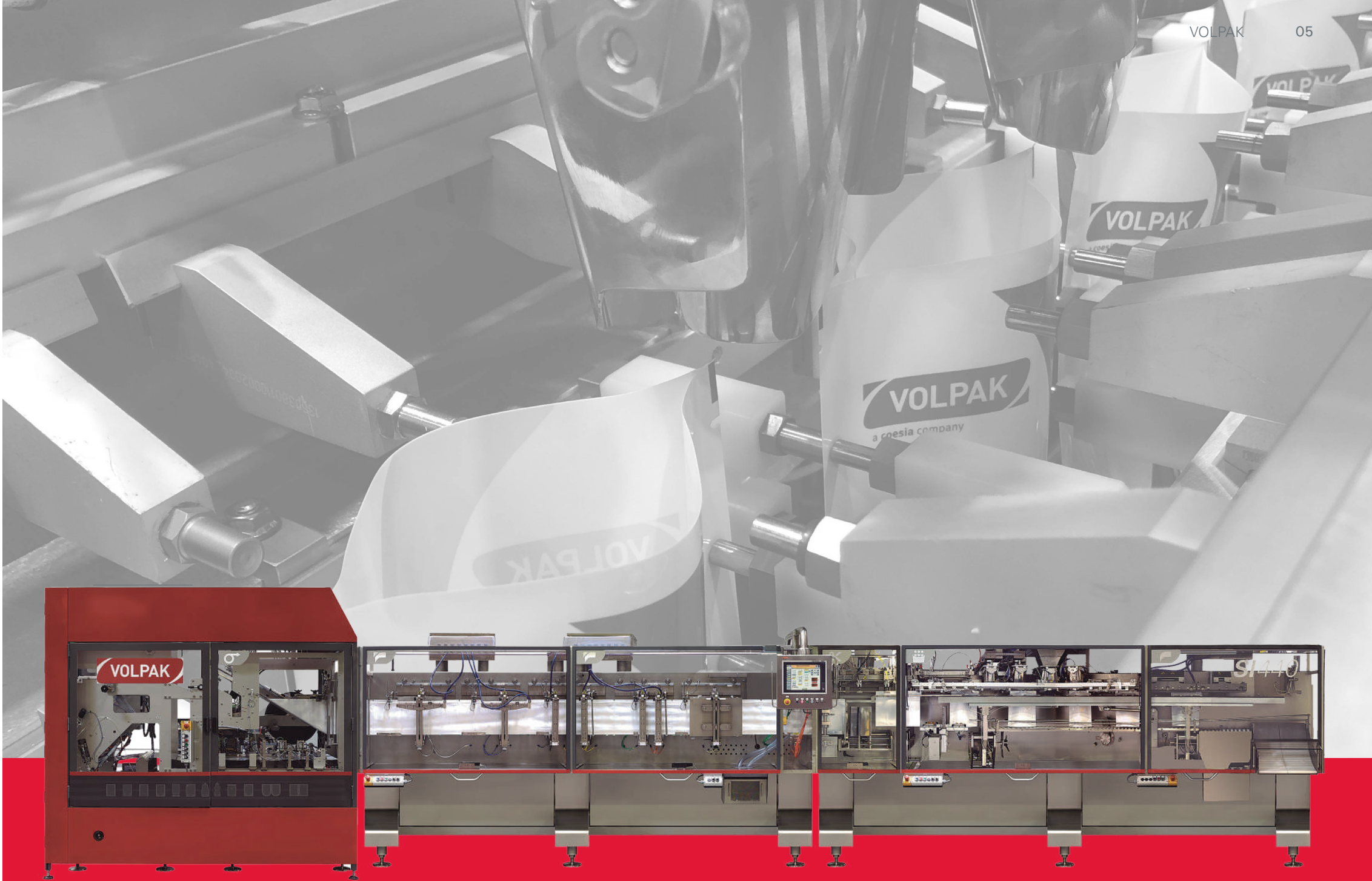

SI 440

02 Operating Cycle

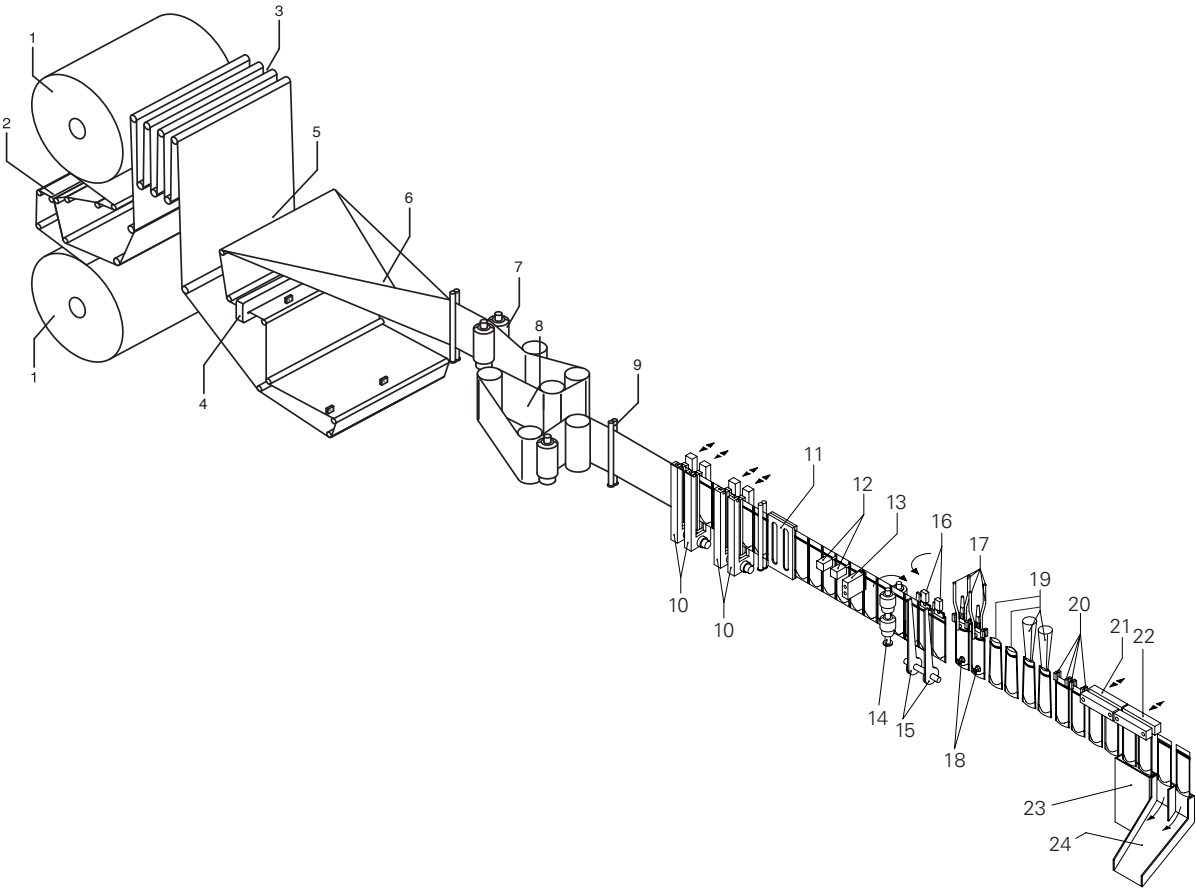

1. Reel

2. Reel splicing

3. Film buffer

4. Gusset perforator

5. Reel aligner

6. Forming triangle

7. Servo roller for film pulling

8. Buffer to intermittent motion

9. Film guide
10. Vertical seal

11. Cooling

12. Tear notch

13. Eyemark photocell

14. Servo rollers for film transport

15. Cutting knife

16. Pouch positioning & transfer

17. Pouch opening
18. Bottom pouch opening

19. Filling stations

20. Pouch top stretching

21. Top sealing

22. Top cooling station

23. Pouch reject station

24. Discharge ramp

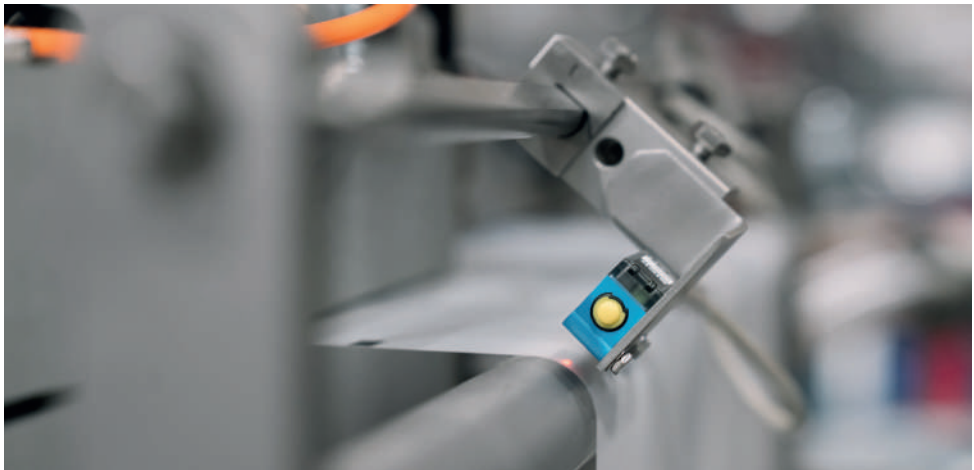

03 Technical Specifications

		DUPLEX	TRIPLEX	QUADRUPLEX
Min pouch size, W x H	mm	120 x 110 x 30	85 x 110 x 30	85 x 110 x 30
Max pouch size, W x H	mm	220 x 310 x 125	145 x 310 x 85	110 x 310 x 60
Max pouch volume	c.c	2000	600	300
Max output	ppm	120	180	240
Type of material		Heatsealable		
Max reel width	mm	745		
Max reel diameter	mm	600		
Core reel diameter	mm	74- 78 / 150- 154		
Electrical data		200- 480 V / 50, 60 Hz / 3Ph+G		
Machine dimensions, L x A x H	mm	12300 x 2180 x 2260		
Net weight	kg	10000		

Horizontal Form-Fill-Seal (HFFS) machine for stand-up pouches, operating from a single reel of flexible packaging material, forming the pouch, filling it with product, and sealing.

- Duplex, Triplex or Quadrex operation
- Smart HMI, easy and intuitive
- Mirror execution for footprint optimization
- Three dosing stations for multi-product filling
- Easy size change with guided operations and quick regulations
- Low operating and maintenance costs
- Wide variety of pouch styles available (regular, shaped, top cap, corner cap, front cap, zipper, 3- or 4-side sealed sachets,...)
- Ready to work with 100% recyclable materials

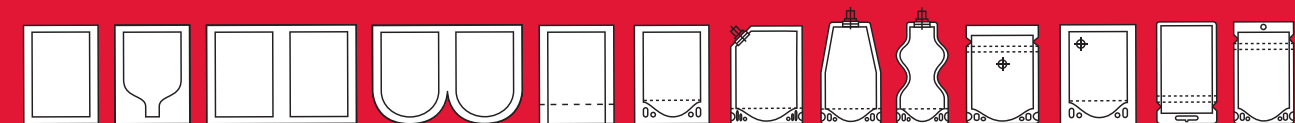

SI 360

02 Operating Cycle

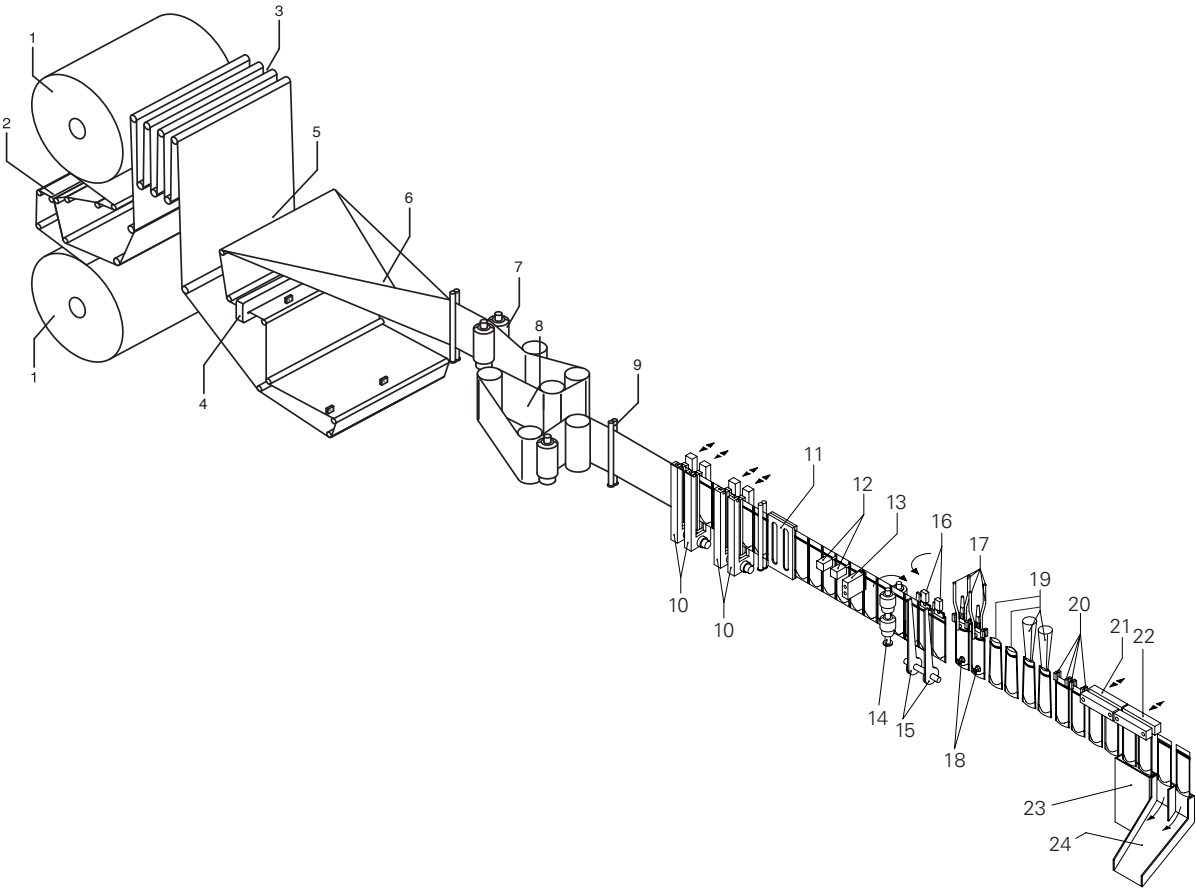

1. Reel

2. Reel splicing

3. Film buffer

4. Gusset perforator

5. Reel aligner

6. Forming triangle

7. Servo roller for film pulling

8. Buffer to intermittent motion

9. Film guide
10. Vertical seal

11. Cooling

12. Tear notch

13. Eyemark photocell

14. Servo rollers for film transport

15. Cutting knife

16. Pouch positioning & transfer

17. Pouch opening
18. Bottom pouch opening

19. Filling stations

20. Pouch top stretching

21. Top sealing

22. Top cooling station

23. Pouch reject station

24. Discharge ramp

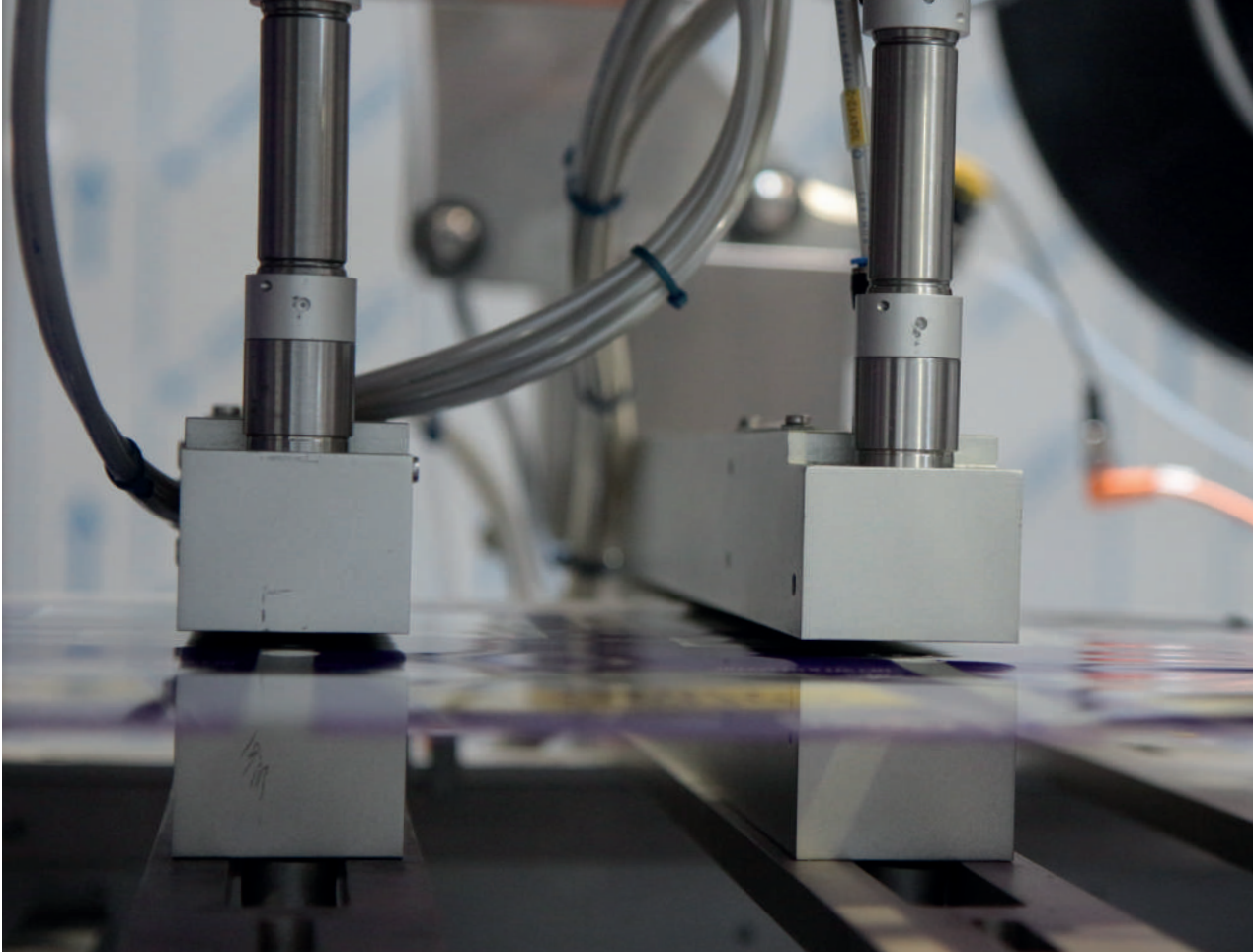

03 Technical specification

		DUPLEX	TRIPLEX	QUADRUPLEX
Min pouch size, W x H	mm	120 x 110 x 30	85 x 110 x 30	85 x 110 x 30
Max pouch size, W x H	mm	180 x 310 x 90	120 x 310 x 60	90 x 310 x 60
Max pouch volume	c.c	1500	500	200
Max output	ppm	120	180	240
Type of material		Heatsealable		
Max reel width	mm	710		
Max reel diameter	mm	600		
Core reel diameter	mm	74- 78 / 150- 154		
Electrical data		200- 480 V / 50, 60 Hz / 3Ph+G		
Machine dimensions, L x A x H	mm	10000 x 2075 x 2420		
Net weight	kg	8600		

SI 280

Horizontal Form-Fill-Seal (HFFS) machine for stand-up pouches, operating from a single reel of flexible packaging material, forming the pouch, filling it with product, and sealing.

01 Machine Highlights

- Simplex, Duplex or Triplex operation
- Smart HMI, easy and intuitive
- Mirror execution for footprint optimization
- Three dosing stations for multi-product filling
- Easy size change with guided operations and quick regulations
- Low operating and maintenance costs
- Wide variety of pouch styles available (regular, shaped, top cap, corner cap, front cap, zipper, 3- or 4-side sealed sachets,...)
- Ready to work with 100% recyclable materials

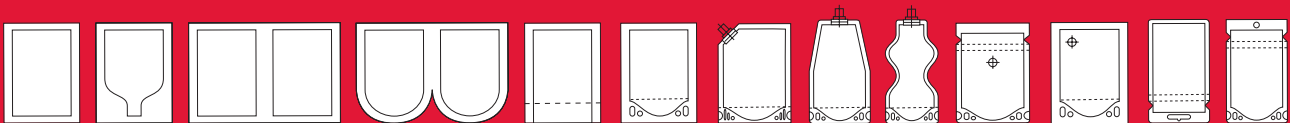
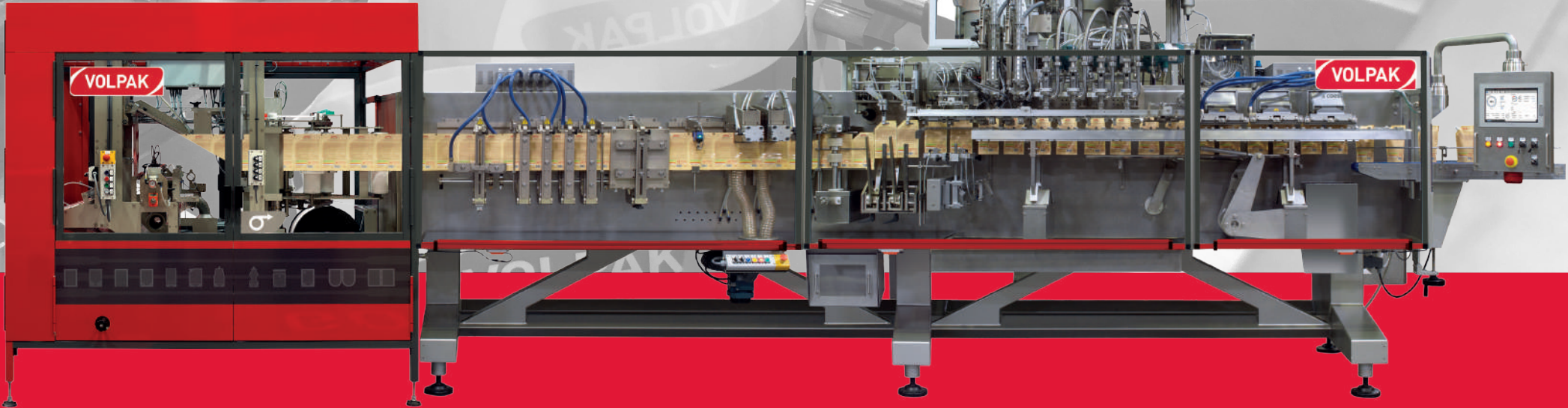

SI 280

02 Operating Cycle

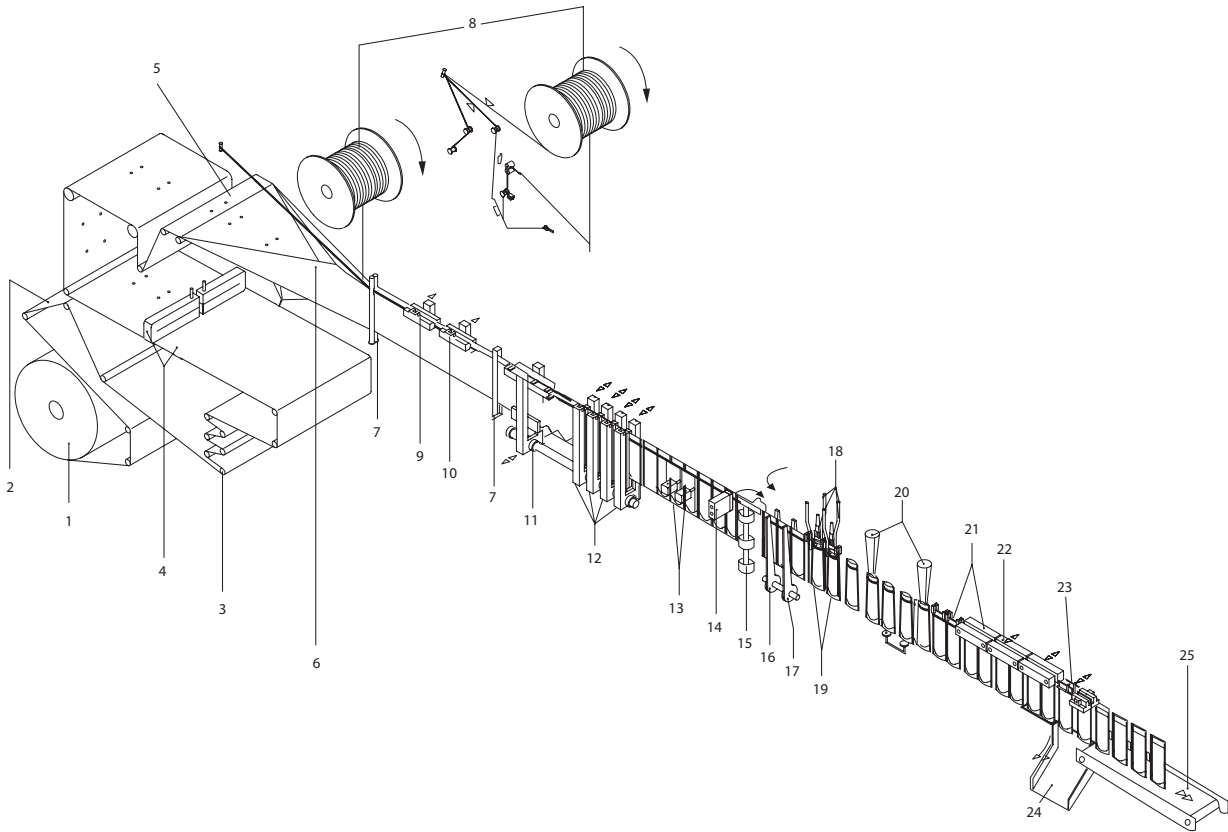

1. Reel

2. Film splicing

3. Unwinder

4. Gusset perforator

5. Band aligner

6. Forming triangle

7. Film guides

8. Zipper unwinder

9. Zipper seal
10. Zipper sealer

11. Bottom seal

12. Vertical seal

13. Tear notch

14. Photocell

15. Servo rollers for film transport

16. Knife

17. Knife and unitary cutting

18. Pouch opening
19. Bottom pouch opening

20. Fillings stations

21. Pouch stretching

22. Top sealing

23. Pouch reject station

24. Reject ramp

25. Discharge Belt



03 Technical Specifications

		SIMPLEX	DUPLEX	TRIPLEX
Min pouch size, W x H	mm	75 x 90 x 30	75 x 90 x 30	75 x 90 x 30
Max pouch size, W x H	mm	280 x 310 x 105	140 x 310 x 80	90 x 310 x 60
Max pouch volume	c.c	2500	600	150
Max output	ppm	80	160	240
Type of material		Heatsealable		
Max reel width	mm	725		
Max reel diameter	mm	600		
Core reel diameter	mm	74- 78 / 150- 154		
Electrical data		200- 480 V / 50, 60 Hz / 3Ph+G		
Machine dimensions, L x A x H	mm	8035 x 1865 x 2150		
Net weight	kg	6000		



VOLPAK SP SERIES:

**Horizontal Form-Fill-Seal
machines for medium-speed
projects, mainly mechanical-
driven, and accommodating
various options and applicators**

SP 220

Horizontal Form-Fill-Seal (HFFS) machine for sachets, operating from a single reel of flexible packaging material, forming the pouch, filling it with product, and sealing.

01 Machine Highlights

- Simplex or Duplex operation
- Smart HMI
- Easy handling and low maintenance costs
- Zipper and cap applicator for re-closable pouches.
- Wide variety of sachet formats available both for stand-up or flat pouches
- Ready to work with 100% recyclable materials

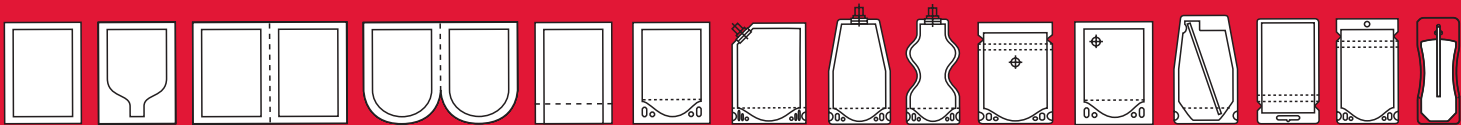
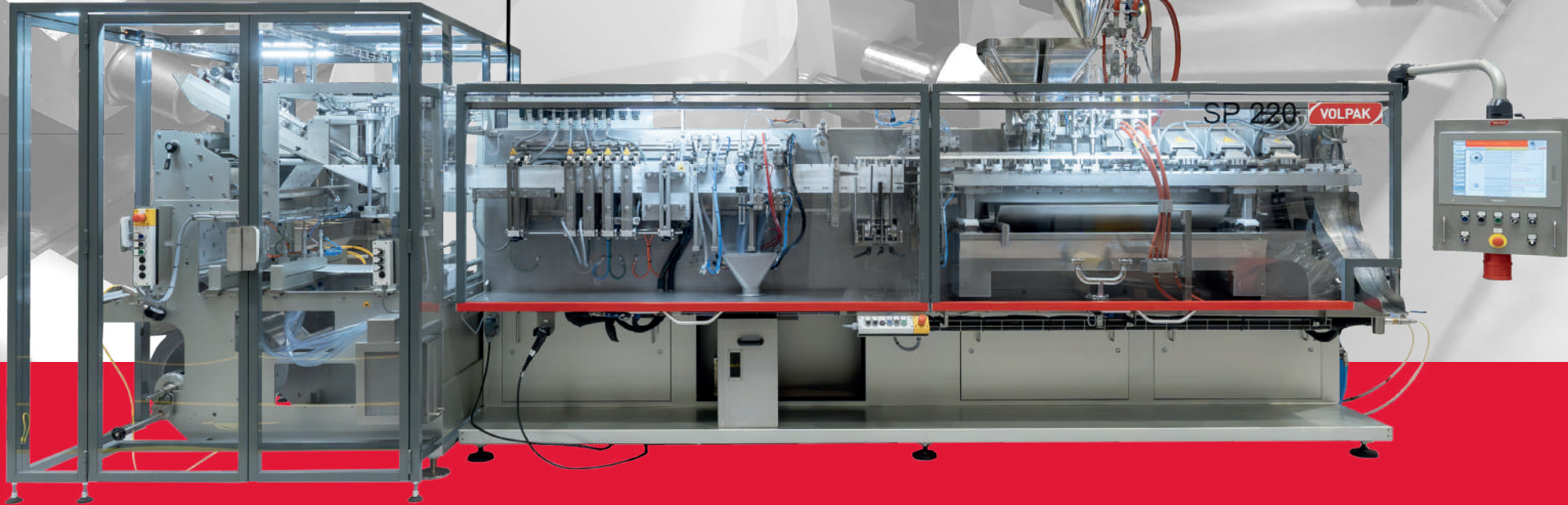
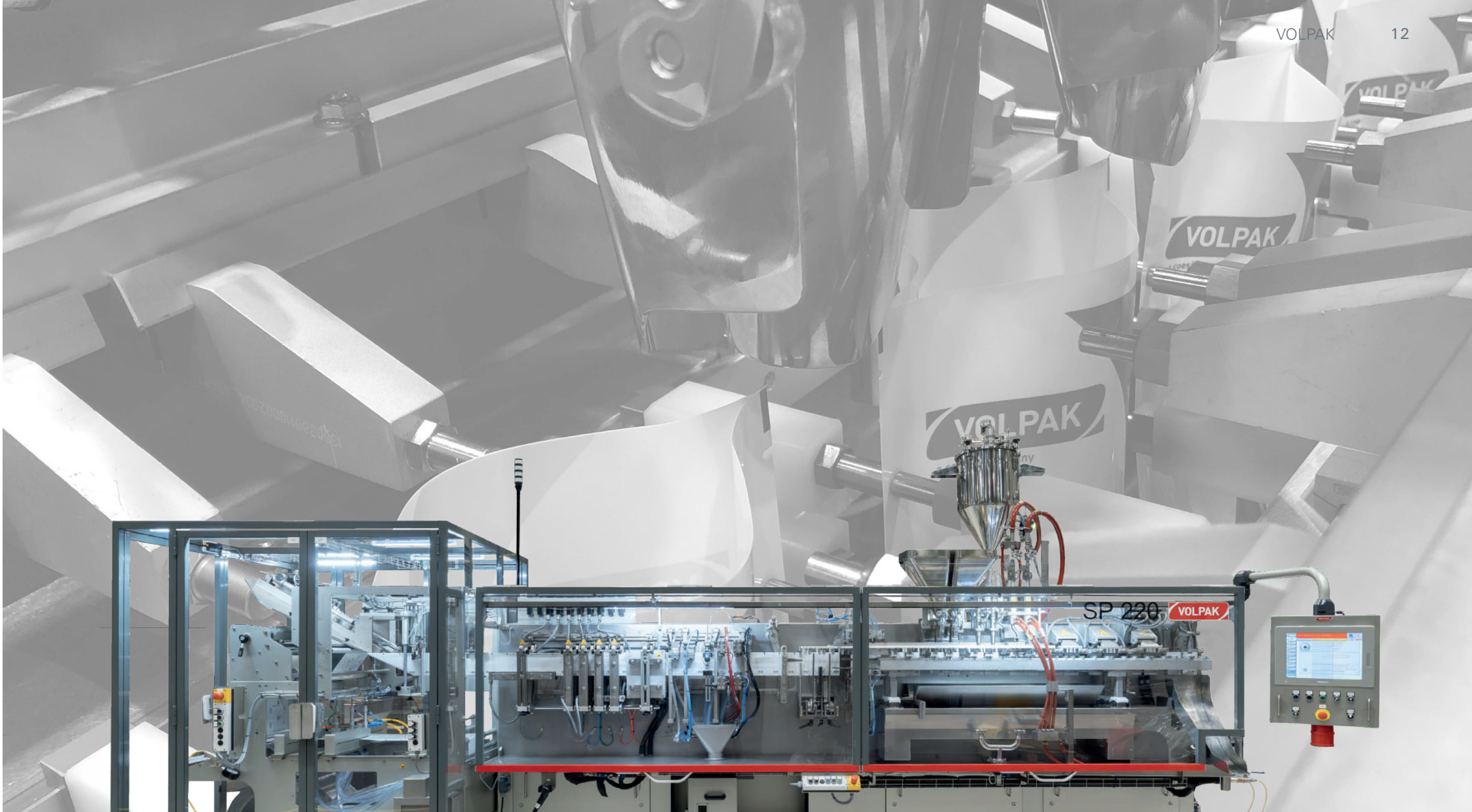

SP 220

02 Operating Cycle

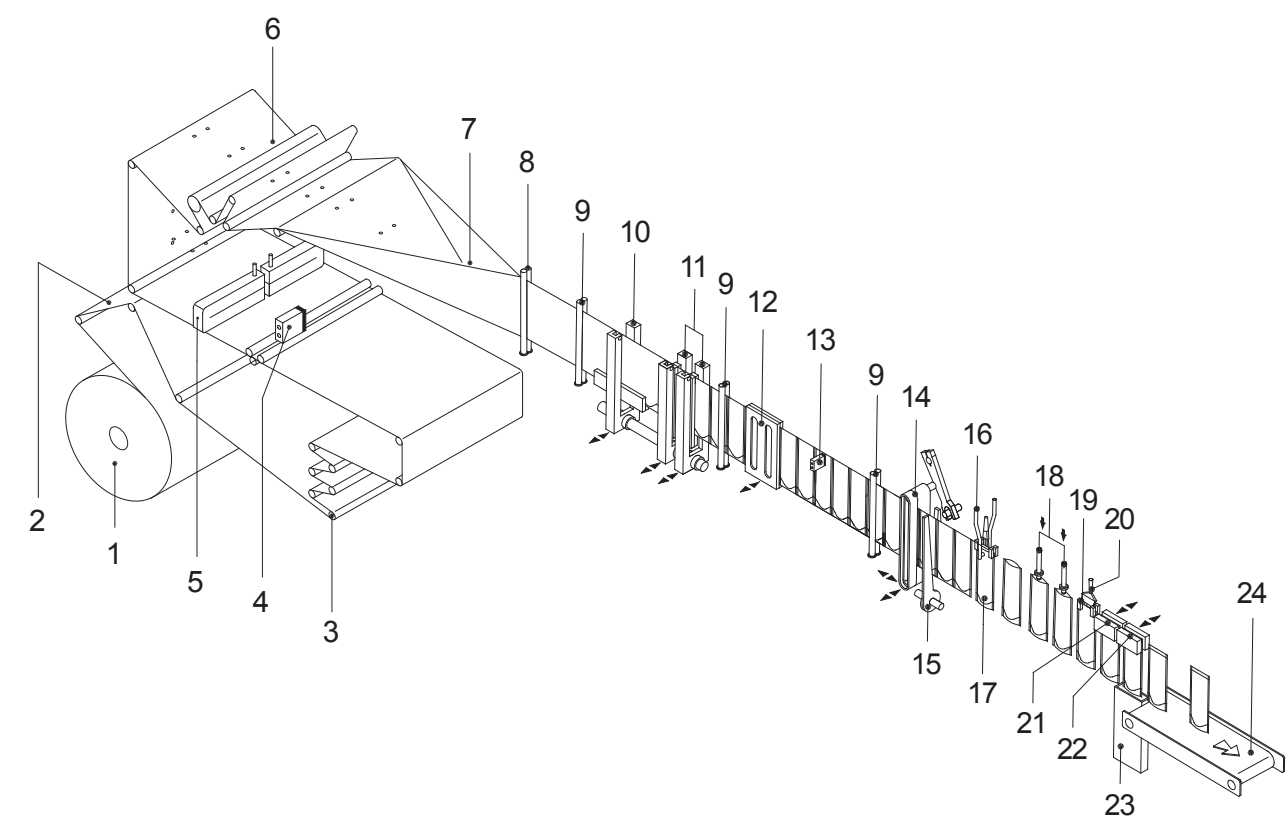

1. Film shaft

2. Film splicer

3. Unwinder arm

4. Photocell

5. Perforator

6. Reel aligner

7. Forming triangle

8. Film guide

9. Film guide
10. Bottom sealing

11. Vertical sealing

12. Cooling and flattering

13. Photocell

14. Film transport

15. Scissors

16. Top pouch opening

17. Bottom pouch opening

18. Dosing station
19. Static stretching

20. Foam suction

21. Top sealing

22. Top cooling seals

23. Rejected pouches

24. Outlet belt



03 Technical Specifications

		SIMPLEX	DUPLEX
Min pouch size, W x H	mm	70 x 60 / 70 x 100 x 30	50 x 60 / 50 x 90 x 30
Max pouch size, W x H	mm	220 x 270 (x 90)	110 x 270 (x 100)
Max pouch volume	c.c	1200	350
Max output	ppm	100	200
Type of material		Heatsealable	
Max reel width	mm	630	
Max reel diameter	mm	600	
Core reel diameter	mm	74- 78 / 150- 154	
Electrical data		220, 380, 440 V / 50, 60 Hz	
Machine dimensions, L x A x H	mm	5650 x 1650 x 1800	
Net weight	kg	5750	

SP 170

Horizontal Form-Fill-Seal (HFFS) machine for sachets, operating from a single reel of flexible packaging material, forming the pouch, filling it with product, and sealing.

01 Machine Highlights

- Simplex or duplex operation
- Smart HMI, easy and intuitive
- Two dosing systems can be installed simultaneously
- Space to include additional equipment, such as cameras, printers, labelers...
- Numeric counters for easy size change
- Low operating and maintenance costs
- Wide variety of sachet formats available (3- or 4-side sealed sachets, twin sachets, shaped sachets...)
- Ready to work with 100% recyclable materials

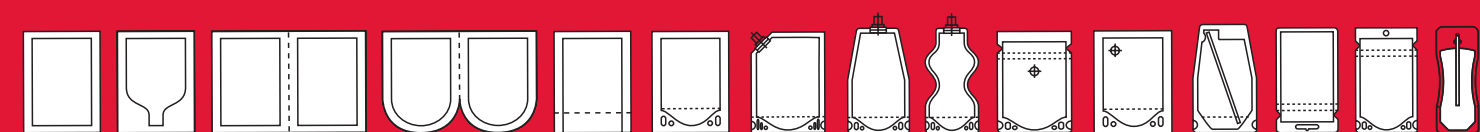
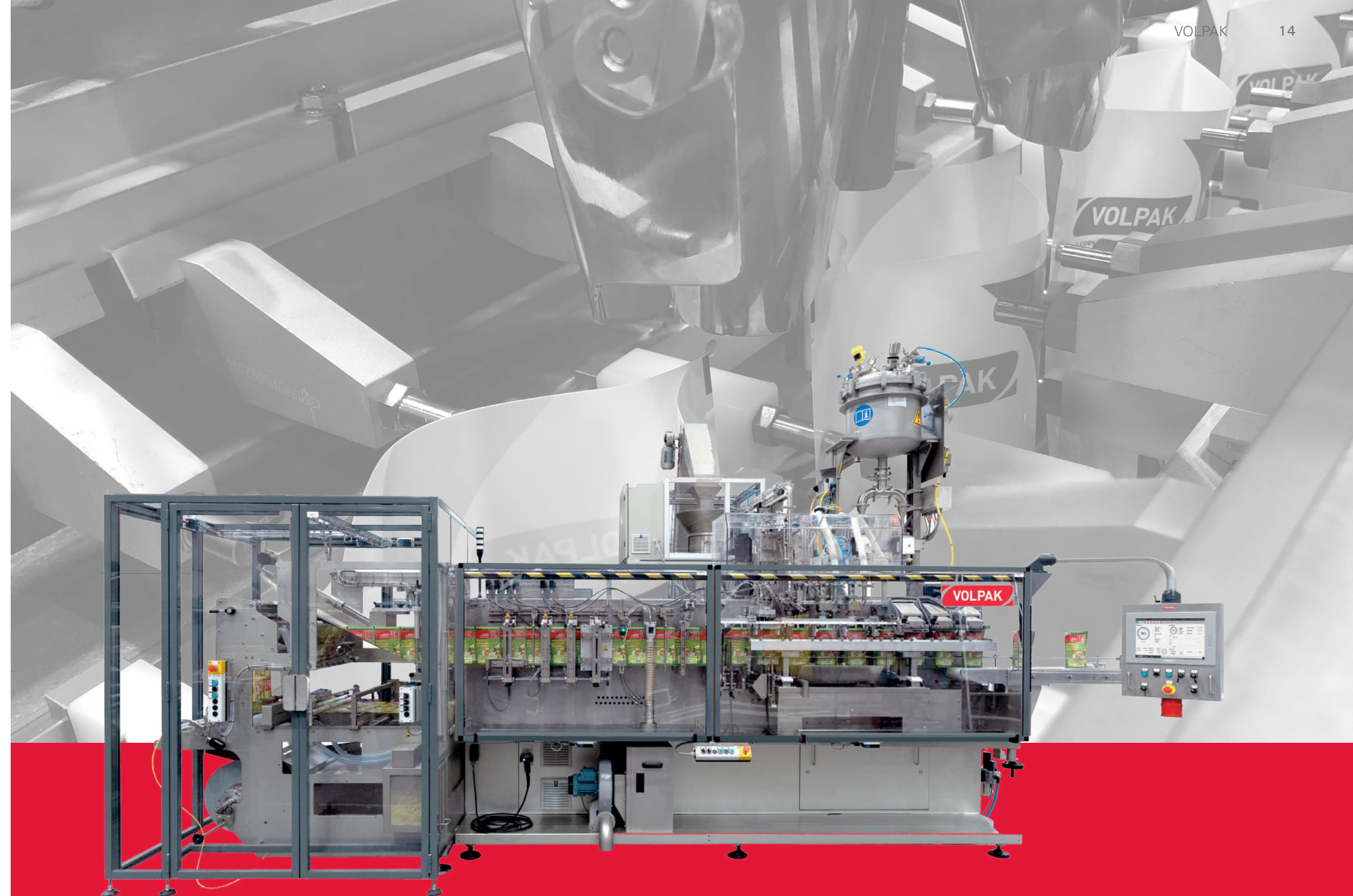

SP 170

02 Operating Cycle

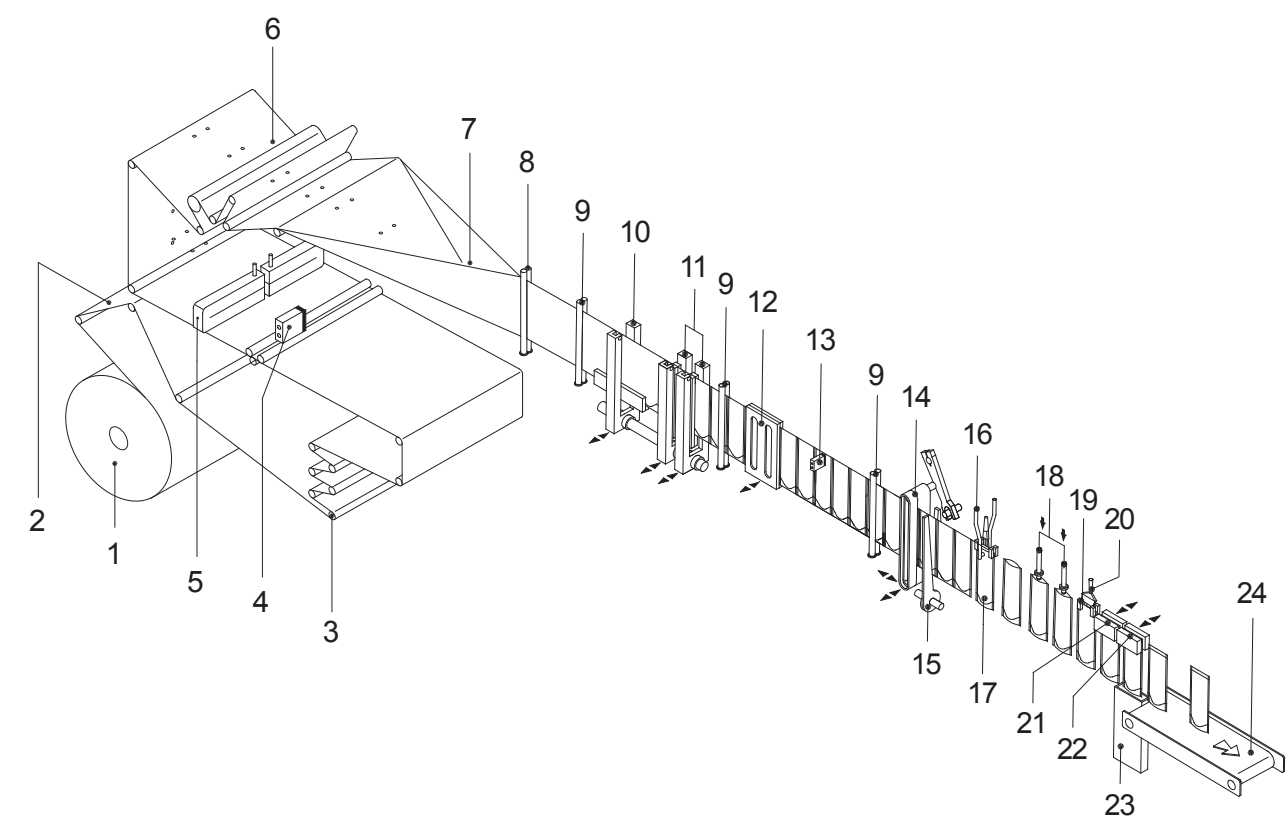

1. Film shaft

2. Film splicer

3. Unwinder arm

4. Photocell

5. Perforator

6. Reel aligner

7. Forming triangle

8. Film guide

9. Film guide
10. Bottom sealing

11. Vertical sealing

12. Cooling and flattening

13. Photocell

14. Film transport

15. Scissors

16. Top pouch opening

17. Bottom pouch opening

18. Dosing station
19. Static stretching

20. Foam suction

21. Top sealing

22. Top cooling seals

23. Rejected pouches

24. Outlet belt



03 Technical Specifications

		SIMPLEX	DUPLEX
Min pouch size, W x H	mm	70 x 70 / 70 x 90 x 30	50 x 70
Max pouch size, W x H	mm	170 x 270 (x100)	85 x 270
Max pouch volume	c.c	1000	150
Max output	ppm	100	200
Type of material		Heatsealable	
Max reel width	mm	640	
Max reel diameter	mm	600	
Core reel diameter	mm	74- 78 / 150- 154	
Electrical data		220,380,440V / 50, 60 Hz / 3Ph+G	

DIGITAL & SERVICES



COESIA DIGITAL:

The future has never been so human

Volpak focuses on the development of digital solutions that support people to do their job better and more easily, each and every day.

(optimize)

OptiMate is our proprietary smart HMI developed to facilitate the machine interaction and accelerate operations such as format change, troubleshooting, maintenance by enabling access to guided procedures and digital documentation directly on the machine.

(performate)

PerforMate is Coesia's IoT platform for real-time machine monitoring allowing manufact improve the control and performance of the entire machine pool, while acting as a single en to several innovative services.

(ultimate)

UltiMate is our advanced software platform for artificial intelligence and machine learning designed to enhance productivity, quality and maintenance, lowering waste and optimizing total cost of ownership.

(hypermate)

HyperMate is Coesia's end-to-end solution for Manufacturing Operations Management aimed at achieving complete digitalization of production processes. Thanks to its ability to adapt to customer processes, HyperMate improves operations by scaling automation to the factory level.



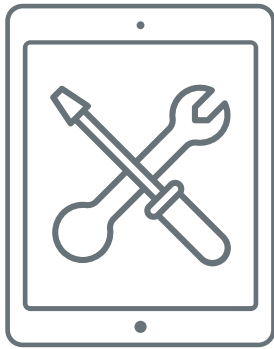

Remote Assistance



OEE Consulting



Service Agreements

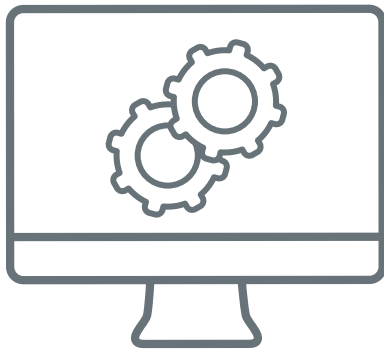

Webshop

CUSTOMERS FIRST: Volpak customer service

For us, Customer Service means ensuring proactive and continuous support- leveraging our global presence- in a fast, simple and flexible way manner, to guarantee the best possible Overall Equipment Effectiveness (OEE) and the lowest Total Cost of Ownership (TCO) for all Volpak and Enflex machines.

We offer a comprehensive portfolio of services for full equipment lifecycle management striving to keep up the pace with an evolving world.

Webshop

Webshop is our online platform to manage and monitor spare parts orders quickly and efficiently. Clear graphical interface, photographic catalog and the possibility to search and select components in different ways make Volpak’s webshop extremely intuitive and easy to use.

Machine Assessment

Machine Assessment is our service to identify and implement solutions that improve performances and contain costs. It is based on inspections performed by qualified Volpak technicians who evaluates the machine status and collects all the data to provide suggestions for tailored interventions:

- part replacement and machine upgrades
- technical assistance and maintenance
- tailored training

Training / E-training

Obtain the maximum performance of your machine by taking advantage of our Training Services to secure and develop your team competence and capability.

Remote Assistance

Thanks to advanced remote connectivity and collaboration tools, video and augmented reality, Volpak is able to provide remote technical support and diagnosis in real time.

Service Agreements

A suite of structured services that may be customized based on customer needs to optimize maintenance, ensure the best possible conditions of use and maximum productivity.

POUCH LAB:

Our approach to sustainability

At Volpak, not only do we design packaging machines ready-to-work with sustainable materials, but we also work close to our customers to find more environmentally friendly packaging materials.

In our PouchLab laboratory, our customers can test the behavior of the different materials in a real production environment.





85
PRODUCTION
PLANTS
in 139 OPERATING UNITS

36
COUNTRIES

8,000+
EMPLOYEES

20
COMPANIES
with HEADQUARTERS
in 8 COUNTRIES

Volpak S.A.U
Pol. Ind. Can Vinyalets
C/ Can Vinyalets 4
08130 Santa Perpètua de Mogoda
Barcelona, Spain

main@volpak.com
www.volpak.com

Volpak, part of Coesia Group, is one of the leading brands of horizontal form-fill-seal (HFFS) machines for flexible packaging in the consumer goods market. It designs and manufactures automatic packaging machines for different markets: food & beverage, dairy, personal care, home care, chemical, pharmaceutical, pet care, tea, and coffee.

